



**Q-LINE.
ONBEGRENSDE
MOGELIJKHEDEN.**



HEEL SNEL, HEEL MOOI.

Handrailingen

GESLEPEN

Q-LINE - Handrailingsteunen

Wand - buis

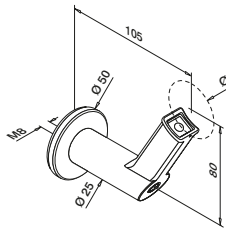

MOD 9320

304

INDOOR	Ø				
13.9320.042.12	42,4	QS-1	348 / QS-25	349	2
13.9320.048.12	48,3	QS-1	348 / QS-25	349	2

316

OUTDOOR	Ø				
14.9320.042.12	42,4	QS-2	348 / QS-71	349	2
14.9320.048.12	48,3	QS-2	348 / QS-71	349	2



Q-INFO

MOD 9320

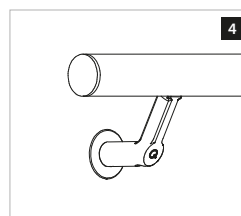
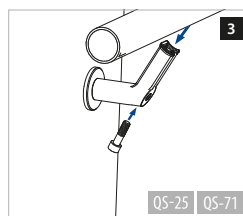
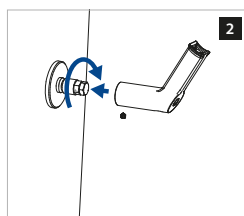
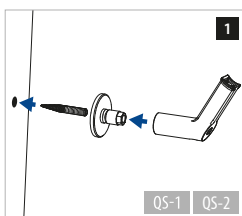

Wand - vlak

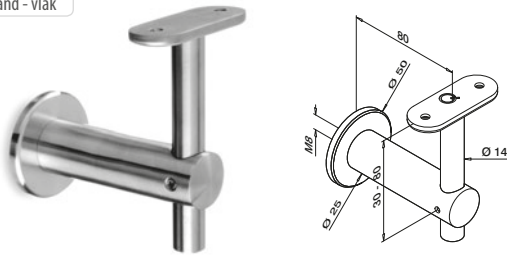

MOD 0140

304

INDOOR

13.0140.000.12	QS-1	348	QS-12	349	2
----------------	------	-----	-------	-----	---



Wand - buis

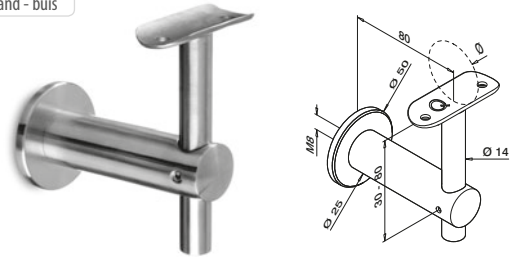

MOD 0140

304

INDOOR

13.0140.042.12	42,4	QS-1	348	QS-10	348	2
13.0140.048.12	48,3	QS-1	348	QS-10	348	2

316

OUTDOOR

14.0140.042.12	42,4	QS-2	348	QS-11	348	2
14.0140.048.12	48,3	QS-2	348	QS-11	348	2



Wand - vlak

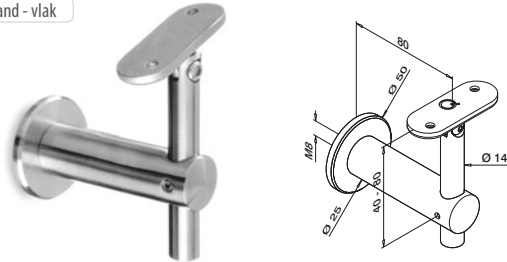

MOD 0145

304

INDOOR

13.0145.000.12	QS-1	348	QS-12	349	2
----------------	------	-----	-------	-----	---



Wand - buis

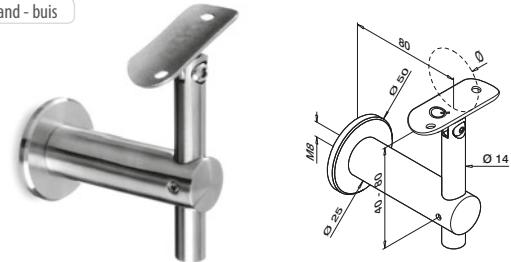

MOD 0145

304

INDOOR

13.0145.042.12	42,4	QS-1	348	QS-10	348	2
13.0145.048.12	48,3	QS-1	348	QS-10	348	2

316

OUTDOOR

14.0145.042.12	42,4	QS-2	348	QS-11	348	2
14.0145.048.12	48,3	QS-2	348	QS-11	348	2



Q-INFO

MOD 0140

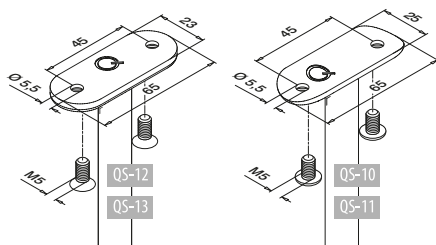

Q-INFO

MOD 0145

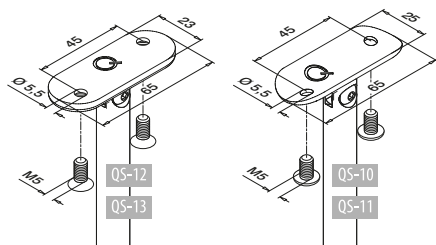

Wand - vlak

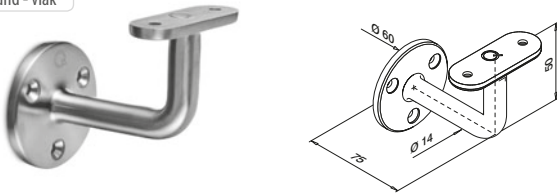

MOD 0100

304

INDOOR

Product Code	Accessories	Quantity
13.0100.000.12	QS-7 348 / QS-12 349	2

316

OUTDOOR

Product Code	Accessories	Quantity
14.0100.000.12	QS-6 348 / QS-13 349	2



Wand - buis

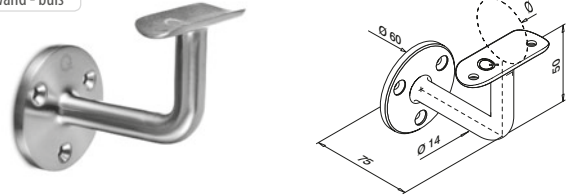

MOD 0100

304

INDOOR

Product Code	Ø	Accessories	Quantity
13.0100.042.12	42,4	QS-7 348 / QS-10 348	2
13.0100.048.12	48,3	QS-7 348 / QS-10 348	2

316

OUTDOOR

Product Code	Ø	Accessories	Quantity
14.0100.042.12	42,4	QS-6 348 / QS-11 348	2
14.0100.048.12	48,3	QS-6 348 / QS-11 348	2



Wand - vlak

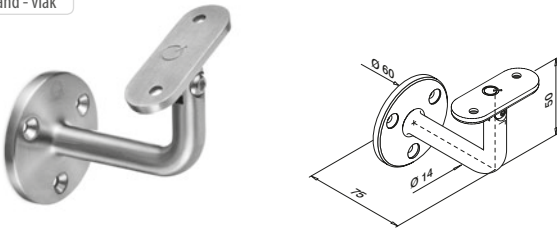

MOD 0102

304

INDOOR

Product Code	Accessories	Quantity
13.0102.000.12	QS-7 348 / QS-12 349	2

316

OUTDOOR

Product Code	Accessories	Quantity
14.0102.000.12	QS-6 348 / QS-13 349	2



Wand - buis

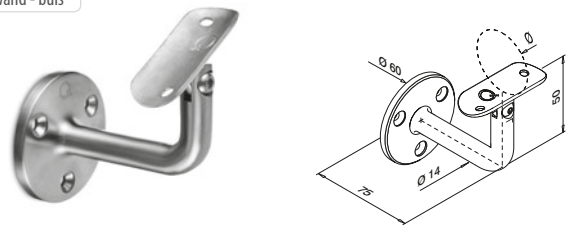

MOD 0102

304

INDOOR

Product Code	Ø	Accessories	Quantity
13.0102.042.12	42,4	QS-7 348 / QS-10 348	2
13.0102.048.12	48,3	QS-7 348 / QS-10 348	2

316

OUTDOOR

Product Code	Ø	Accessories	Quantity
14.0102.042.12	42,4	QS-6 348 / QS-11 348	2
14.0102.048.12	48,3	QS-6 348 / QS-11 348	2



Wand - vlak

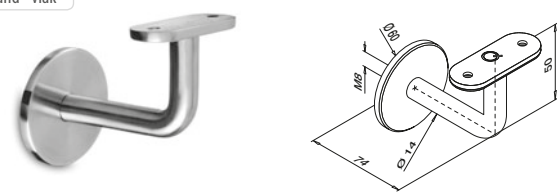

MOD 0111

304

INDOOR

Product Code	Accessories	Quantity
13.0111.000.12	QS-1 348 / QS-12 349	2

316

OUTDOOR

Product Code	Accessories	Quantity
14.0111.000.12	QS-2 348 / QS-13 349	2



Wand - buis

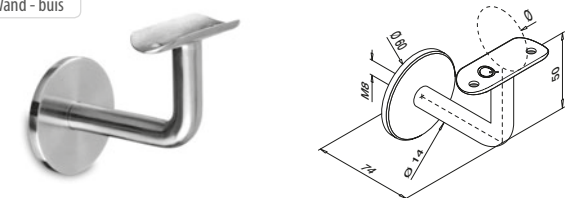

MOD 0111

304

INDOOR

Product Code	Ø	Accessories	Quantity
13.0111.033.12	33,7	QS-1 348 / QS-10 348	2
13.0111.042.12	42,4	QS-1 348 / QS-10 348	2
13.0111.048.12	48,3	QS-1 348 / QS-10 348	2

316

OUTDOOR

Product Code	Ø	Accessories	Quantity
14.0111.042.12	42,4	QS-2 348 / QS-11 348	2
14.0111.048.12	48,3	QS-2 348 / QS-11 348	2



Q-INFO

MOD 0102

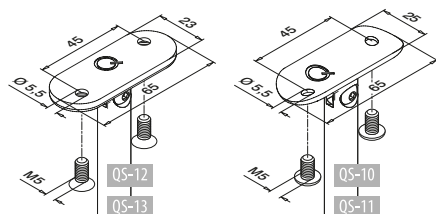

Wand - vlak

Muurafstand 85

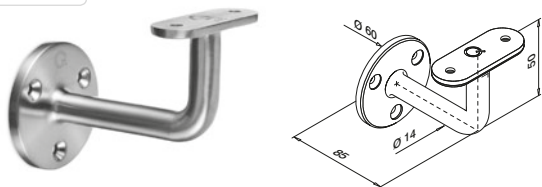

MOD 0101

304

INDOOR			
13.0101.000.12	Ø	QS-7 348 / QS-12 349	2

316

OUTDOOR			
14.0101.000.12	Ø	QS-6 348 / QS-13 349	2



Wand - buis

Muurafstand 85

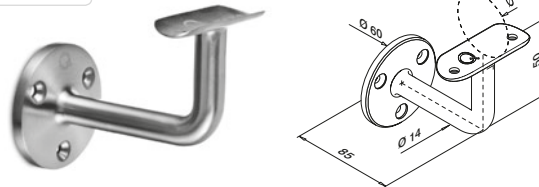

MOD 0101

304

INDOOR			
13.0101.042.12	Ø	QS-7 348 / QS-10 348	2
13.0101.048.12	Ø	QS-7 348 / QS-10 348	2

316

OUTDOOR			
14.0101.042.12	Ø	QS-6 348 / QS-11 348	2
14.0101.048.12	Ø	QS-6 348 / QS-11 348	2



Wand - buis

Muurafstand 85

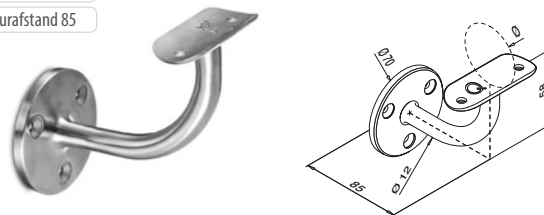

MOD 0115

304

INDOOR			
13.0115.042.12	Ø	QS-7 348 / QS-10 348	2



Wand - buis

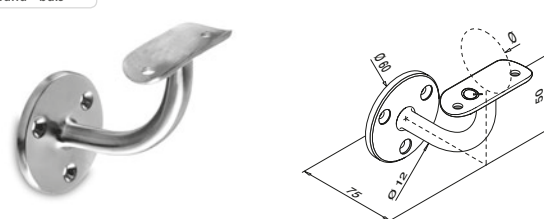

MOD 0112

304

INDOOR			
13.0112.033.12	Ø	QS-7 348 / QS-10 348	2
13.0112.042.12	Ø	QS-7 348 / QS-10 348	2
13.0112.048.12	Ø	QS-7 348 / QS-10 348	2

316

OUTDOOR			
14.0112.042.12	Ø	QS-6 348 / QS-11 348	2
14.0112.048.12	Ø	QS-6 348 / QS-11 348	2

Zamak RVS look

INDOOR			
10.0112.033.19	Ø	QS-7 348 / QS-10 348	2
10.0112.042.19	Ø	QS-7 348 / QS-10 348	2
10.0112.048.19	Ø	QS-7 348 / QS-10 348	2



Q-INFO



Q-23

Q-cleaner

300 ml

19.0601.000.00

Q-INFO



Q-22

Q-ultra-clean

500 ml

19.0610.000.00

Q-INFO

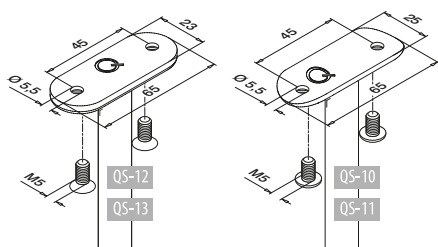

Muurafstand 85

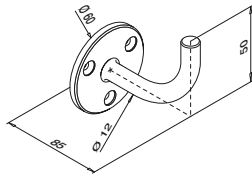

MOD 0109

304		
INDOOR		
13.0109.000.12	QS-7 348	2
316		
OUTDOOR		
14.0109.000.12	QS-6 348	2

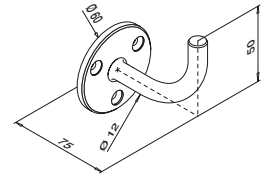

MOD 0113

304		
INDOOR		
13.0113.000.12	QS-7 348	2
316		
OUTDOOR		
14.0113.000.12	QS-6 348	2

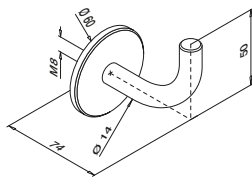

MOD 0114

304		
INDOOR		
13.0114.000.12	QS-1 348	2
316		
OUTDOOR		
14.0114.000.12	QS-2 348	2

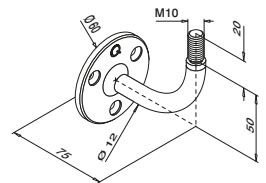

MOD 0118

304		
INDOOR		
13.0118.000.12	QS-7 348	2

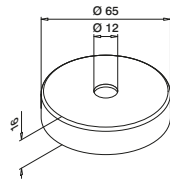

MOD 0519

Zamak	RVS look	
INDOOR		
10.0519.065.19		2

Q-INFO MOD 0118



Q-INFO MOD 0519

Passend op model 0109, 0118 en 0113



Wand - vlak

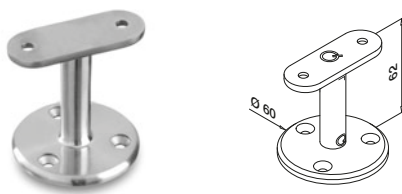

MOD 0708

304

INDOOR

13.0708.000.12	QS-5 348 / QS-12 349	2

Wand - buis

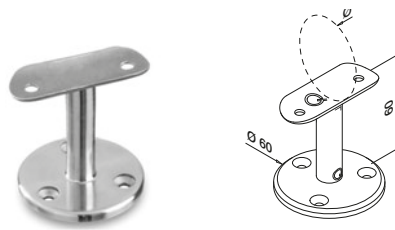

MOD 0708

304

INDOOR

	Ø		
13.0708.042.12	42,4	QS-5 348 / QS-10 348	2
13.0708.048.12	48,3	QS-5 348 / QS-10 348	2

316

OUTDOOR

	Ø		
14.0708.042.12	42,4	QS-6 348 / QS-11 348	2
14.0708.048.12	48,3	QS-6 348 / QS-11 348	2



Q-INFO

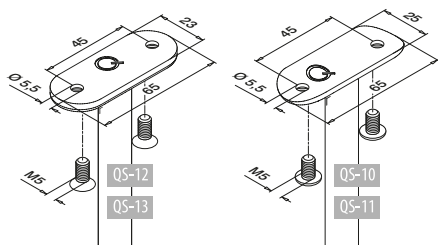

Q-INFO



Q-23
Q-cleaner
300 ml
19.0601.000.00

Q-INFO



Q-22
Q-ultra-clean
500 ml
19.0610.000.00



WAAR ZIJN DE SCHROEVEN?

Handrailingen

GESLEPEN

Q-LINE - Handrailingsteunen

Buis - buis

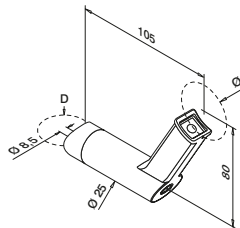

MOD 9330 - D = Ø 42,4 mm

304

INDOOR	D	Ø		
13.9330.042.12	42,4	42,4	QS-21 349 / QS-25 349	2

MOD 9331 - D = Ø 48,3 mm

304

INDOOR	D	Ø		
13.9331.042.12	48,3	42,4	QS-21 349 / QS-25 349	2
13.9331.048.12	48,3	48,3	QS-21 349 / QS-25 349	2

NEW



Q-INFO

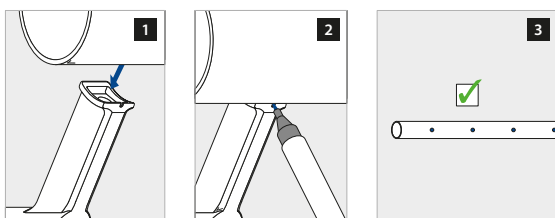

Q-INFO



Q-23
Q-cleaner
300 ml
19.0601.000.00

Q-LINE - Handrailingsteunen (verstelbaar)

Buis - buis

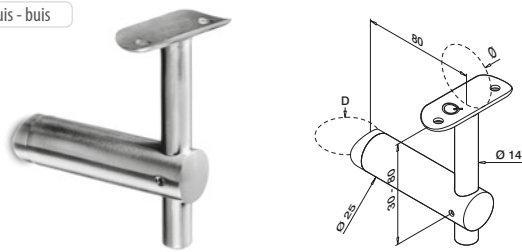

MOD 0130 - D = Ø 42,4 mm

304					
INDOOR	D	Ø			
13.0130.042.12	Ø 42,4	42,4	QS-21	349 / QS-10	348 2

316					
OUTDOOR	D	Ø			
14.0130.042.12	Ø 42,4	42,4	QS-22	349 / QS-11	348 2

MOD 0131 - D = Ø 48,3 mm

304					
INDOOR	D	Ø			
13.0131.048.12	Ø 48,3	48,3	QS-21	349 / QS-10	348 2



Buis - buis

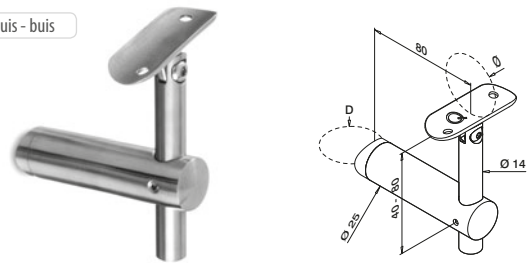

MOD 0135 - D = Ø 42,4 mm

304					
INDOOR	D	Ø			
13.0135.042.12	Ø 42,4	42,4	QS-21	349 / QS-10	348 2
13.0135.048.12	Ø 42,4	48,3	QS-21	349 / QS-10	348 2

316					
OUTDOOR	D	Ø			
14.0135.042.12	Ø 42,4	42,4	QS-22	349 / QS-11	348 2

MOD 0136 - D = Ø 48,3 mm

304					
INDOOR	D	Ø			
13.0136.048.12	Ø 48,3	48,3	QS-21	349 / QS-10	348 2

316					
OUTDOOR	D	Ø			
14.0136.048.12	Ø 48,3	48,3	QS-22	349 / QS-11	348 2



Q-INFO

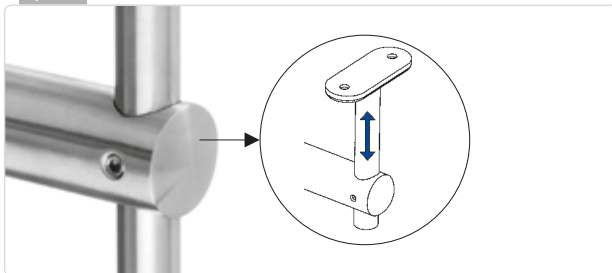

Q-INFO

MOD 0130

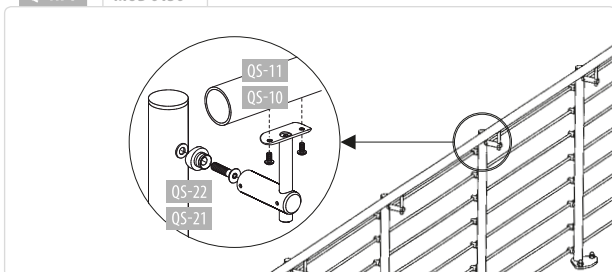

Q-INFO

MOD 0130 / 0131

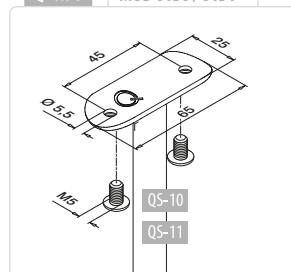

Q-INFO

MOD 0135 / 0136

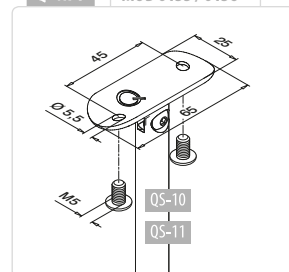

Vlak - vlak

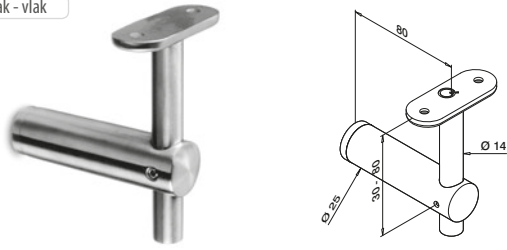

MOD 0128

304

INDOOR

13.0128.000.12	QS-21	349 / QS-12	349	2
----------------	-------	-------------	-----	---



Vlak - vlak

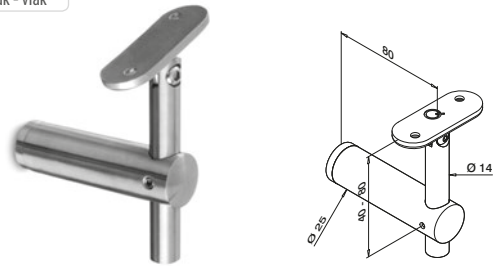

MOD 0133

304

INDOOR

13.0133.000.12	QS-21	349 / QS-12	349	2
----------------	-------	-------------	-----	---

Vlak - buis

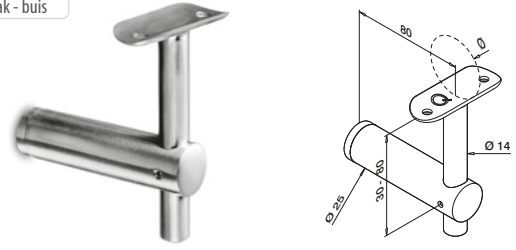

MOD 0128

304

INDOOR

13.0128.042.12	42,4	QS-21	349 / QS-10	348	2
----------------	------	-------	-------------	-----	---

316

OUTDOOR

14.0128.042.12	42,4	QS-22	349 / QS-11	348	2
14.0128.048.12	48,3	QS-22	349 / QS-11	348	2



Vlak - buis

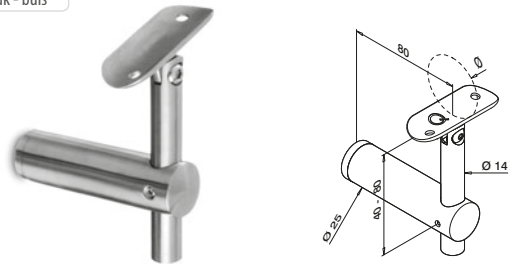

MOD 0133

304

INDOOR

13.0133.042.12	42,4	QS-21	349 / QS-10	348	2
13.0133.048.12	48,3	QS-21	349 / QS-10	348	2

316

OUTDOOR

14.0133.042.12	42,4	QS-22	349 / QS-11	348	2
----------------	------	-------	-------------	-----	---



Q-INFO

MOD 0133

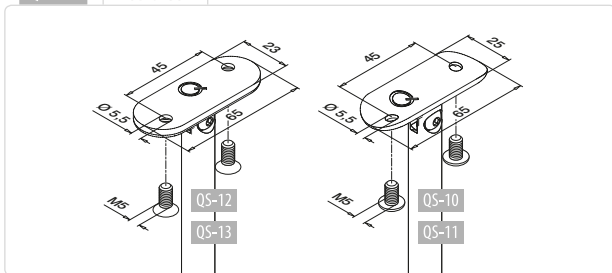

Q-INFO

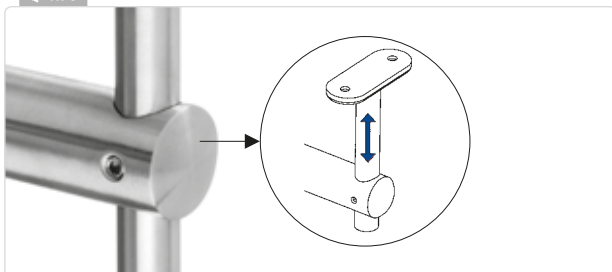

Q-INFO

MOD 0128

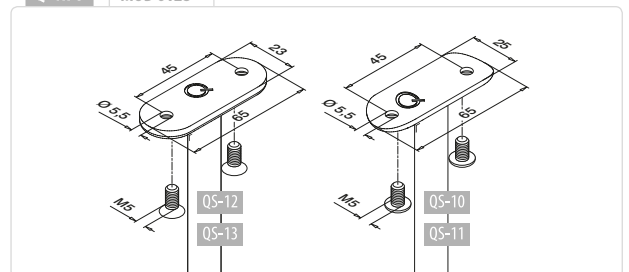

Glas - vlak

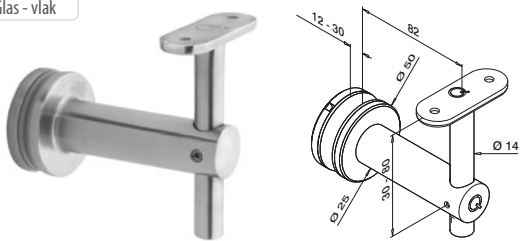

MOD 0150

304

INDOOR

13.0150.000.12	QS-12	349	2
----------------	-------	-----	---



Glas - vlak

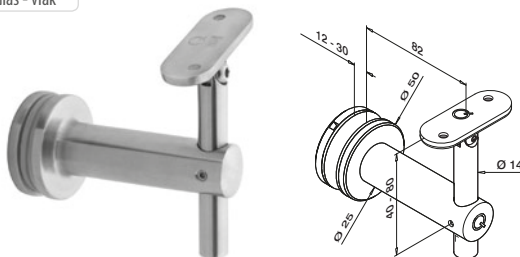

MOD 0155

304

INDOOR

13.0155.000.12	QS-12	349	2
----------------	-------	-----	---

316

OUTDOOR

14.0155.000.12	QS-13	349	2
----------------	-------	-----	---



Glas - buis

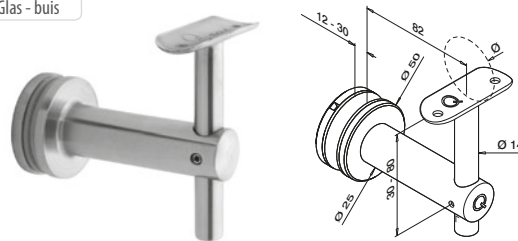

MOD 0150

304

INDOOR

13.0150.042.12	Ø	42,4	QS-10	348	2
----------------	---	------	-------	-----	---

13.0150.048.12	Ø	48,3	QS-10	348	2
----------------	---	------	-------	-----	---

316

OUTDOOR

14.0150.042.12	Ø	42,4	QS-11	348	2
----------------	---	------	-------	-----	---

14.0150.048.12	Ø	48,3	QS-11	348	2
----------------	---	------	-------	-----	---



Glas - buis

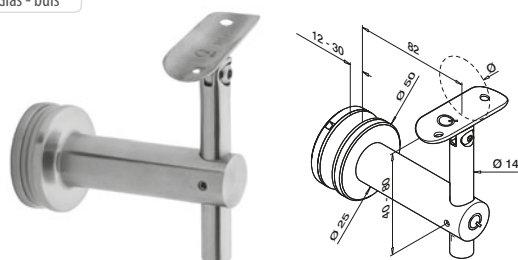

MOD 0155

304

INDOOR

13.0155.042.12	Ø	42,4	QS-10	348	2
----------------	---	------	-------	-----	---

13.0155.048.12	Ø	48,3	QS-10	348	2
----------------	---	------	-------	-----	---

316

OUTDOOR

14.0155.042.12	Ø	42,4	QS-11	348	2
----------------	---	------	-------	-----	---

14.0155.048.12	Ø	48,3	QS-11	348	2
----------------	---	------	-------	-----	---



Q-INFO

MOD 0155

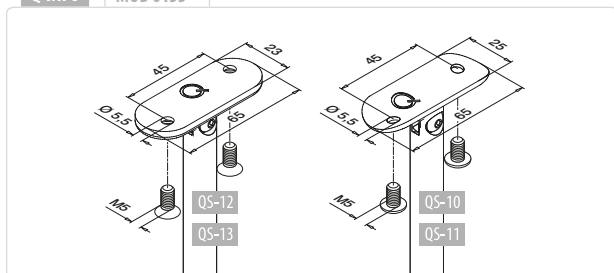

Q-INFO

MOD 0150

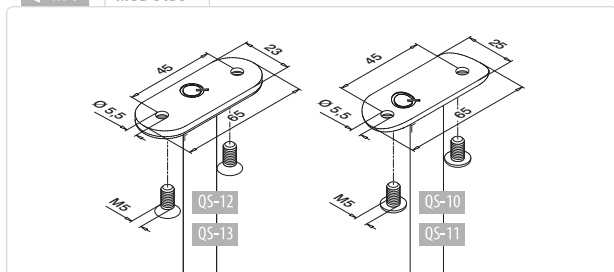

Q-INFO

MOD 0155

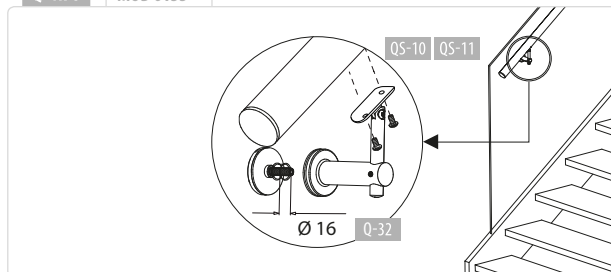

Glas - vlak

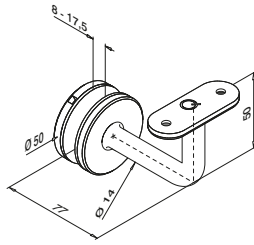

MOD 0117

304

INDOOR

13.0117.000.12	Ø	QS-12	349	2
----------------	---	-------	-----	---

316

OUTDOOR

14.0117.000.12	Ø	QS-13	349	2
----------------	---	-------	-----	---



Glas - buis

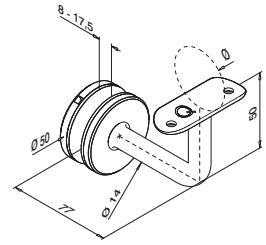

MOD 0117

304

INDOOR

13.0117.033.12	Ø	33,7	QS-10	348	2
13.0117.042.12	Ø	42,4	QS-10	348	2
13.0117.048.12	Ø	48,3	QS-10	348	2

316

OUTDOOR

14.0117.042.12	Ø	42,4	QS-11	348	2
14.0117.048.12	Ø	48,3	QS-11	348	2



Glas - buis

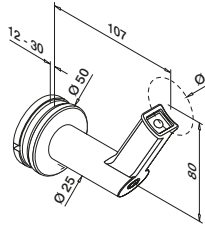

MOD 9350

304

INDOOR

13.9350.042.12	Ø	42,4	QS-25	349	2
13.9350.048.12	Ø	48,3	QS-25	349	2

316

OUTDOOR

14.9350.042.12	Ø	42,4	QS-71	349	2
14.9350.048.12	Ø	48,3	QS-71	349	2



Q-INFO

MOD 9350

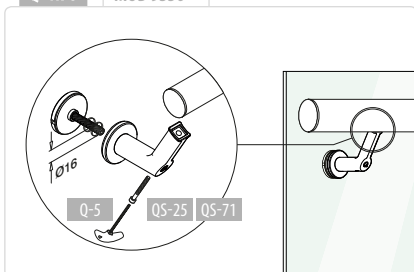

Q-INFO

MOD 0117 - Montage A

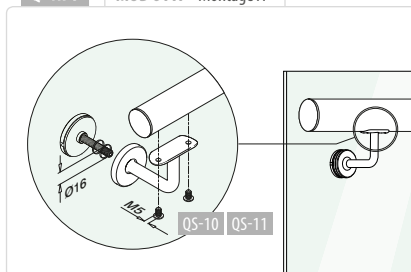

Q-INFO

MOD 0117 - Montage B

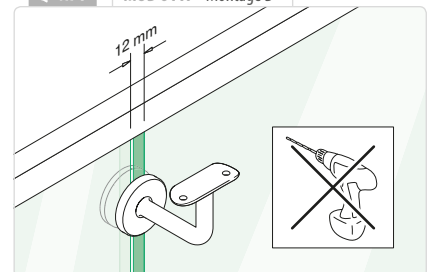

Buis - buis

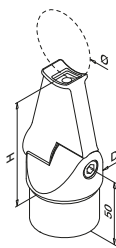

+55°
-55°

**MOD 0715** - D = Ø 42,4 mm

304

INDOOR	D	Ø	H		
13.0715.242.12	Ø 42,4 x 2,0	42,4	79	QS-54	349

316

OUTDOOR	D	Ø	H		
14.0715.242.12	Ø 42,4 x 2,0	42,4	79	QS-70	349



EXTRA STRONG

MOD 0716 - D = Ø 48,3 mm

304

INDOOR	D	Ø	H			
13.0716.248.12	Ø 48,3 x 2,0	48,3	80	QS-54	349	Tested



TESTED P.131

EXTRA STRONG

Extra Strong balusters: zie pagina 216.

Q-INFO

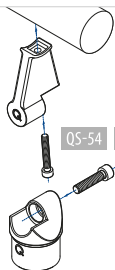

QS-54 QS-70

Q-INFO



Q-23
Q-cleaner
300 ml
19.0601.000.00

Q-INFO



Q-22
Q-ultra-clean
500 ml
19.0610.000.00



PUUR DESIGN.

Buis - buis

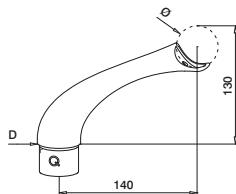

MOD 0706 - D = Ø 42,4 mm

304

INDOOR	D	Ø		
13.0706.242.12	Ø 42,4 x 2,0	42,4	QS-83	348

MOD 0707 - D = Ø 48,3 mm

304

INDOOR	D	Ø		
13.0707.248.12	Ø 48,3 x 2,0	48,3	QS-83	348



International Design Model Protection

Q-INFO



Q-23

Q-cleaner

300 ml

19.0601.000.00

Q-INFO

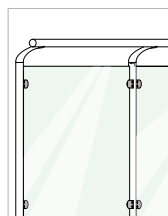
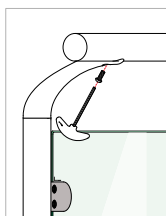
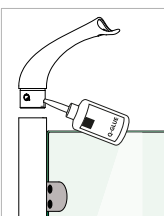

Q-INFO



Buis - buis

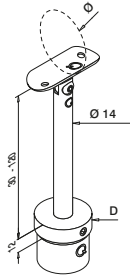

MOD 0697 - D = Ø 42,4 mm

304				
INDOOR	D	Ø		
13.0697.242.12	Ø 42,4 x 2,0	42,4	QS-10	348 2

316				
OUTDOOR	D	Ø		
14.0697.242.12	Ø 42,4 x 2,0	42,4	QS-11	348 2

MOD 0699 - D = Ø 48,3

304				
INDOOR	D	Ø		
13.0699.248.12	Ø 48,3 x 2,0	48,3	QS-10	348 2

316				
OUTDOOR	D	Ø		
14.0699.248.12	Ø 48,3 x 2,0	48,3	QS-11	348 2



Buis - buis

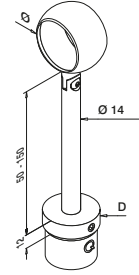

MOD 0714 - D = Ø 48,3 / D = Ø 42,4 mm

304				
INDOOR	D	Ø		
13.0714.042.12	Ø 42,4 x 2,6	42,4		2
13.0714.048.12	Ø 48,3 x 2,6	48,3		2

Q-INFO MOD 0697 / 0699

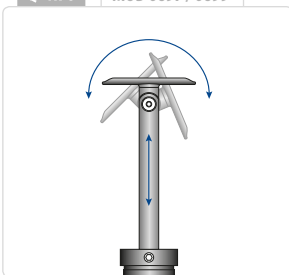

Q-INFO MOD 0714

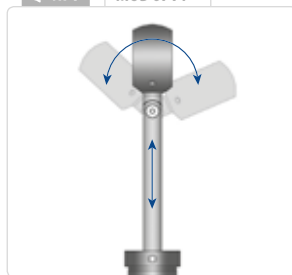

Q-INFO



Q-INFO





Kwaliteit



Steeds meer mensen kiezen voor Q-railing. Vanwege de hoge kwaliteit van onze producten en onze innovatieve oplossingen. Elk Q-railing product wordt dan ook door toonaangevende Duitse onderzoeksinstituten uitvoerig getest om er zeker van te zijn dat we u altijd de beste kwaliteit leveren.

Dankzij steekproeven op het gebied van materiaal en toleranties zijn wij in staat om de hoogste kwaliteitsstandaard in ons productieproces te handhaven. Door voortdurend de aandacht op een vlekkeloze productie te richten, bent u verzekerd van een probleemloos installatieproces met onderdelen die stuk voor stuk perfect passen.

Met deze zorgvuldige benadering onderscheiden we ons in de markt. Neem bijvoorbeeld onze dwarsstafhouders waarvan de montagenaden nagenoeg onzichtbaar zijn, dankzij onze niet-aflatende aandacht voor details tijdens het productieproces.

U kunt voor een perfecte afwerking volledig op ons vertrouwen. Want bij ons geldt het beste materiaal in de hoogste kwaliteit als standaard. Blader gerust door onze brochures en ontdek welke unieke resultaten u met Q-railing systemen kunt bereiken. U kunt ook contact opnemen met uw lokale Q-railing partner.

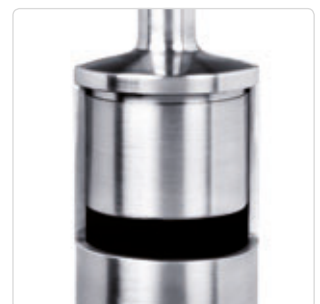

Buis - vlak

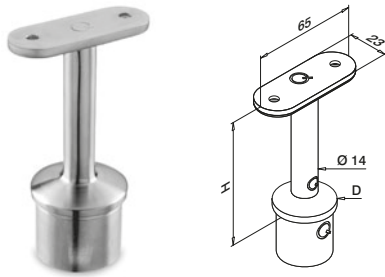

MOD 0709 - D = Ø 33,7 mm

304				
INDOOR	D	H		
13.0709.200.12	Ø 33,7 x 2,0	80	QS-12	349 2

MOD 0710 - D = Ø 42,4 mm

304				
INDOOR	D	H		
13.0710.200.12	Ø 42,4 x 2,0	81	QS-12	349 2
13.0710.000.12	Ø 42,4 x 2,6	81	QS-12	349 2

316				
OUTDOOR	D	H		
14.0710.200.12	Ø 42,4 x 2,0	81	QS-13	349 2
14.0710.000.12	Ø 42,4 x 2,6	81	QS-13	349 2

MOD 0711 - D = Ø 48,3 mm

304				
INDOOR	D	H		
13.0711.200.12	Ø 48,3 x 2,0	82	QS-12	349 2
13.0711.000.12	Ø 48,3 x 2,6	82	QS-12	349 2

316				
OUTDOOR	D	H		
14.0711.200.12	Ø 48,3 x 2,0	82	QS-13	349 2
14.0711.000.12	Ø 48,3 x 2,6	82	QS-13	349 2



Buis - buis

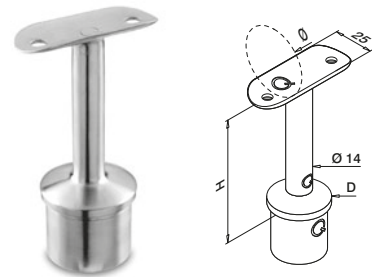

MOD 0709 - D = Ø 33,7 mm

304					
INDOOR	D	Ø	H		
13.0709.233.12	Ø 33,7 x 2,0	33,7	78	QS-10	348 2
13.0709.242.12	Ø 33,7 x 2,0	42,4	78	QS-10	348 2

MOD 0710 - D = Ø 42,4 mm

304					
INDOOR	D	Ø	H		
13.0710.242.12	Ø 42,4 x 2,0	42,4	79	QS-10	348 2
13.0710.248.12	Ø 42,4 x 2,0	48,3	79	QS-10	348 2
13.0710.042.12	Ø 42,4 x 2,6	42,4	79	QS-10	348 2
13.0710.048.12	Ø 42,4 x 2,6	48,3	79	QS-10	348 2

316					
OUTDOOR	D	Ø	H		
14.0710.242.12	Ø 42,4 x 2,0	42,4	79	QS-11	348 2
14.0710.248.12	Ø 42,4 x 2,0	48,3	79	QS-11	348 2
14.0710.042.12	Ø 42,4 x 2,6	42,4	79	QS-11	348 2
14.0710.048.12	Ø 42,4 x 2,6	48,3	79	QS-11	348 2

MOD 0711 - D = Ø 48,3 mm

304					
INDOOR	D	Ø	H		
13.0711.248.12	Ø 48,3 x 2,0	48,3	80	QS-10	348 2 Tested
13.0711.042.12	Ø 48,3 x 2,6	42,4	80	QS-10	348 2
13.0711.048.12	Ø 48,3 x 2,6	48,3	80	QS-10	348 2

316					
OUTDOOR	D	Ø	H		
14.0711.248.12	Ø 48,3 x 2,0	48,3	80	QS-11	348 2
14.0711.042.12	Ø 48,3 x 2,6	42,4	80	QS-11	348 2
14.0711.048.12	Ø 48,3 x 2,6	48,3	80	QS-11	348 2



Q-INFO

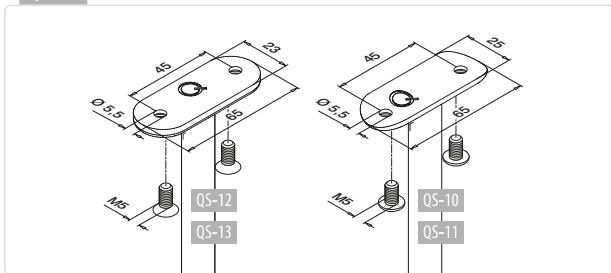

Q-INFO



Q-21
Q-glue
50 ml
19.1331.000.00



Q-glue space



Buis - buis

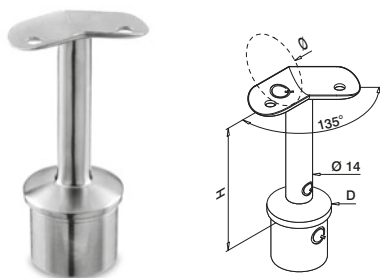

MOD 0709 - D = Ø 33,7 mm

304						
INDOOR	D	Ø	H			
13.0709.333.12	Ø 33,7 x 2,0	33,7	78	QS-10	348	2
13.0709.342.12	Ø 33,7 x 2,0	42,4	78	QS-10	348	2

MOD 0710 - D = Ø 42,4 mm

304						
INDOOR	D	Ø	H			
13.0710.342.12	Ø 42,4 x 2,0	42,4	79	QS-10	348	2
13.0710.348.12	Ø 42,4 x 2,0	48,3	79	QS-10	348	2
13.0710.442.12	Ø 42,4 x 2,6	42,4	79	QS-10	348	2
13.0710.448.12	Ø 42,4 x 2,6	48,3	79	QS-10	348	2

316						
OUTDOOR	D	Ø	H			
14.0710.342.12	Ø 42,4 x 2,0	42,4	79	QS-11	348	2
14.0710.348.12	Ø 42,4 x 2,0	48,3	79	QS-11	348	2
14.0710.442.12	Ø 42,4 x 2,6	42,4	79	QS-11	348	2
14.0710.448.12	Ø 42,4 x 2,6	48,3	79	QS-11	348	2

MOD 0711 - D = Ø 48,3 mm

304						
INDOOR	D	Ø	H			
13.0711.348.12	Ø 48,3 x 2,0	48,3	80	QS-10	348	2
13.0711.442.12	Ø 48,3 x 2,6	42,4	80	QS-10	348	2
13.0711.448.12	Ø 48,3 x 2,6	48,3	80	QS-10	348	2

316						
OUTDOOR	D	Ø	H			
14.0711.348.12	Ø 48,3 x 2,0	48,3	80	QS-11	348	2
14.0711.442.12	Ø 48,3 x 2,6	42,4	80	QS-11	348	2
14.0711.448.12	Ø 48,3 x 2,6	48,3	80	QS-11	348	2



Buis - buis

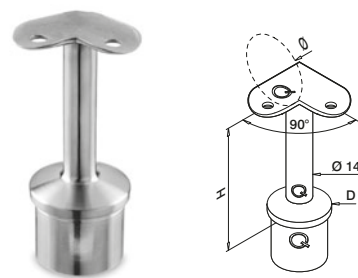

MOD 0709 - D = Ø 33,7 mm

304						
INDOOR	D	Ø	H			
13.0709.833.12	Ø 33,7 x 2,0	33,7	78	QS-10	348	2
13.0709.842.12	Ø 33,7 x 2,0	42,4	78	QS-10	348	2

MOD 0710 - D = Ø 42,4 mm

304						
INDOOR	D	Ø	H			
13.0710.842.12	Ø 42,4 x 2,0	42,4	79	QS-10	348	2
13.0710.848.12	Ø 42,4 x 2,0	48,3	79	QS-10	348	2
13.0710.942.12	Ø 42,4 x 2,6	42,4	79	QS-10	348	2
13.0710.948.12	Ø 42,4 x 2,6	48,3	79	QS-10	348	2

316						
OUTDOOR	D	Ø	H			
14.0710.842.12	Ø 42,4 x 2,0	42,4	79	QS-11	348	2
14.0710.848.12	Ø 42,4 x 2,0	48,3	79	QS-11	348	2
14.0710.942.12	Ø 42,4 x 2,6	42,4	79	QS-11	348	2
14.0710.948.12	Ø 42,4 x 2,6	48,3	79	QS-11	348	2

MOD 0711 - D = Ø 48,3 mm

304						
INDOOR	D	H	Ø			
13.0711.848.12	Ø 48,3 x 2,0	80	48,3	QS-10	348	2
13.0711.942.12	Ø 48,3 x 2,6	80	42,4	QS-10	348	2
13.0711.948.12	Ø 48,3 x 2,6	80	48,3	QS-10	348	2

316						
OUTDOOR	D	H	Ø			
14.0711.848.12	Ø 48,3 x 2,0	80	48,3	QS-11	348	2
14.0711.942.12	Ø 48,3 x 2,6	80	42,4	QS-11	348	2
14.0711.948.12	Ø 48,3 x 2,6	80	48,3	QS-11	348	2

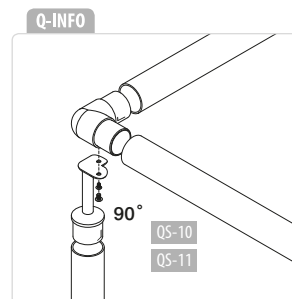
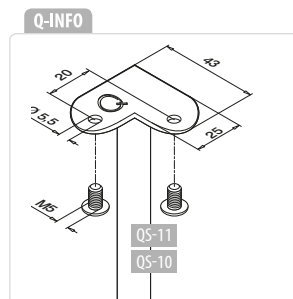
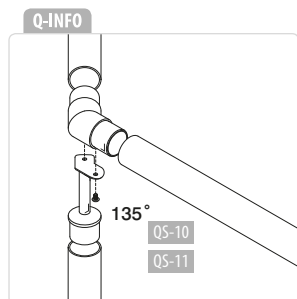
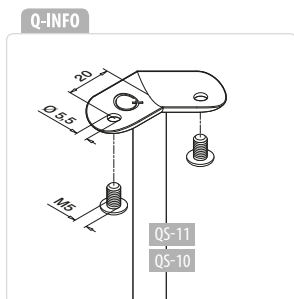

Buis - vlak

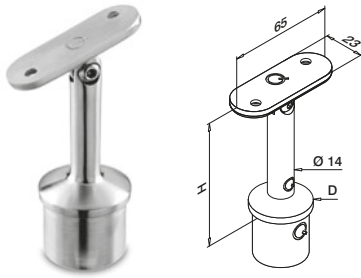
**MOD 0717** - D = Ø 33,7 mm

304

INDOOR	D	H		
13.0717.200.12	Ø 33,7 x 2,0	80	QS-12	349 2

MOD 0718 - D = Ø 42,4 mm

304

INDOOR	D	H		
13.0718.200.12	Ø 42,4 x 2,0	81	QS-12	349 2
13.0718.000.12	Ø 42,4 x 2,6	81	QS-12	349 2

316

OUTDOOR	D	H		
14.0718.200.12	Ø 42,4 x 2,0	81	QS-13	349 2
14.0718.000.12	Ø 42,4 x 2,6	81	QS-13	349 2

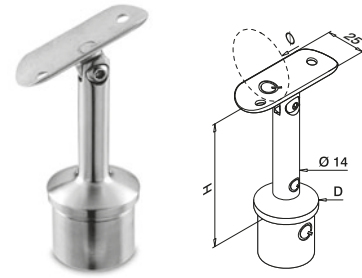

Buis - buis

**MOD 0717** - D = Ø 33,7 mm

304

INDOOR	D	Ø	H		
13.0717.233.12	Ø 33,7 x 2,0	33,7	78	QS-10	348 2
13.0717.242.12	Ø 33,7 x 2,0	42,4	78	QS-10	348 2

MOD 0718 - D = Ø 42,4 mm

304

INDOOR	D	Ø	H		
13.0718.242.12	Ø 42,4 x 2,0	42,4	79	QS-10	348 2
13.0718.248.12	Ø 42,4 x 2,0	48,3	79	QS-10	348 2
13.0718.042.12	Ø 42,4 x 2,6	42,4	79	QS-10	348 2
13.0718.048.12	Ø 42,4 x 2,6	48,3	79	QS-10	348 2

316

OUTDOOR	D	Ø	H		
14.0718.242.12	Ø 42,4 x 2,0	42,4	79	QS-11	348 2
14.0718.248.12	Ø 42,4 x 2,0	48,3	79	QS-11	348 2
14.0718.042.12	Ø 42,4 x 2,6	42,4	79	QS-11	348 2
14.0718.048.12	Ø 42,4 x 2,6	48,3	79	QS-11	348 2

MOD 0719 - D = Ø 48,3 mm

304

INDOOR	D	Ø	H		
13.0719.248.12	Ø 48,3 x 2,0	48,3	80	QS-10	348 2
13.0719.042.12	Ø 48,3 x 2,6	42,4	80	QS-10	348 2
13.0719.048.12	Ø 48,3 x 2,6	48,3	80	QS-10	348 2

316

OUTDOOR	D	Ø	H		
14.0719.248.12	Ø 48,3 x 2,0	48,3	80	QS-11	348 2
14.0719.042.12	Ø 48,3 x 2,6	42,4	80	QS-11	348 2
14.0719.048.12	Ø 48,3 x 2,6	48,3	80	QS-11	348 2



Q-INFO

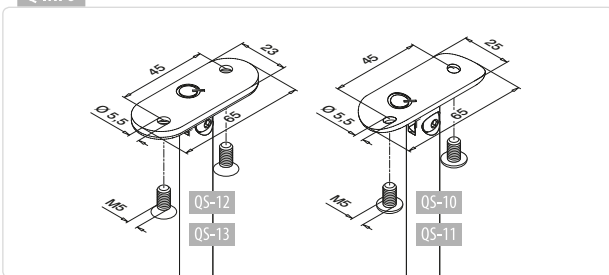

Q-INFO



Q-21
Q-glue
50 ml
19.1331.000.00



Q-glue space



Q-INFO



Q-22
Q-ultra-clean
500 ml
19.0610.000.00

Buis - buis

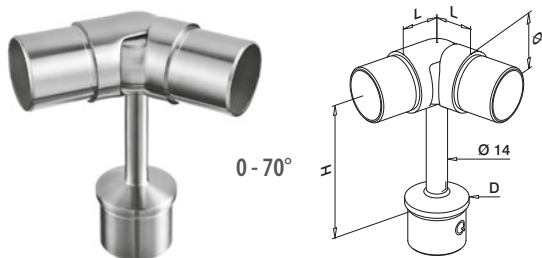
**MOD 0736** - D = Ø 42,4 mm

304					
INDOOR	D	L	H		
13.0736.242.12	Ø 42,4 x 2,0	27	100	QS-54	349 2
316					
OUTDOOR	D	L	H		
14.0736.242.12	Ø 42,4 x 2,0	27	100	QS-70	349 2

MOD 0737 - D = Ø 48,3 mm

304					
INDOOR	D	L	H		
13.0737.248.12	Ø 48,3 x 2,0	30	100	QS-54	349 2
316					
OUTDOOR	D	L	H		
14.0737.248.12	Ø 48,3 x 2,0	30	100	QS-70	349 2

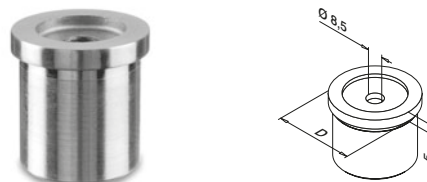

Buis - vlak

**MOD 0728** - D = Ø 33,7 mm

304					
INDOOR	D				
13.0728.200.12	Ø 33,7 x 2,0	QS-26	349	2	

MOD 0727 - D = Ø 42,4 mm

304					
INDOOR	D				
13.0727.200.12	Ø 42,4 x 2,0	QS-26	349	2	
13.0727.000.12	Ø 42,4 x 2,6	QS-26	349	2	
316					
OUTDOOR	D				
14.0727.200.12	Ø 42,4 x 2,0	QS-27	349	2	
14.0727.000.12	Ø 42,4 x 2,6	QS-27	349	2	

MOD 0726 - D = Ø 48,3 mm

304					
INDOOR	D				
13.0726.200.12	Ø 48,3 x 2,0	QS-26	349	2	
13.0726.000.12	Ø 48,3 x 2,6	QS-26	349	2	
316					
OUTDOOR	D				
14.0726.200.12	Ø 48,3 x 2,0	QS-27	349	2	

MOD 0725 - D = Ø 60,3 mm

304					
INDOOR	D				
13.0725.000.12	Ø 60,3 x 2,0	QS-26	349	2	



Buis - buis

Hoogte 5

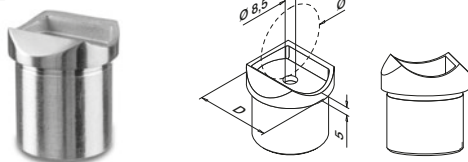
**MOD 0728** - D = Ø 33,7 mm**304**

INDOOR	D	Ø			
13.0728.242.12	Ø 33,7 x 2,0	42,4	QS-26	349	2
13.0728.248.12	Ø 33,7 x 2,0	48,3	QS-26	349	2

MOD 0727 - D = Ø 42,4 mm**304**

INDOOR	D	Ø			
13.0727.248.12	Ø 42,4 x 2,0	48,3	QS-26	349	2
13.0727.048.12	Ø 42,4 x 2,6	48,3	QS-26	349	2

316

OUTDOOR	D	Ø			
14.0727.248.12	Ø 42,4 x 2,0	48,3	QS-27	349	2

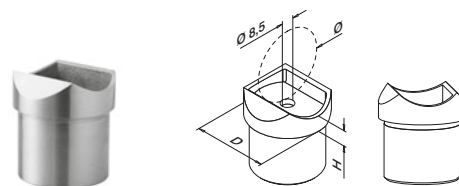

Buis - buis

**MOD 0773** - D = Ø 33,7 mm**304**

INDOOR	D	Ø	H		
13.0773.233.12	Ø 33,7 x 2,0	33,7	8	QS-26	349

Buis - buis

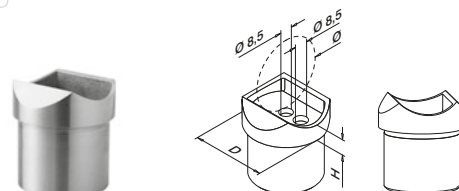
**MOD 0772** - D = Ø 42,4 mm**304**

INDOOR	D	Ø	H		
13.0772.242.12	Ø 42,4 x 2,0	42,4	9	QS-26	349
13.0772.042.12	Ø 42,4 x 2,6	42,4	9	QS-26	349

316

OUTDOOR	D	Ø	H		
14.0772.242.12	Ø 42,4 x 2,0	42,4	9	QS-27	349
14.0772.042.12	Ø 42,4 x 2,6	42,4	9	QS-27	349

MOD 0771 - D = Ø 48,3 mm**304**

INDOOR	D	Ø	H		
13.0771.248.12	Ø 48,3 x 2,0	48,3	11	QS-26	349
13.0771.048.12	Ø 48,3 x 2,6	48,3	11	QS-26	349

316

OUTDOOR	D	Ø	H		
14.0771.248.12	Ø 48,3 x 2,0	48,3	11	QS-27	349
14.0771.048.12	Ø 48,3 x 2,6	48,3	11	QS-27	349



Q-INFO

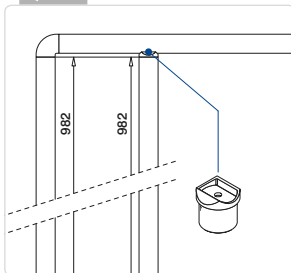

Q-INFO



Q-21
Q-glue
50 ml
19.1331.000.00

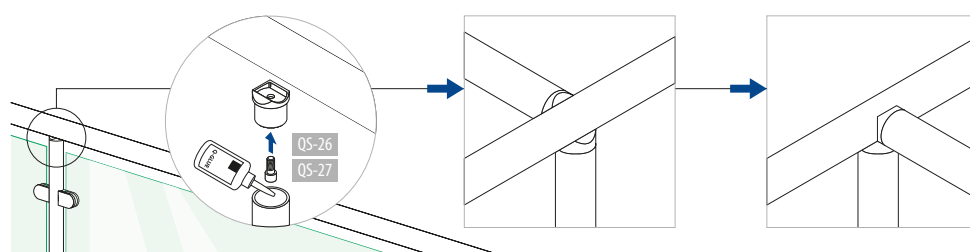

Buis - vlak

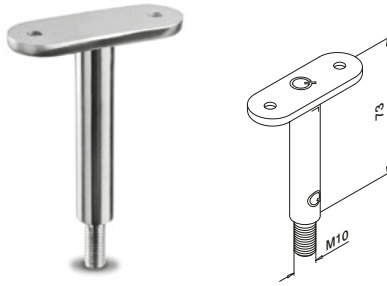

MOD 0810

304			
INDOOR			
13.0810.000.12	QS-12	349	2
316			
OUTDOOR			
14.0810.000.12	QS-13	349	2



Buis - buis

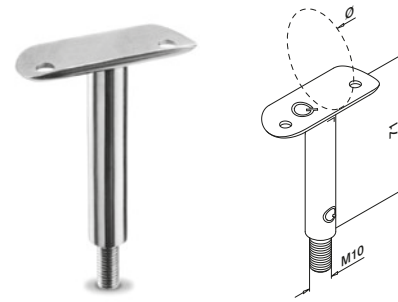

MOD 0810

304				
INDOOR				
13.0810.033.12	∅	QS-10	348	2
13.0810.042.12	33,7	QS-10	348	2
13.0810.048.12	42,4	QS-10	348	2
13.0810.048.12	48,3	QS-10	348	2
316				
OUTDOOR				
14.0810.042.12	∅	QS-11	348	2
14.0810.042.12	42,4	QS-11	348	2
14.0810.048.12	48,3	QS-11	348	2



Buis - buis

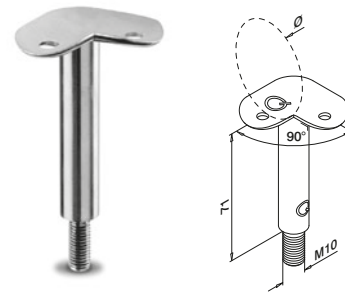

MOD 0810

304				
INDOOR				
13.0810.942.12	∅	QS-10	348	2
13.0810.948.12	42,4	QS-10	348	2
13.0810.948.12	48,3	QS-10	348	2
316				
OUTDOOR				
14.0810.942.12	∅	QS-11	348	2
14.0810.942.12	42,4	QS-11	348	2
14.0810.948.12	48,3	QS-11	348	2



Q-INFO

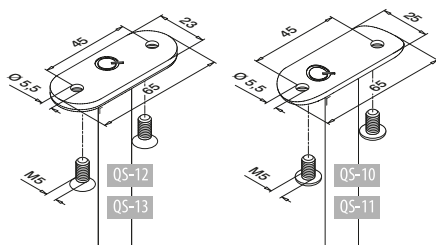

Q-INFO

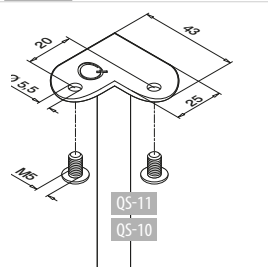

Q-INFO



Q-23
Q-cleaner
300 ml
19.0601.000.00

Buis - vlak

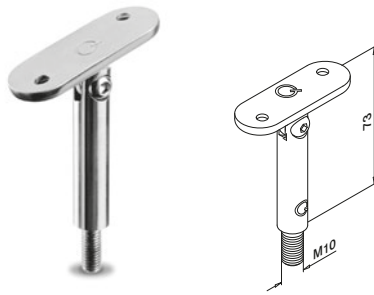

MOD 0818

304

INDOOR

Product Code	Accessories	Quantity
13.0818.000.12	QS-12 349	2



Buis - buis

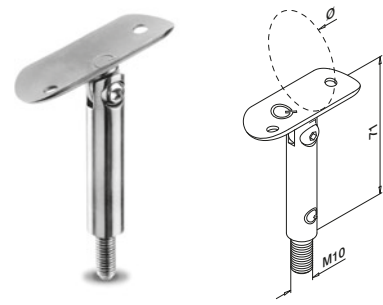

MOD 0818

304

INDOOR

Product Code	Ø	Accessories	Quantity
13.0818.033.12	33,7	QS-10 348	2
13.0818.042.12	42,4	QS-10 348	2
13.0818.048.12	48,3	QS-10 348	2

316

OUTDOOR

Product Code	Ø	Accessories	Quantity
14.0818.042.12	42,4	QS-11 348	2
14.0818.048.12	48,3	QS-11 348	2



Q-INFO

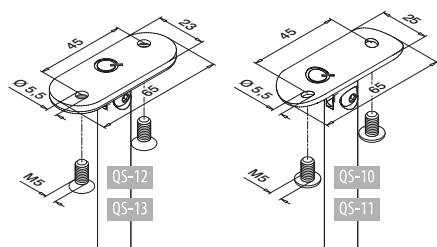

Q-INFO



Q-23
Q-cleaner
300 ml
19.0601.000.00

Q-INFO



Q-22
Q-ultra-clean
500 ml
19.0610.000.00

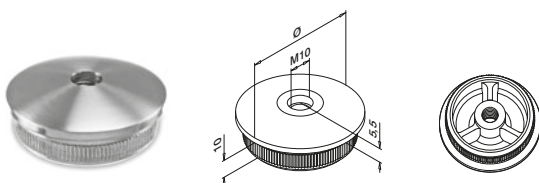

MOD 5735

304		
INDOOR	Ø	
13.5735.242.12	42,4 x 2,0	2
13.5735.042.12	42,4 x 2,6	2
13.5735.248.12	48,3 x 2,0	2
13.5735.048.12	48,3 x 2,6	2
316		
OUTDOOR	Ø	
14.5735.242.12	42,4 x 2,0	2
14.5735.042.12	42,4 x 2,6	2
14.5735.248.12	48,3 x 2,0	2
14.5735.048.12	48,3 x 2,6	2
14.5735.060.12	60,3 x 2,0	2



MOD 0811

304		
INDOOR		
13.0811.068.12	QS-48 349	2
316		
OUTDOOR		
14.0811.068.12	QS-89 349	2

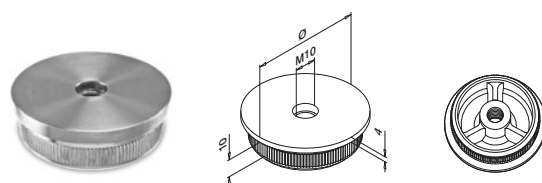

MOD 5736

304		
INDOOR	Ø	
13.5736.242.12	42,4 x 2,0	2
13.5736.042.12	42,4 x 2,6	2
13.5736.248.12	48,3 x 2,0	2
13.5736.048.12	48,3 x 2,6	2
316		
OUTDOOR	Ø	
14.5736.242.12	42,4 x 2,0	2
14.5736.248.12	48,3 x 2,0	2



MOD 0812

304		
INDOOR		
13.0812.068.12	QS-48 349	2
316		
OUTDOOR		
14.0812.068.12	QS-89 349	2



Bijbehorende producten 1800, 1801 en 1802 vindt u op pagina's 214 en 296.

Q-INFO

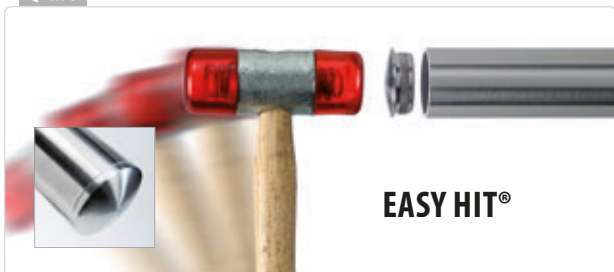

Q-INFO

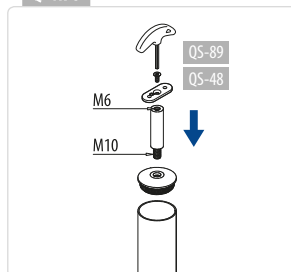

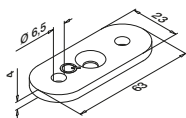
**MOD 1800****304****INDOOR**

13.1800.000.12	QS-48	349	QS-12	349	8
----------------	-------	-----	-------	-----	---

316**OUTDOOR**

14.1800.000.12	QS-89	349	QS-13	349	8
----------------	-------	-----	-------	-----	---

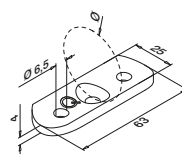
**MOD 1800****304****INDOOR**

13.1800.033.12	33,7	QS-48	349	QS-10	348	8
----------------	------	-------	-----	-------	-----	---

13.1800.042.12	42,4	QS-48	349	QS-10	348	8
----------------	------	-------	-----	-------	-----	---

13.1800.048.12	48,3	QS-48	349	QS-10	348	8
----------------	------	-------	-----	-------	-----	---

316**OUTDOOR**

14.1800.042.12	42,4	QS-89	349	QS-11	348	8
----------------	------	-------	-----	-------	-----	---

14.1800.048.12	48,3	QS-89	349	QS-11	348	8
----------------	------	-------	-----	-------	-----	---

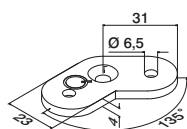
**MOD 1801****304****INDOOR**

13.1801.000.12	QS-48	349	QS-12	349	8
----------------	-------	-----	-------	-----	---

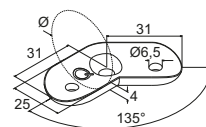
**MOD 1801****304****INDOOR**

13.1801.042.12	42,4	QS-48	349	QS-10	348	8
----------------	------	-------	-----	-------	-----	---

13.1801.048.12	48,3	QS-48	349	QS-10	348	8
----------------	------	-------	-----	-------	-----	---

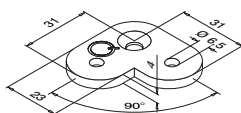
**MOD 1802****304****INDOOR**

13.1802.000.12	QS-48	349	QS-12	349	8
----------------	-------	-----	-------	-----	---

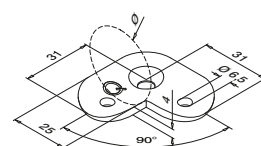
**MOD 1802****304****INDOOR**

13.1802.042.12	42,4	QS-48	349	QS-10	348	8
----------------	------	-------	-----	-------	-----	---

13.1802.048.12	48,3	QS-48	349	QS-10	348	8
----------------	------	-------	-----	-------	-----	---



Bijbehorende producten 4811, 4812, 0811 en 0812 vindt u op pagina's 160 en 213.

Q-INFO

Alle producten op deze pagina worden met geslepen oppervlakten en bewerkte zijden en kanten geleverd.

Q-INFO**Q-23**

Q-cleaner

300 ml

19.0601.000.00

Q-INFO**Q-22**

Q-ultra-clean

500 ml

19.0610.000.00



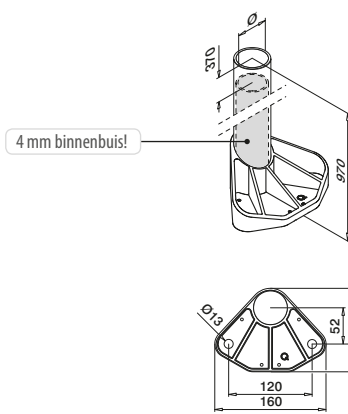

**EXTRA STRONG
VAN Q-RAILING.
ALS HET ÉCHT
VEILIG MOET ZIJN.**

**MOD 0561****304****INDOOR**13.0561.248.12 48,3 x 2,0   05-33 352 1

CALCULATED + TESTED Q-INFO

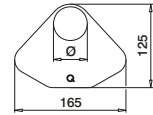
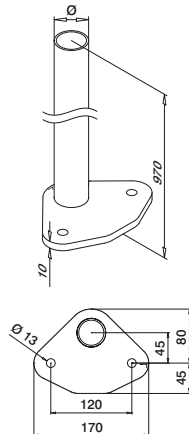
EXTRA STRONG

**MOD 0518****304****INDOOR**13.0518.048.12 \emptyset  2**MOD 0542****304****INDOOR**13.0542.042.12 42,4 x 2,6   05-33 352 1**316****OUTDOOR**14.0542.042.12 42,4 x 2,6   05-32 352 1

Extra Strong handrailingsteunen: zie pagina 201.

Heeft u speciale wensen als het gaat om voorbereekte producten? Gebruik dan ons bestelformulier op pagina 366 - 403.

Q-INFO

MOD 0561

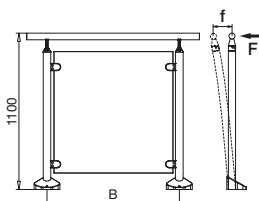

Getest

	F	B (max)	f
	0,50 kN/m	1500 mm	≤ 25 mm
	0,74 kN/m	1500 mm	≤ 25 mm
	1,00 kN/m	1100 mm	≤ 25 mm
	1,50 kN/m	1100 mm	≤ 25 mm



British Standard BS 6399

BS 6399-1: 1996 (incorp. amendm. No. 1)

Q-INFO

MOD 0542

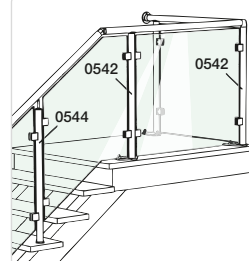

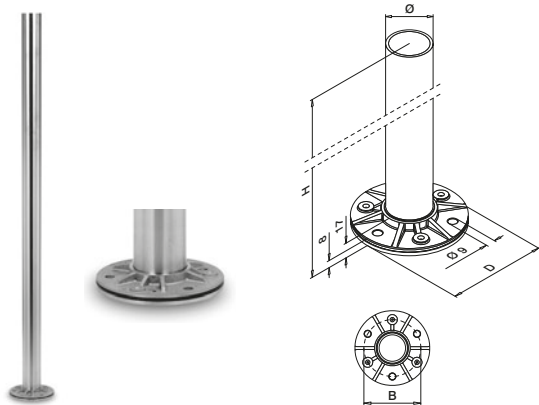
**MOD 0912****304**

INDOOR	Ø	B	D	H		
13.0912.242.12	42,4 x 2,0	80	Ø 105	989	QS-35	354 1

316

OUTDOOR	Ø	B	D	H		
14.0912.242.12	42,4 x 2,0	80	Ø 105	989	QS-34	354 1
14.0912.042.12	42,4 x 2,6	80	Ø 105	989	QS-34	354 1

MOD 0913**304**

INDOOR	Ø	B	D	H		
13.0913.242.12	42,4 x 2,0	80	Ø 105	970	QS-35	354 1
13.0913.248.12	48,3 x 2,0	90	Ø 115	970	QS-35	354 1
13.0913.042.12	42,4 x 2,6	80	Ø 105	970	QS-35	354 1
13.0913.048.12	48,3 x 2,6	90	Ø 115	970	QS-35	354 1

316

OUTDOOR	Ø	B	D	H		
14.0913.042.12	42,4 x 2,6	80	Ø 105	970	QS-34	354 1
14.0913.048.12	48,3 x 2,6	90	Ø 115	970	QS-34	354 1

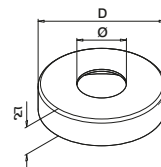
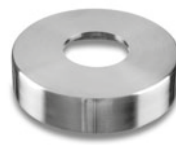

Heeft u speciale wensen als het gaat om voorbewerkte producten? Gebruik dan ons bestelformulier op pagina 366 - 403.

**MOD 0511****304**

INDOOR	Ø	D	
13.0511.042.12	42,4	Ø 110	2
13.0511.048.12	48,3	Ø 120	2

316

OUTDOOR	Ø	D	
14.0511.042.12	42,4	Ø 110	2
14.0511.048.12	48,3	Ø 120	2

Q-INFO

Rubberen ring

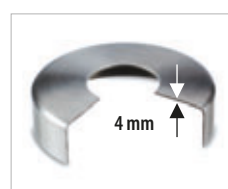
**Q-INFO****MOD 0511**

Voor model 0912, 0913 en 3502

Q-INFO**Q-22**

Q-ultra-clean
500 ml
19.0610.000.00

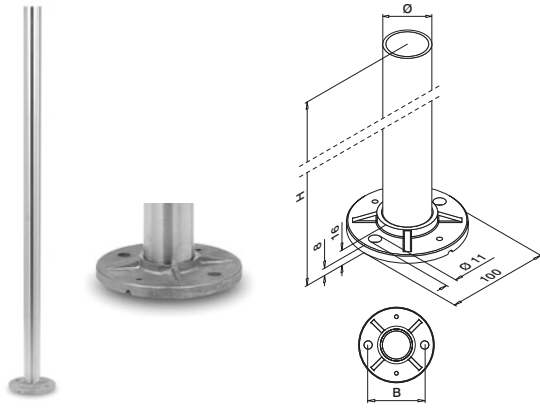
**MOD 0914****304**

INDOOR	Ø	H	B		
13.0914.242.12	42,4 x 2,0	970	75	QS-59	354 1
13.0914.248.12	48,3 x 2,0	970	80	QS-59	354 1 Tested
13.0914.042.12	42,4 x 2,6	970	75	QS-59	354 1
13.0914.048.12	48,3 x 2,6	970	80	QS-59	354 1

316

OUTDOOR	Ø	H	B		
14.0914.242.12	42,4 x 2,0	970	75	QS-58	354 1
14.0914.248.12	48,3 x 2,0	970	80	QS-58	354 1 Tested
14.0914.042.12	42,4 x 2,6	970	75	QS-58	354 1
14.0914.048.12	48,3 x 2,6	970	80	QS-58	354 1

MOD 0944**304**

INDOOR	Ø	H	B		
13.0944.242.12	42,4 x 2,0	1150	75	QS-59	354 1
13.0944.248.12	48,3 x 2,0	1150	80	QS-59	354 1

316

OUTDOOR	Ø	H	B		
14.0944.242.12	42,4 x 2,0	1150	75	QS-58	354 1
14.0944.248.12	48,3 x 2,0	1150	80	QS-58	354 1

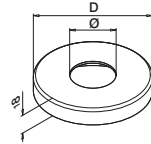
TESTED
P.131**MOD 0512****304**

INDOOR	Ø	D	
13.0512.042.12	42,4	Ø 105	2
13.0512.048.12	48,3	Ø 105	2

316

OUTDOOR	Ø	D	
14.0512.042.12	42,4	Ø 105	2
14.0512.048.12	48,3	Ø 105	2

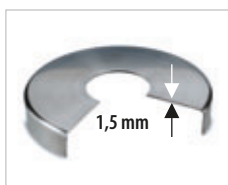
Q-INFO**MOD 0512**

1,5 mm

Voor model 0914 / 0944 / 0942 /
0940 / 0941**Q-INFO****Q-23**

Q-cleaner

300 ml

19.0601.000.00

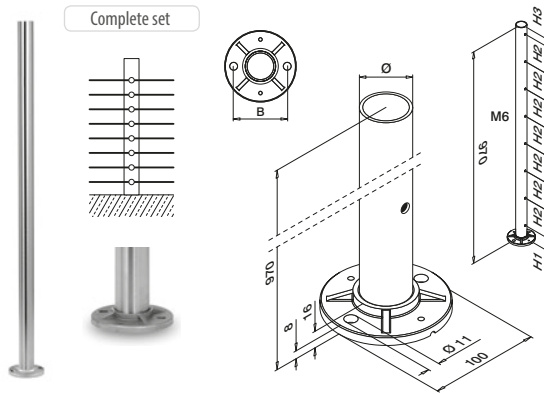

MOD 0930

304

INDOOR	Ø	B	H1	H2	H3		
13.0930.242.12	42,4 x 2,0	75	60	125	35	QS-59	354 1
13.0930.248.12	48,3 x 2,0	80	60	125	35	QS-59	354 1

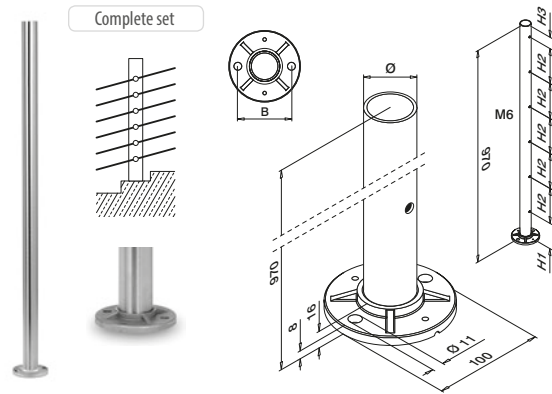

MOD 0931

304

INDOOR	Ø	B	H1	H2	H3		
13.0931.242.12	42,4 x 2,0	75	125	160	45	QS-59	354 1
13.0931.248.12	48,3 x 2,0	80	125	160	45	QS-59	354 1

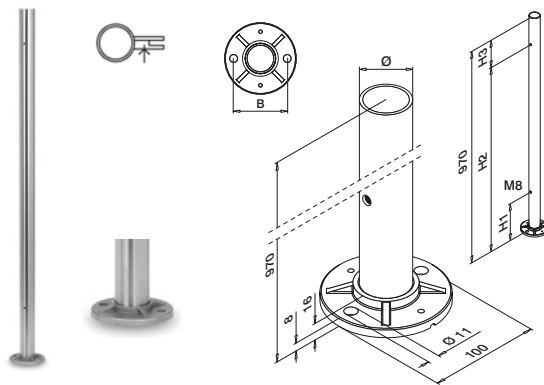

MOD 0932

304

INDOOR	Ø	B	H1	H2		
13.0932.242.12	42,4 x 2,0	75	175	850	QS-59	354 1
13.0932.248.12	48,3 x 2,0	80	175	850	QS-59	354 1

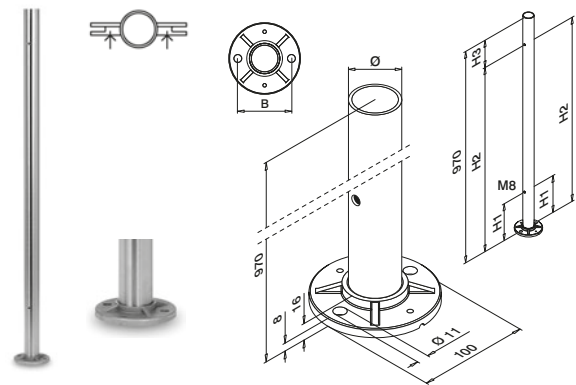

MOD 0933

304

INDOOR	Ø	B	H1	H2		
13.0933.242.12	42,4 x 2,0	75	175	850	QS-59	354 1
13.0933.248.12	48,3 x 2,0	80	175	850	QS-59	354 1

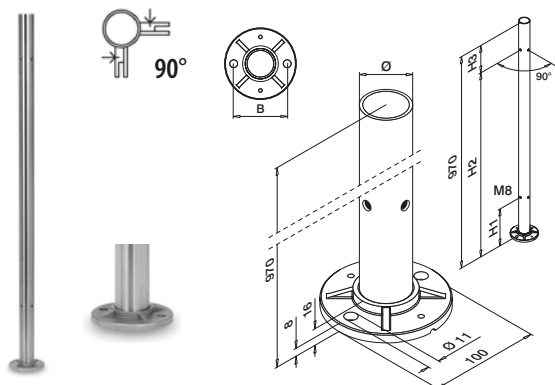

MOD 0934

304

INDOOR	Ø	B	H1	H2		
13.0934.242.12	42,4 x 2,0	75	175	850	QS-59	354 1
13.0934.248.12	48,3 x 2,0	80	175	850	QS-59	354 1



MOD 0512

304

INDOOR	Ø	D	
13.0512.042.12	42,4	Ø 105	2
13.0512.048.12	48,3	Ø 105	2

Q-INFO

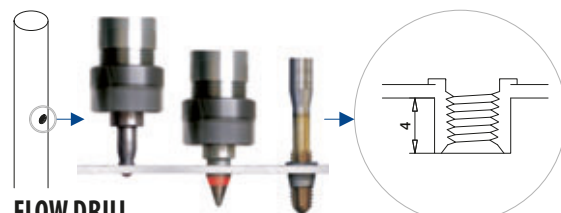

FLOW DRILL

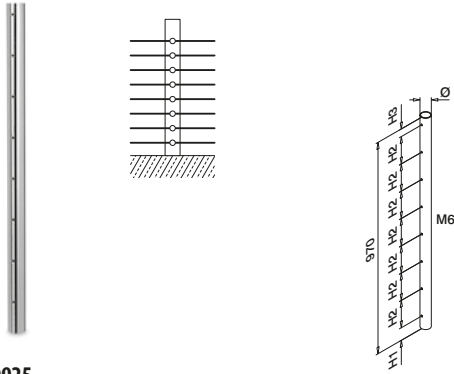
**MOD 0925****304**

INDOOR	Ø	H1	H2	H3	
13.0925.242.12	42,4 x 2,0	57	125	35	1

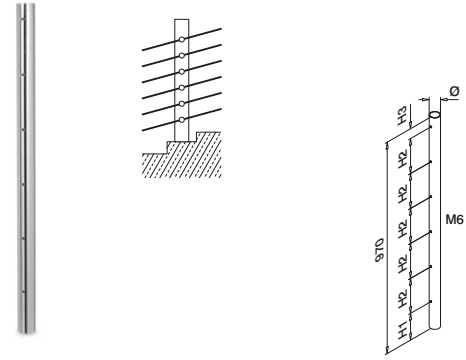
**MOD 0926****304**

INDOOR	Ø	H1	H2	H3	
13.0926.242.12	42,4 x 2,0	122	160	45	1

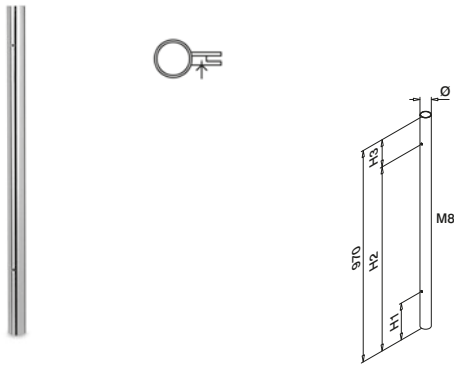
**MOD 0927****304**

INDOOR	Ø	H1	H2	H3	
13.0927.242.12	42,4 x 2,0	170	850	120	1

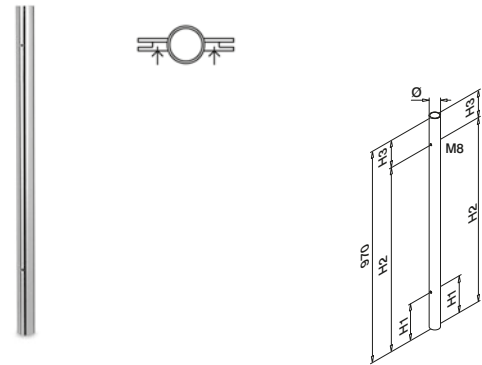
**MOD 0928****304**

INDOOR	Ø	H1	H2	H3	
13.0928.242.12	42,4 x 2,0	170	850	120	1
13.0928.248.12	48,3 x 2,0	170	850	120	1

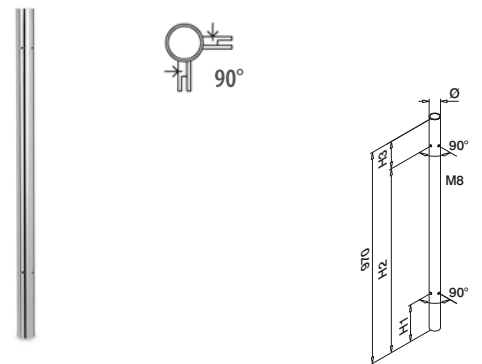

Bodemflenzen: zie pagina's 223 - 227

**MOD 0929****304**

INDOOR	Ø	H1	H2	H3	
13.0929.242.12	42,4 x 2,0	170	850	120	1
13.0929.248.12	48,3 x 2,0	170	850	120	1

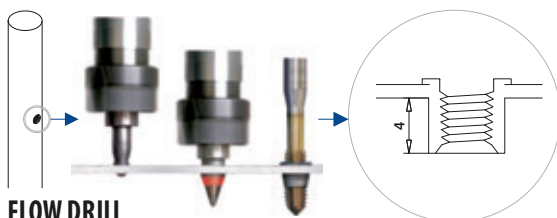

Q-INFO

**FLOW DRILL**

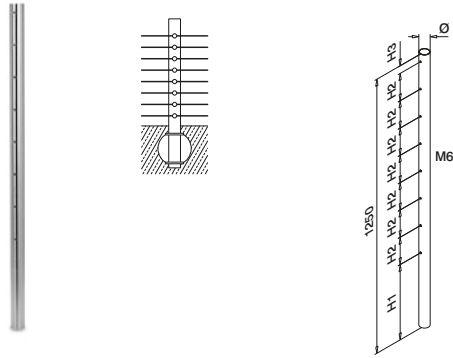

MOD 0935

304

INDOOR	Ø	H1	H2	H3	
13.0935.242.12	42,4 x 2,0	340	125	35	1

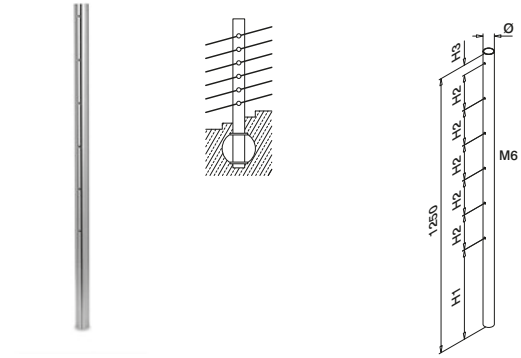

MOD 0936

304

INDOOR	Ø	H1	H2	H3	
13.0936.242.12	42,4 x 2,0	405	160	45	1

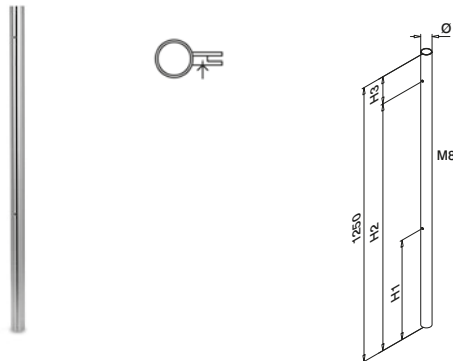

MOD 0937

304

INDOOR	Ø	H1	H2	H3	
13.0937.242.12	42,4 x 2,0	455	1130	120	1

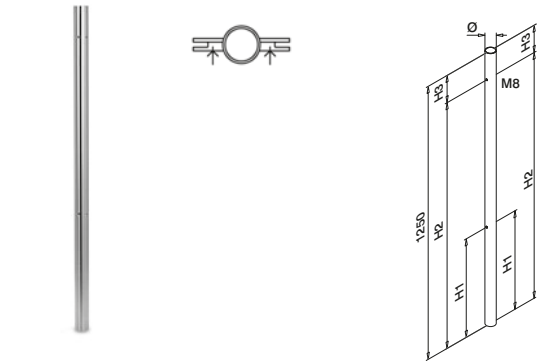

MOD 0938

304

INDOOR	Ø	H1	H2	H3	
13.0938.242.12	42,4 x 2,0	455	1130	120	1

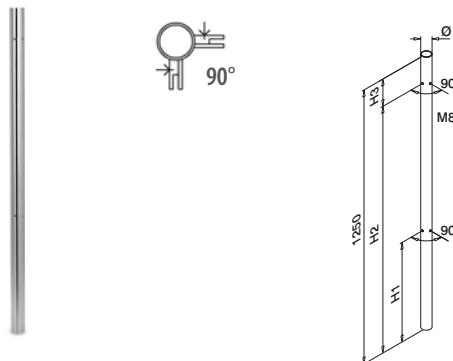

MOD 0939

304

INDOOR	Ø	H1	H2	H3	
13.0939.242.12	42,4 x 2,0	455	1130	120	1



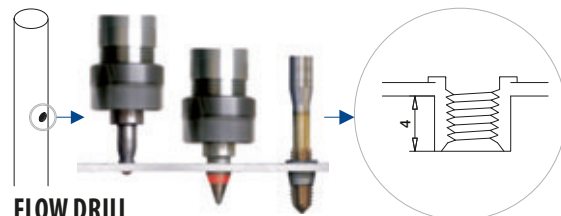

Balustersteunen: zie pagina 229 - 232

Q-INFO

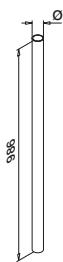

FLOW DRILL

**MOD 0901****304****INDOOR**

	Ø	
13.0901.242.12	42,4 x 2,0	1
13.0901.248.12	48,3 x 2,0	1

Balustersteunen: zie pagina 229 - 232

Bodemflenzen: zie pagina's 223 - 227

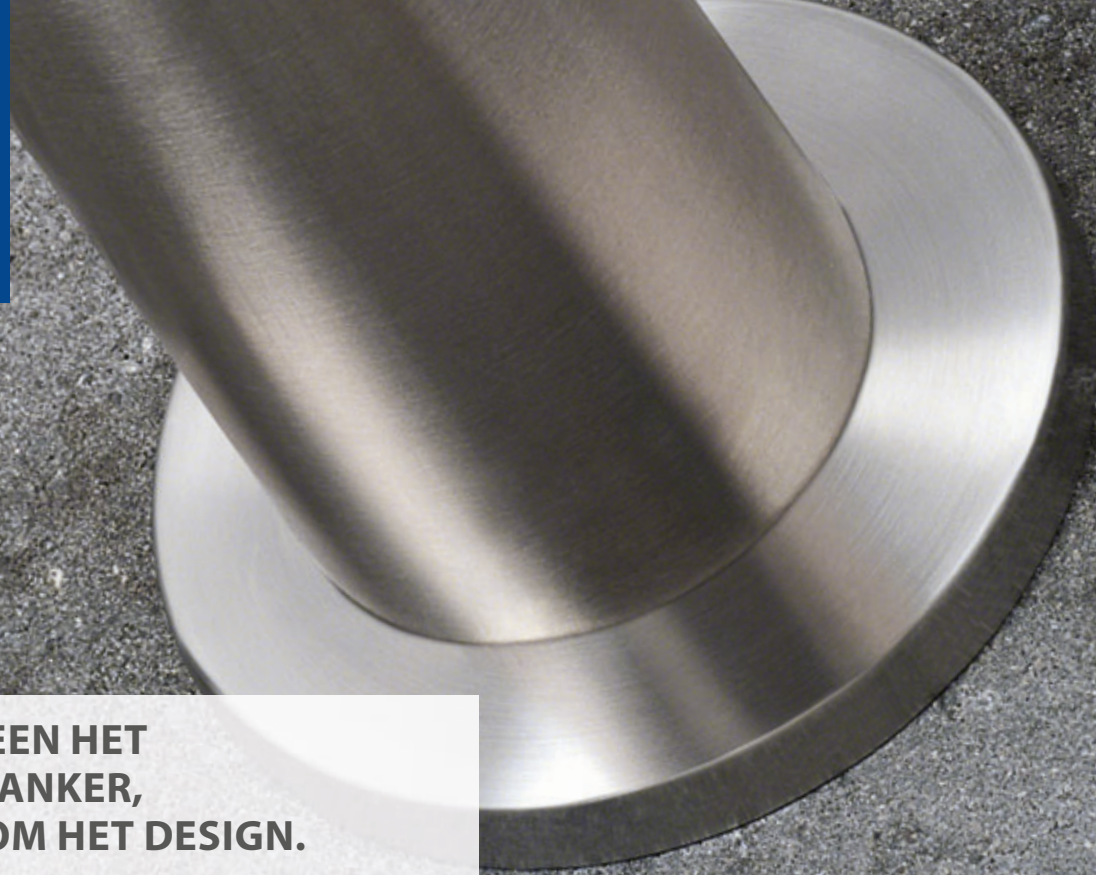

HET IS NIET ALLEEN HET ENKELVOUDIGE ANKER, HET GAAT OOK OM HET DESIGN.

Balusters

GESLEPEN

Q-LINE - Bodemflenzen voor lijmverbinding

geen afdekkap noodzakelijk

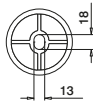
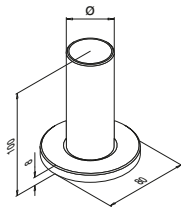

MOD 0946

304

INDOOR	Ø		
13.0946.242.12	42,4 x 2,0	QS-33 352	2
13.0946.248.12	48,3 x 2,0	QS-33 352	2



Q-INFO

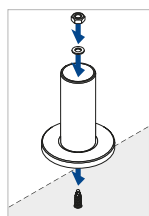
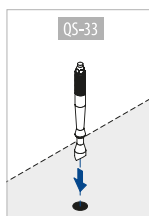
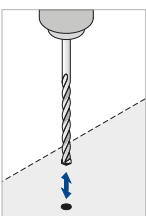

Q-21
Q-glu
50 ml
19.1331.000.00

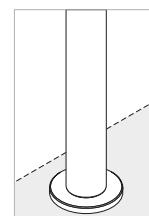
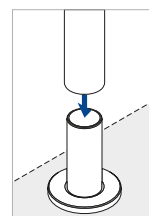
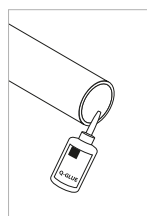

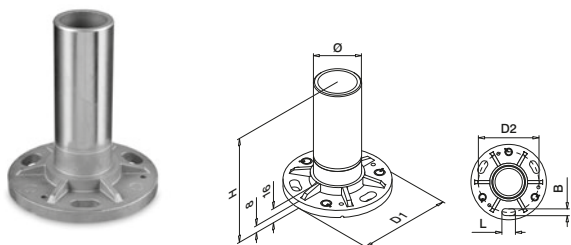
**MOD 0942****304**

INDOOR	Ø	H	D1	D2	B x L	Q5-35	Q5-35	Q5-35
13.0942.233.00	33,7 x 2,0	126	100	80	9x28	Q5-35	354	2
13.0942.242.00	42,4 x 2,0	126	100	80	9x18	Q5-35	354	2
13.0942.248.00	48,3 x 2,0	126	100	80	9x18	Q5-35	354	2
13.0942.060.00	60,3 x 2,0	126	120	90	11x30	Q5-59	354	2

316

OUTDOOR	Ø	H	D1	D2	B x L	Q5-34	Q5-34	Q5-34
14.0942.233.00	33,7 x 2,0	126	100	80	9x28	Q5-34	354	2
14.0942.242.00	42,4 x 2,0	126	100	80	9x18	Q5-34	354	2
14.0942.248.00	48,3 x 2,0	126	100	80	9x18	Q5-34	354	2
14.0942.060.00	60,3 x 2,0	126	120	90	11x30	Q5-58	354	2

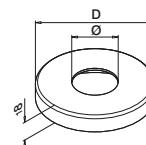
**MOD 0512****304**

INDOOR	Ø	D	Q5-35
13.0512.033.12	33,7	Ø 105	2
13.0512.042.12	42,4	Ø 105	2
13.0512.048.12	48,3	Ø 105	2

316

OUTDOOR	Ø	D	Q5-34
14.0512.033.12	33,7	Ø 105	2
14.0512.042.12	42,4	Ø 105	2
14.0512.048.12	48,3	Ø 105	2

MOD 0513**304**

INDOOR	Ø	D	Q5-34
13.0513.042.12	42,4	Ø 125	2
13.0513.048.12	48,3	Ø 125	2
13.0513.060.12	60,3	Ø 125	2

316

OUTDOOR	Ø	D	Q5-34
14.0513.042.12	42,4	Ø 125	2
14.0513.048.12	48,3	Ø 125	2
14.0513.060.12	60,3	Ø 125	2

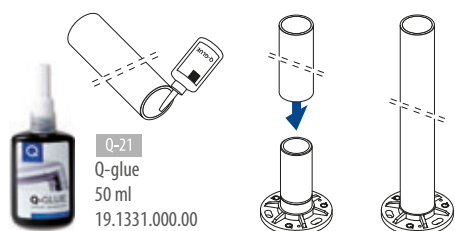
Q-INFO**MOD 0942**

Q-21
Q-glue
50 ml
19.1331.000.00

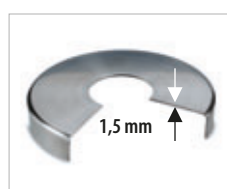
Q-INFO**MOD 0512 / 0513**

Voor model 0914 / 0944 / 0942 en
0940 / 0941

Q-INFO

Q-22
Q-ultra-clean
500 ml
19.0610.000.00



VOOR ELKE HOEK.

Balusters

GESLEPEN

Q-LINE - Bodemflenzen voor lijmverbinding

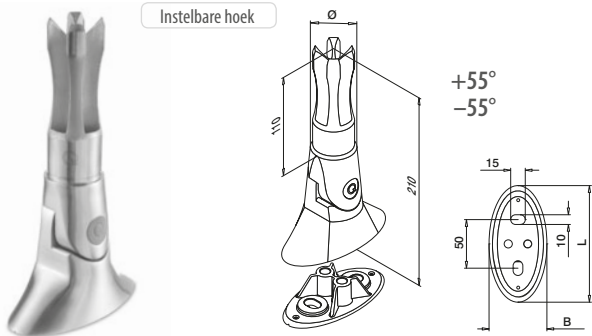

MOD 0945

304

INDOOR	Ø	B	L	⚙️	📦
13.0945.242.12	42,4 x 2,0	59	118	QS-65 352	1
13.0945.248.12	48,3 x 2,0	65	118	QS-65 352	1

316

OUTDOOR	Ø	B	L	⚙️	📦
14.0945.242.12	42,4 x 2,0	59	118	QS-64 352	1



Q-INFO

MOD 0945

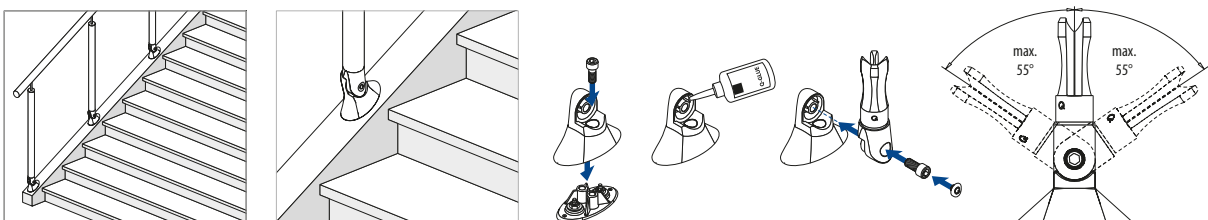



DE SLIMME OPLOSSING VOOR ZWEVENDE TRAPTREDEN.



Baluster-
railingsystemen

Balusters

GESLEPEN

Q-LINE - Trappenflenzen voor lijmverbinding

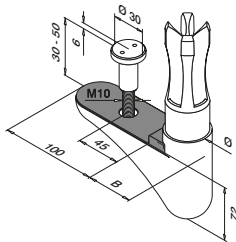

MOD 0947

304			
INDOOR	Ø	B	
13.0947.242.12	42,4 x 2,0	48	1



International Design Model Protection

Q-INFO

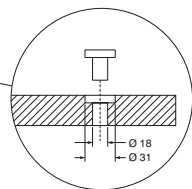
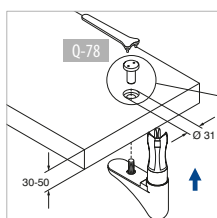

Q-21
Q-glu
50 ml
19.1331.000.00

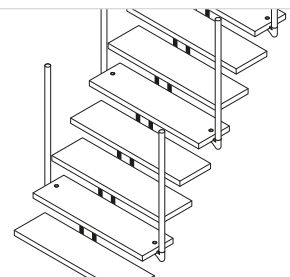
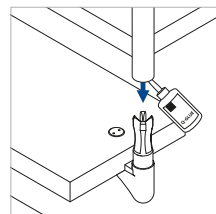

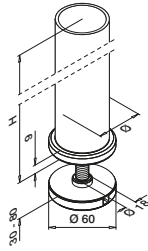

Complete set

**MOD 0544****304**

INDOOR	Ø	H	
13.0544.042.12	42,4 x 2,6	970	1
13.0544.048.12	48,3 x 2,6	970	1

MOD 0564**304**

INDOOR	Ø	H	
13.0564.242.12	42,4 x 2,0	1150	1

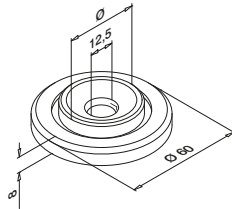
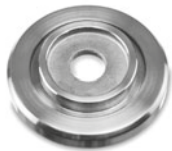
**MOD 0501****304**

INDOOR	Ø	
13.0501.042.12	42,4 x 2,0 + 42,4 x 2,6	2
13.0501.048.12	48,3 x 2,0 + 48,3 x 2,6	2

316

OUTDOOR	Ø	
14.0501.042.12	42,4 x 2,0 + 42,4 x 2,6	2

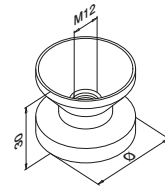
**MOD 3501****304**

INDOOR	Ø	
13.3501.242.00	42,4 x 2,0	2
13.3501.042.00	42,4 x 2,6	2

316

OUTDOOR	Ø	
14.3501.242.00	42,4 x 2,0	2

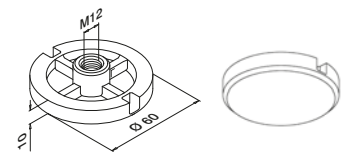
**MOD 0731****304**

INDOOR	
13.0731.060.12	2

316

OUTDOOR	
14.0731.060.12	2

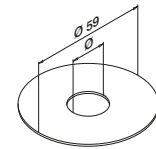
**MOD 5080**

	Ø	
19.5080.060.00	18	20

MOD 5081

	Ø	
19.5081.060.00	12	20

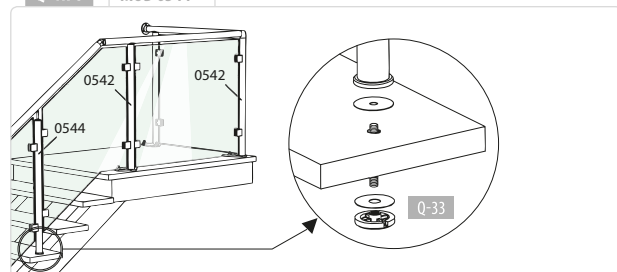
Q-INFO**Q-INFO****MOD 0544**



**ENKELVOUDIG
ANKER,
FLEXIBELE
BEVESTIGING,
RANK DESIGN.**





Hoek instelbaar

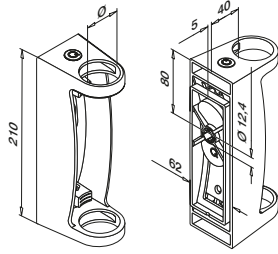

Hoek NIET instelbaar

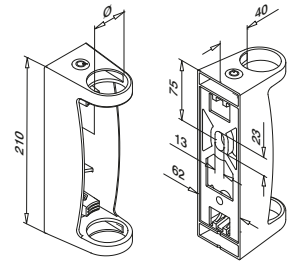

MOD 0556

304

INDOOR	∅		
13.0556.042.12	42,4	QS-33	352 1
13.0556.048.12	48,3	QS-33	352 1



International Design Model Protection

MOD 0558

304

INDOOR	∅		
13.0558.042.12	42,4	QS-33	352 1
13.0558.048.12	48,3	QS-33	352 1



International Design Model Protection



Hoek NIET instelbaar

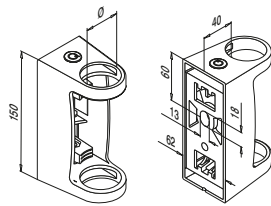

MOD 0557

304

INDOOR	∅		
13.0557.042.12	42,4	QS-33	352 1
13.0557.048.12	48,3	QS-33	352 1

316

OUTDOOR	∅		
14.0557.042.12	42,4	QS-32	352 1
14.0557.048.12	48,3	QS-32	352 1



International Design Model Protection

Q-INFO

MOD 0556

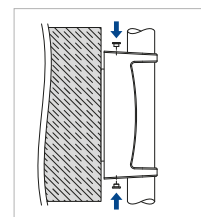
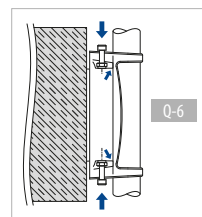
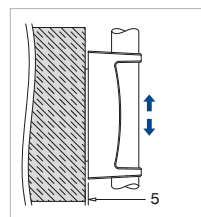
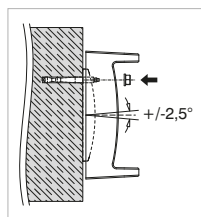
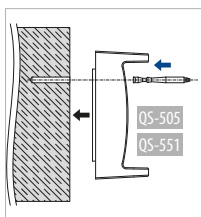

Q-INFO

MOD 0557 / 0558

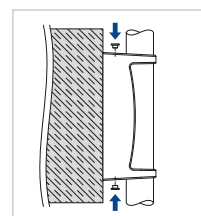
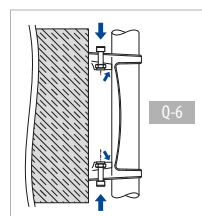
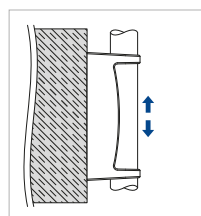
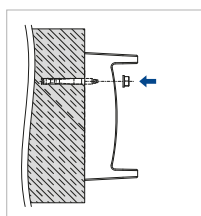
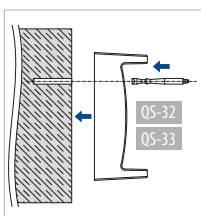

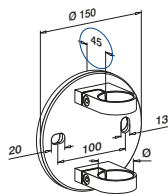

MOD 0551

304

INDOOR			
	Ø	Q-S-33	Q-S-32
13.0551.033.12	33,7	Q-S-33	352
13.0551.042.12	42,4	Q-S-33	352
13.0551.048.12	48,3	Q-S-33	352

316

OUTDOOR			
	Ø	Q-S-32	Q-S-31
14.0551.042.12	42,4	Q-S-32	352
14.0551.048.12	48,3	Q-S-32	352

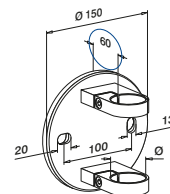

MOD 0552

304

INDOOR			
	Ø	Q-S-33	Q-S-32
13.0552.042.12	42,4	Q-S-33	352

316			
OUTDOOR			
	Ø	Q-S-32	Q-S-31
14.0552.042.12	42,4	Q-S-32	352
14.0552.048.12	48,3	Q-S-32	352

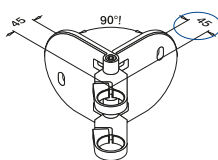
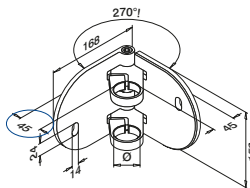

MOD 0555

304

INDOOR			
	Ø	Q-S-33	Q-S-32
13.0555.042.12	42,4	Q-S-33	352

316

OUTDOOR			
	Ø	Q-S-32	Q-S-31
14.0555.042.12	42,4	Q-S-32	352
14.0555.048.12	48,3	Q-S-32	352



Heeft u speciale wensen als het gaat om voorbereekte producten? Gebruik dan ons bestelformulier op pagina 366 - 403.

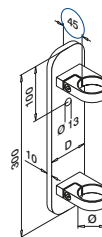

MOD 0553

304

INDOOR			
	Ø	D	Q-S-33
13.0553.042.12	42,4	70	Q-S-33

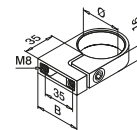

MOD 3507

304

INDOOR			
	Ø	B	Q-S-33
13.3507.033.12	33,7	45	Q-S-33
13.3507.042.12	42,4	50	Q-S-33
13.3507.048.12	48,3	55	Q-S-33

316

OUTDOOR			
	Ø	B	Q-S-31
14.3507.042.12	42,4	50	Q-S-31
14.3507.048.12	48,3	55	Q-S-31



Q-INFO

MOD 0551 / 0552

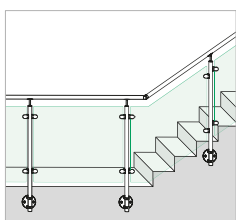

Q-INFO



Q-23
Q-cleaner
300 ml
19.0601.000.00

Q-INFO

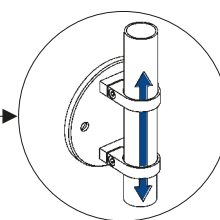

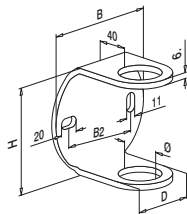

MOD 1550

304

INDOOR	Ø	H	B	B2	D		
13.1550.033.12	33,7	95	100	70	55	Q5-65	352 1
13.1550.042.12	42,4	110	120	85	65	Q5-65	352 1
13.1550.048.12	48,3	110	120	85	75	Q5-65	352 1



Waterpas

□ 40, Ø 42,4, Ø 48,3 mm

MOD 0500

	Q	
19.0500.000.00	Q-72	1

Q-INFO

MOD 0500





PERFECTE AFWERKING,
PERFECT RESULTAAT.

Balusters

GESLEPEN

Q-LINE - Balustersteunen



MOD 0550

304

INDOOR	Ø	
13.0550.042.12	42,4	2
13.0550.048.12	48,3	2

316

OUTDOOR	Ø	
14.0550.042.12	42,4	2
14.0550.048.12	48,3	2



Q-INFO

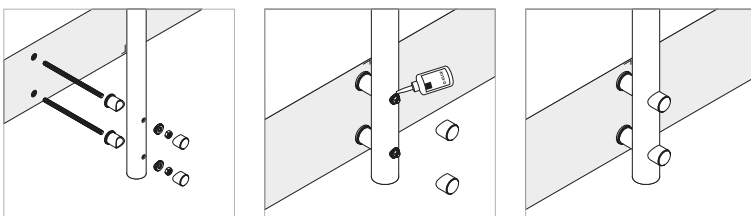

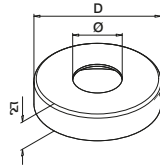
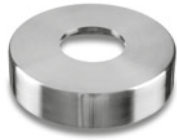
**MOD 0511****304**

INDOOR	Ø	D	
13.0511.042.12	42,4	Ø 110	2
13.0511.048.12	48,3	Ø 120	2

316

OUTDOOR	Ø	D	
14.0511.042.12	42,4	Ø 110	2
14.0511.048.12	48,3	Ø 120	2

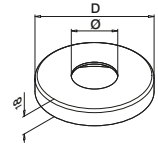
**MOD 0512****304**

INDOOR	Ø	D	
13.0512.000.12	-	Ø 105	2
13.0512.033.12	33,7	Ø 105	2
13.0512.042.12	42,4	Ø 105	2
13.0512.048.12	48,3	Ø 105	2
13.0512.060.12	60,3	Ø 105	2

316

OUTDOOR	Ø	D	
14.0512.033.12	33,7	Ø 105	2
14.0512.042.12	42,4	Ø 105	2
14.0512.048.12	48,3	Ø 105	2

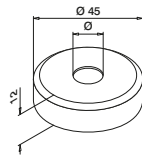
**MOD 0514****304**

INDOOR	Ø	
13.0514.000.12	-	2
13.0514.012.12	12,0	2
13.0514.014.12	14,0	2

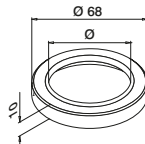
**MOD 0517****316**

OUTDOOR	Ø	
14.0517.048.12	48,3	2

MOD 0513**304**

INDOOR	Ø	D	
13.0513.042.12	42,4	Ø 125	2
13.0513.048.12	48,3	Ø 125	2
13.0513.060.12	60,3	Ø 125	2

316

OUTDOOR	Ø	D	
14.0513.042.12	42,4	Ø 125	2
14.0513.048.12	48,3	Ø 125	2
14.0513.060.12	60,3	Ø 125	2

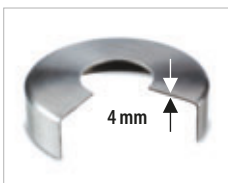
Q-INFO MOD 0511

Voor model 0912/0913 en 3502

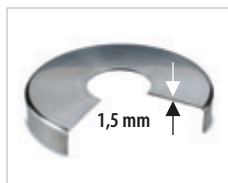
Q-INFO MOD 0512 / 0513

Voor model 0914 / 0944 / 0942 en 0940 / 0941

Q-INFO

Q-23
Q-cleaner
300 ml
19.0601.000.00

Q-INFO

Q-22
Q-ultra-clean
500 ml
19.0610.000.00

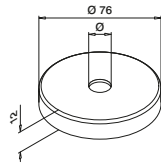
**MOD 0515****304**

INDOOR	Ø	
13.0515.012.12	12,0	2
13.0515.014.12	14,0	2
13.0515.033.12	33,7	2
13.0515.040.12	40,0	2
13.0515.042.12	42,4	2

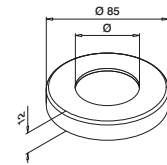
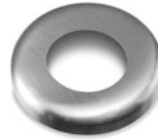
**MOD 0516****304**

INDOOR	Ø	
13.0516.033.12	33,7	2
13.0516.042.12	42,4	2

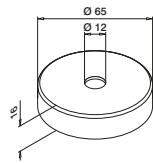
**MOD 0519****Zamak**

RVS look

INDOOR	
10.0519.065.19	2

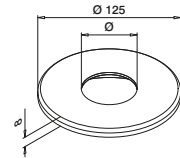
**MOD 3572****304**

INDOOR	Ø	
13.3572.248.12	48,3	2

Q-INFO

MOD 0519

Passend op model
0118 en 0113



Q-INFO

MOD 3572

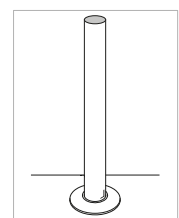
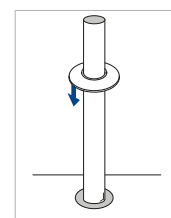
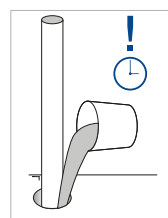



NOG GUNSTIGER GEPRIJSD: STALEN BUIS MET RVS BEKLEDING.

Handrailingen

GESLEPEN

Q-LINE - Buizen, RVS-bekleding

Q-TUBE

Baluster-
railingssystemen

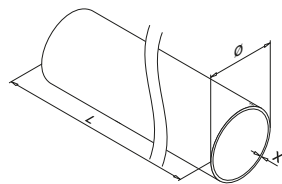

MOD 8925 / 0900

Ø 42,4 mm

Staal			
INDOOR	Ø	X	
12.8925.242.12	42,4	2,0	L = 2500 mm
12.0900.242.12	42,4	2,0	L = 5000 mm

Ø 48,3 mm

Staal			
INDOOR	Ø	X	
12.8925.248.12	48,3	2,0	L = 2500 mm
12.0900.248.12	48,3	2,0	L = 5000 mm



Q-INFO

MOD 12.8925 / 0900

Indoorconstructies (geen natte ruimtes)

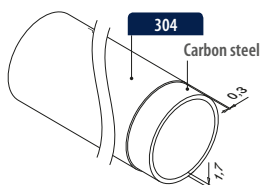

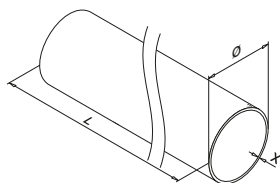

**Q-TUBE: BUIZEN MET DE
LAAGSTE TOLERANTIE.**

**MOD 8925 / 0900**

Ø 33,7 mm

304

INDOOR	X	
13.8925.233.12	2,0	L = 2500 mm
13.0900.233.12	2,0	L = 5000 mm

Ø 38 mm

316

OUTDOOR	X	
14.8930.138.12	1,5	L = 3000 mm

NEW

Ø 42,4 mm

304

INDOOR	X	
13.8925.142.12	1,5	L = 2500 mm
13.0900.142.12	1,5	L = 5000 mm
13.8925.242.12	2,0	L = 2500 mm
13.0900.242.12	2,0	L = 5000 mm
13.8925.042.12	2,6	L = 2500 mm
13.0900.042.12	2,6	L = 5000 mm

316

OUTDOOR	X	
14.0900.142.12	1,5	L = 5000 mm
14.8925.242.12	2,0	L = 2500 mm
14.0900.242.12	2,0	L = 5000 mm
14.8925.042.12	2,6	L = 2500 mm
14.0900.042.12	2,6	L = 5000 mm

NEW

Ø 48,3 mm

304

INDOOR	X	
13.8925.248.12	2,0	L = 2500 mm
13.0900.248.12	2,0	L = 5000 mm
13.8925.048.12	2,6	L = 2500 mm
13.0900.048.12	2,6	L = 5000 mm

316

OUTDOOR	X	
14.8925.248.12	2,0	L = 2500 mm
14.0900.248.12	2,0	L = 5000 mm
14.8925.048.12	2,6	L = 2500 mm
14.0900.048.12	2,6	L = 5000 mm

Ø 60,3 mm

304

INDOOR	X	
13.8925.060.12	2,0	L = 2500 mm
13.0900.060.12	2,0	L = 5000 mm



Houten handrailingen: zie pagina 174 - 181.

Heeft u speciale wensen als het gaat om voorbereide producten? Gebruik dan ons bestelformulier op pagina 366 - 403.

Q-INFO**Bespaar tijd en geld met Q-tube.**

Q-tube heeft een veel lagere tolerantie dan standaard handelsbuis. Ook de lasnaad van Q-tube is speciaal aangepast aan onze fittingen. De buis past daardoor perfect op onze fittingen zodat u snel en effectief kunt werken. Om de kwaliteit te waarborgen en om beschadigingen te voorkomen wordt elke lengte buis apart verpakt.

Q-INFO MOD 8925 / 0900

Berekeningsbasis voor buizen

	Ø (mm)	A (cm ²)	I _x =I _y (cm ⁴)	W _x =W _y (cm ³)	M (kg/m)	R _{p0,2} (kN/cm ²)	R _m (kN/cm ²)
13.0900.233.12 13.8925.233.12	33,7 x 2,0	1,99	2,51	1,49	1,56	23	54
14.8930.138.12	38,0 x 1,5	1,72	2,87	1,51	1,35	24	53
13.0900.142.12 13.8925.142.12	42,4 x 1,5	1,93	4,64	1,90	1,52	23	54
14.0900.142.12	42,4 x 1,5	1,93	4,64	1,90	1,52	24	53
13.0900.242.12 13.8925.242.12	42,4 x 2,0	2,53	5,19	2,44	1,98	23	54
14.0900.242.12 14.8925.242.12	42,4 x 2,0	2,53	5,19	2,44	1,98	24	53
13.0900.042.12 13.8925.042.12	42,4 x 2,6	3,25	6,46	3,04	2,55	23	54
14.0900.042.12 14.8925.042.12	42,4 x 2,6	3,25	6,46	3,04	2,55	24	53
13.0900.248.12 13.8925.248.12	48,3 x 2,0	2,90	7,80	3,23	2,28	23	54
14.0900.248.12 14.8925.248.12	48,3 x 2,0	2,90	7,80	3,23	2,28	24	53
13.0900.048.12 13.8925.048.12	48,3 x 2,6	3,73	9,78	4,04	2,93	23	54
14.0900.048.12 14.8925.048.12	48,3 x 2,6	3,73	9,78	4,04	2,93	24	53
13.0900.060.12 13.8925.060.12	60,3 x 2,0	3,66	15,58	5,17	2,87	23	54

A = oppervlakte dwarsdoorsnede
I_x / I_y = oppervlaktetraagheidsmoment
W_x / W_y = weerstandsmoment

M = massa
R_{p0,2} = toelaatbare spanning
R_m = minimale trekvastheid

Q-LINE - Bochtstukken



MOD 0903

304			
INDOOR	Ø	R	
13.0903.242.12	42,4 x 2,0	85	1
13.0903.248.12	48,3 x 2,0	97	1
316			
OUTDOOR	Ø	R	
14.0903.242.12	42,4 x 2,0	85	1

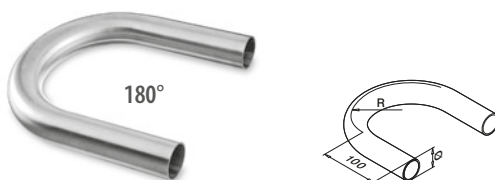

MOD 0906

304			
INDOOR	Ø	R	
13.0906.242.12	42,4 x 2,0	85	1
13.0906.248.12	48,3 x 2,0	97	1
316			
OUTDOOR	Ø	R	
14.0906.242.12	42,4 x 2,0	85	1

Q-LINE - Buissteunen

Vlak - buis

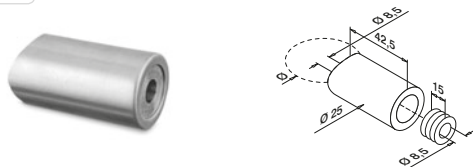

MOD 0625

304			
INDOOR	Ø		
13.0625.033.12	33,7	QS-3 348 / QS-29 349	4
13.0625.042.12	42,4	QS-3 348 / QS-29 349	4
13.0625.048.12	48,3	QS-3 348 / QS-29 349	4
316			
OUTDOOR	Ø		
14.0625.042.12	42,4	QS-4 348 / QS-30 349	4
14.0625.048.12	48,3	QS-4 348 / QS-30 349	4



Buis - buis

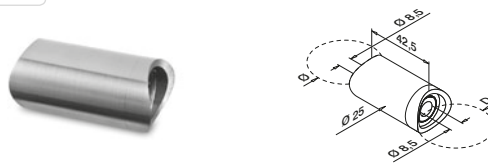

MOD 0627

304			
INDOOR	Ø	D	
13.0627.042.12	42,4	Ø 42,4	QS-29 349



Q-INFO

MOD 0625

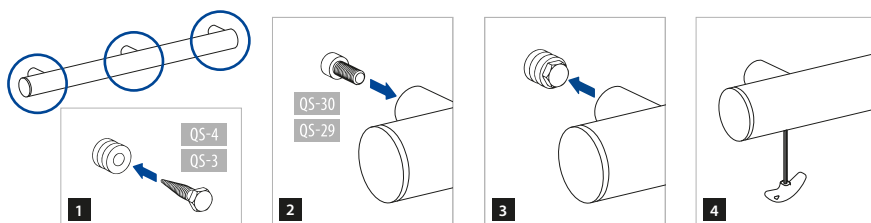

Q-INFO

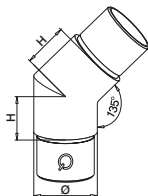

Q-23
Q-cleaner
300 ml
19.0601.000.00

**MOD 0300****304**

INDOOR	Ø	H	
13.0300.233.12	33,7 x 2,0	25	2
13.0300.242.12	42,4 x 2,0	30	2
13.0300.042.12	42,4 x 2,6	30	2
13.0300.248.12	48,3 x 2,0	35	2
13.0300.048.12	48,3 x 2,6	35	2

316

OUTDOOR	Ø	H	
14.0300.242.12	42,4 x 2,0	30	2
14.0300.042.12	42,4 x 2,6	30	2
14.0300.248.12	48,3 x 2,0	35	2
14.0300.048.12	48,3 x 2,6	35	2

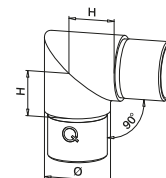
**MOD 0301****304**

INDOOR	Ø	H	
13.0301.233.12	33,7 x 2,0	25	2
13.0301.242.12	42,4 x 2,0	30	2
13.0301.042.12	42,4 x 2,6	30	2
13.0301.248.12	48,3 x 2,0	35	2
13.0301.048.12	48,3 x 2,6	35	2

316

OUTDOOR	Ø	H	
14.0301.242.12	42,4 x 2,0	30	2
14.0301.042.12	42,4 x 2,6	30	2
14.0301.248.12	48,3 x 2,0	35	2
14.0301.048.12	48,3 x 2,6	35	2

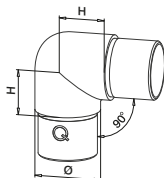

Niet toepasbaar bij MOD 0710 en 0810 (handrailingsteunen)

**MOD 0303****304**

INDOOR	Ø	H	
13.0303.233.12	33,7 x 2,0	25	2
13.0303.142.12	42,4 x 1,5	30	2
13.0303.242.12	42,4 x 2,0	30	2
13.0303.042.12	42,4 x 2,6	30	2
13.0303.248.12	48,3 x 2,0	35	2
13.0303.048.12	48,3 x 2,6	35	2
13.0303.060.12	60,3 x 2,0	40	2

316

OUTDOOR	Ø	H	
14.0303.242.12	42,4 x 2,0	30	2
14.0303.042.12	42,4 x 2,6	30	2
14.0303.248.12	48,3 x 2,0	35	2
14.0303.048.12	48,3 x 2,6	35	2

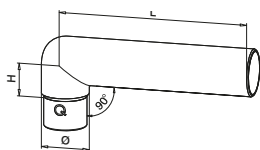

Toepasbaar bij MOD 0710 en 0810 (handrailingsteunen)

**MOD 0306****304**

INDOOR	Ø	H	L	
13.0306.233.12	33,7 x 2,0	25	223	2
13.0306.242.12	42,4 x 2,0	30	228	2
13.0306.248.12	48,3 x 2,0	35	233	2

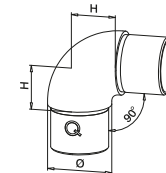

Combineer met verbinder 5792 op pagina 241.

**MOD 0305****304**

INDOOR	Ø	H	
13.0305.233.12	33,7 x 2,0	25	2
13.0305.242.12	42,4 x 2,0	30	2
13.0305.248.12	48,3 x 2,0	35	2

316

OUTDOOR	Ø	H	
14.0305.042.12	42,4 x 2,6	30	2
14.0305.242.12	42,4 x 2,0	30	2
14.0305.048.12	48,3 x 2,6	35	2
14.0305.248.12	48,3 x 2,0	35	2

NEW

NEW

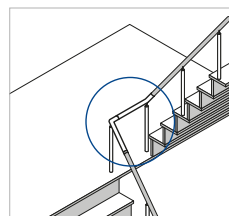

Niet toepasbaar bij MOD 0710 en 0810 (handrailingsteunen)

Q-INFO**MOD 0306**

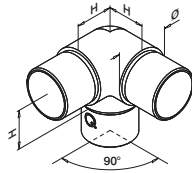

MOD 0304

304

INDOOR	Ø	H	
13.0304.233.12	33,7 x 2,0	25	2
13.0304.242.12	42,4 x 2,0	30	2
13.0304.042.12	42,4 x 2,6	30	2
13.0304.248.12	48,3 x 2,0	35	2
13.0304.048.12	48,3 x 2,6	35	2

316

OUTDOOR	Ø	H	
14.0304.242.12	42,4 x 2,0	30	2
14.0304.042.12	42,4 x 2,6	30	2
14.0304.248.12	48,3 x 2,0	35	2
14.0304.048.12	48,3 x 2,6	35	2

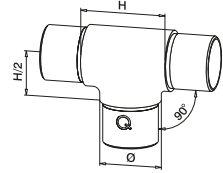

MOD 0307

304

INDOOR	Ø	H	
13.0307.233.12	33,7 x 2,0	50	2
13.0307.242.12	42,4 x 2,0	60	2
13.0307.042.12	42,4 x 2,6	60	2
13.0307.248.12	48,3 x 2,0	70	2
13.0307.048.12	48,3 x 2,6	70	2

316

OUTDOOR	Ø	H	
14.0307.242.12	42,4 x 2,0	60	2
14.0307.042.12	42,4 x 2,6	60	2
14.0307.248.12	48,3 x 2,0	70	2
14.0307.048.12	48,3 x 2,6	70	2

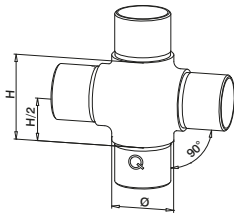

MOD 0309

304

INDOOR	Ø	H	H/2	
13.0309.242.12	42,4 x 2,0	60	30	2
13.0309.248.12	48,3 x 2,0	70	35	2

316

OUTDOOR	Ø	H	H/2	
14.0309.242.12	42,4 x 2,0	60	30	2
14.0309.248.12	48,3 x 2,0	70	35	2

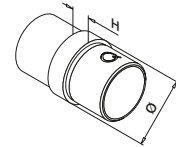

MOD 0790

304

INDOOR	Ø	
13.0790.233.12	33,7 x 2,0	2
13.0790.142.12	42,4 x 1,5	2
13.0790.242.12	42,4 x 2,0	2
13.0790.042.12	42,4 x 2,6	2
13.0790.248.12	48,3 x 2,0	2
13.0790.048.12	48,3 x 2,6	2
13.0790.060.12	60,3 x 2,0	2

316

OUTDOOR	Ø	
14.0790.242.12	42,4 x 2,0	2
14.0790.042.12	42,4 x 2,6	2
14.0790.248.12	48,3 x 2,0	2
14.0790.048.12	48,3 x 2,6	2



Q-INFO



Q-21
Q-glue
50 ml
19.1331.000.00



Verbruik per verbinding ca. 1 ml

Q-Video www.q-railing.com



HET ENIGE PRODUCT VAN Q-RAILING DAT NIEMAND TE ZIEN KRIJGT.

Handrailingen

GESLEPEN

Q-LINE - EASY HIT® - Verbinders

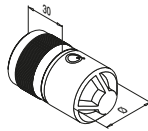

MOD 5792- EASY HIT®

304

INDOOR	Ø	
13.5792.242.00	42,4 x 2,0	2
13.5792.248.00	48,3 x 2,0	2

316

OUTDOOR	Ø	
14.5792.242.00	42,4 x 2,0	2
NEW 14.5792.042.00	42,4 x 2,6	2
14.5792.248.00	48,3 x 2,0	2
NEW 14.5792.048.00	48,3 x 2,6	2



International Design Model Protection

Q-INFO

MOD 5792

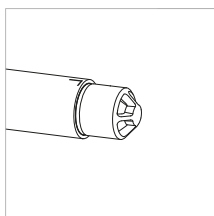
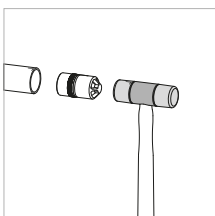

Q-21
Q-glue
50 ml
19.1331.000.00

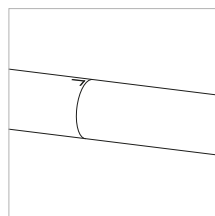

Q-INFO



Q-22
Q-ultra-clean
500 ml
19.0610.000.00



GENOEG VAN HET BUIGEN VAN BUIZEN?

Handrailingen

GESLEPEN

Q-LINE - Verbinders, flexibel



40 - 70°

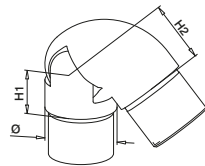

MOD 0319

316

OUTDOOR	Ø	H1	H2	Box
14.0319.242.12	42,4 x 2,0	27	35	2
14.0319.248.12	48,3 x 2,0	30	40	2



International Design Model Protection

Q-INFO

MOD 0319

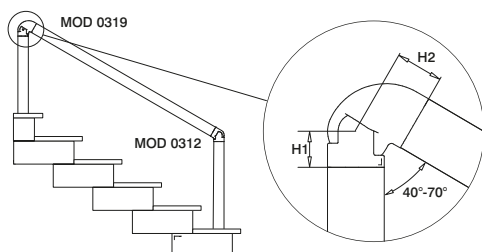

Montage A

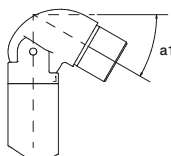

Montage B

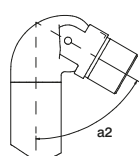

Q-INFO



Q-22

Q-ultra-clean
500 ml
19.0610.000.00



-90°
+90°

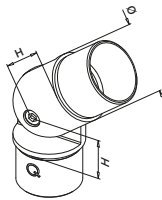

MOD 0302

304

INDOOR	Ø	H	
13.0302.233.12	33,7 x 2,0	22	2
13.0302.242.12	42,4 x 2,0	27	2
13.0302.042.12	42,4 x 2,6	27	2
13.0302.248.12	48,3 x 2,0	30	2
13.0302.048.12	48,3 x 2,6	30	2

316

OUTDOOR	Ø	H	
14.0302.242.12	42,4 x 2,0	27	2
14.0302.042.12	42,4 x 2,6	27	2
14.0302.248.12	48,3 x 2,0	30	2
14.0302.048.12	48,3 x 2,6	30	2



0 - 70°

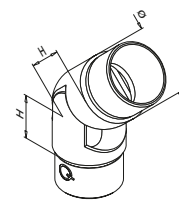

MOD 0312

304

INDOOR	Ø	H	
13.0312.233.12	33,7 x 2,0	30	2
13.0312.142.12	42,4 x 1,5	30	2
13.0312.242.12	42,4 x 2,0	27	2
13.0312.042.12	42,4 x 2,6	27	2
13.0312.248.12	48,3 x 2,0	30	2
13.0312.048.12	48,3 x 2,6	30	2

316

OUTDOOR	Ø	H	
14.0312.242.12	42,4 x 2,0	27	2
14.0312.042.12	42,4 x 2,6	27	2
14.0312.248.12	48,3 x 2,0	30	2
14.0312.048.12	48,3 x 2,6	30	2
14.0312.060.12	60,3 x 2,0	33	2

NEW



International Design Model Protection

Q-INFO



Q-23

Q-cleaner
300 ml

19.0601.000.00

Q-INFO



Q-21

Q-glue
50 ml

19.1331.000.00



**NOOIT MEER LASSEN:
FLEXIBELE VERBINDERS.**

Rechts omhoog
Links omlaag

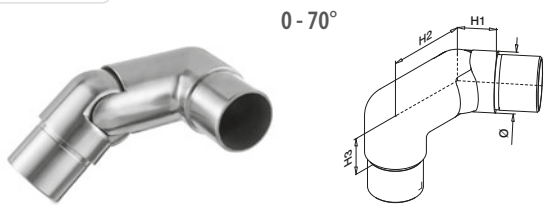

MOD 0317

304

INDOOR	Ø	H1	H2	H3	
13.0317.242.12	42,4 x 2,0	27	60	30	2
13.0317.248.12	48,3 x 2,0	30	65	35	2



Links omhoog
Rechts omlaag

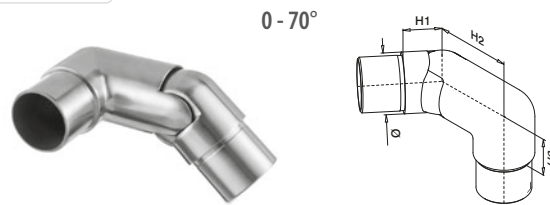

MOD 0318

304

INDOOR	Ø	H1	H2	H3	
13.0318.242.12	42,4 x 2,0	27	60	30	2
13.0318.248.12	48,3 x 2,0	30	65	35	2



0 - 90°



MOD 0791

304

INDOOR	Ø	H	
13.0791.242.12	42,4 x 2,0	30	2
13.0791.248.12	48,3 x 2,0	35	2

316

OUTDOOR	Ø	H	
14.0791.242.12	42,4 x 2,0	30	2
14.0791.248.12	48,3 x 2,0	35	2



Q-INFO MOD 0317



Q-21
Q-glue
50 ml
19.1331.000.00

90°

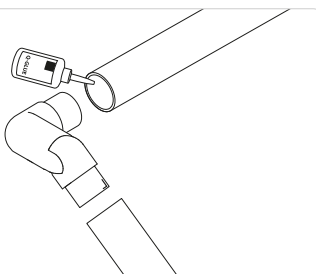

Q-INFO MOD 0318



Q-21
Q-glue
50 ml
19.1331.000.00

90°

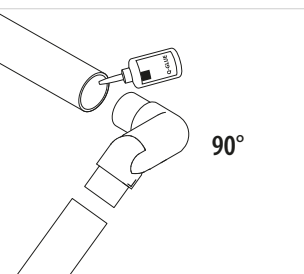



FLEX CONNECT®: FLEXIBELE VERBINDERS VOOR ELKE HOEK.

Baluster-
railingsystemen

Handrailingen

GESLEPEN

Q-LINE - FLEX CONNECT® - Verbinders, flexibel

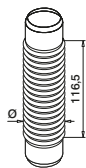

MOD 0315

304

INDOOR	Ø	flex	
13.0315.242.12	42,4 x 2,0	0° - 135°	2
13.0315.248.12	48,3 x 2,0	0° - 135°	2

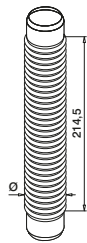

MOD 0316

304

INDOOR	Ø	flex	
13.0316.242.12	42,4 x 2,0	0° - 210°	2
13.0316.248.12	48,3 x 2,0	0° - 210°	2



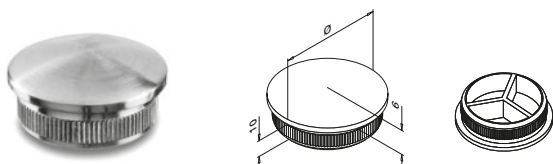

MOD 5729

304

INDOOR	Ø	
13.5729.233.12	33,7 x 2,0	2
13.5729.142.12	42,4 x 1,5	2
13.5729.242.12	42,4 x 2,0	2
13.5729.042.12	42,4 x 2,6	2
13.5729.248.12	48,3 x 2,0	2
13.5729.048.12	48,3 x 2,6	2

316

OUTDOOR	Ø	
14.5729.242.12	42,4 x 2,0	2
14.5729.042.12	42,4 x 2,6	2
14.5729.248.12	48,3 x 2,0	2
14.5729.048.12	48,3 x 2,6	2

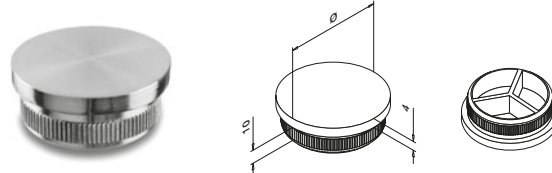

MOD 5732

304

INDOOR	Ø	
13.5732.233.12	33,7 x 2,0	2
13.5732.242.12	42,4 x 2,0	2
13.5732.042.12	42,4 x 2,6	2
13.5732.248.12	48,3 x 2,0	2
13.5732.048.12	48,3 x 2,6	2

316

OUTDOOR	Ø	
14.5732.242.12	42,4 x 2,0	2
14.5732.042.12	42,4 x 2,6	2
14.5732.248.12	48,3 x 2,0	2
14.5732.048.12	48,3 x 2,6	2

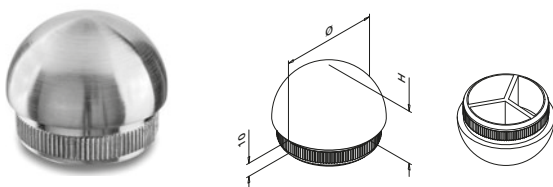

MOD 5730

304

INDOOR	Ø	H	
13.5730.233.12	33,7 x 2,0	17	2
13.5730.242.12	42,4 x 2,0	21	2
13.5730.042.12	42,4 x 2,6	21	2
13.5730.248.12	48,3 x 2,0	24	2

316

OUTDOOR	Ø	H	
14.5730.242.12	42,4 x 2,0	21	2
14.5730.248.12	48,3 x 2,0	24	2
14.5730.048.12	48,3 x 2,6	24	2

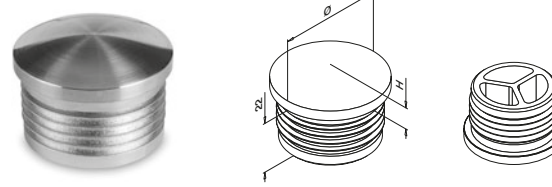

MOD 5729

ABS kunststof

RVS look

INDOOR	Ø	H	
24.5729.233.19	33,7 x 2,0	8	2
24.5729.242.19	42,4 x 2,0	9	2
24.5729.248.19	48,3 x 2,0	9	2



Q-INFO

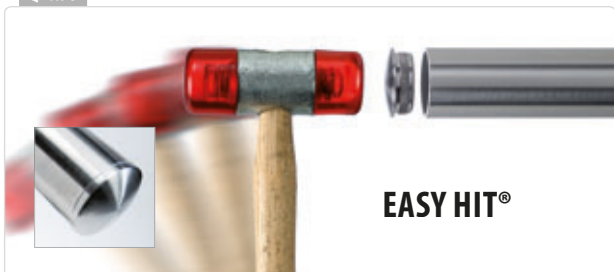

EASY HIT®

Q-INFO



Q-23

Q-cleaner
300 ml
19.0601.000.00

Q-INFO



Q-22

Q-ultra-clean
500 ml
19.0610.000.00

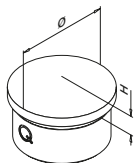
**MOD 0729****304**

INDOOR	Ø	H	
13.0729.233.12	33,7 x 2,0	8	2
13.0729.242.12	42,4 x 2,0	9	2
13.0729.042.12	42,4 x 2,6	9	2
13.0729.248.12	48,3 x 2,0	10	2
13.0729.048.12	48,3 x 2,6	10	2
13.0729.060.12	60,3 x 2,0	11	2

316

OUTDOOR	Ø	H	
14.0729.242.12	42,4 x 2,0	9	2
14.0729.042.12	42,4 x 2,6	9	2
14.0729.248.12	48,3 x 2,0	10	2
14.0729.048.12	48,3 x 2,6	10	2

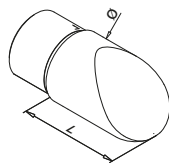
**MOD 0738****304**

INDOOR	Ø	L	
13.0738.242.12	42,4 x 2,0	60	2
13.0738.248.12	48,3 x 2,0	65	2

316

OUTDOOR	Ø	L	
14.0738.242.12	42,4 x 2,0	60	2
14.0738.248.12	48,3 x 2,0	65	2

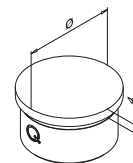

International Design Model Protection

**MOD 0732****304**

INDOOR	Ø	
13.0732.233.12	33,7 x 2,0	2
13.0732.242.12	42,4 x 2,0	2
13.0732.248.12	48,3 x 2,0	2

316

OUTDOOR	Ø	
14.0732.242.12	42,4 x 2,0	2
14.0732.248.12	48,3 x 2,0	2

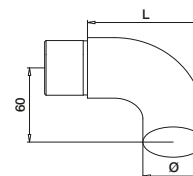
**MOD 0739****304**

INDOOR	Ø	L	
13.0739.233.12	33,7 x 2,0	77	2
13.0739.242.12	42,4 x 2,0	81	2
13.0739.042.12	42,4 x 2,6	81	2
13.0739.248.12	48,3 x 2,0	84	2
13.0739.048.12	48,3 x 2,6	84	2

316

OUTDOOR	Ø	L	
14.0739.242.12	42,4 x 2,0	81	2
14.0739.042.12	42,4 x 2,6	81	2
14.0739.248.12	48,3 x 2,0	84	2
14.0739.048.12	48,3 x 2,6	84	2



Q-INFO

MOD 0739

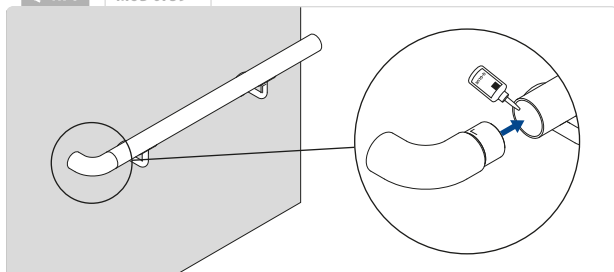

Q-INFO

MOD 0739

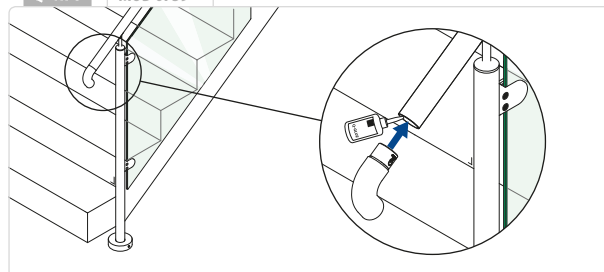

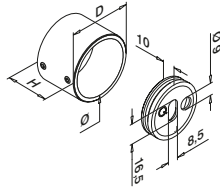

**U WORDT OP UW WENKEN
BEDIEND: EEN MUURSTEUN
ZONDER ZICHTBARE SCHROEVEN.**

**MOD 0504****304**

INDOOR	Ø	D	H			
13.0504.042.12	42,4	50	35	QS-55	351 / QS-21	349 2
13.0504.048.12	48,3	56	35	QS-55	351 / QS-21	349 2

316

OUTDOOR	Ø	D	H			
14.0504.042.12	42,4	50	35	QS-55	351 / QS-22	349 2
14.0504.048.12	48,3	56	35	QS-55	351 / QS-22	349 2

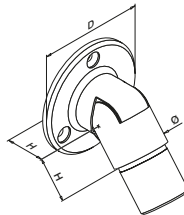

0 - 50°

**MOD 0506****304**

INDOOR	Ø	D	H			
13.0506.233.12	33,7 x 2,0	70	26	QS-7	348	2
13.0506.242.12	42,4 x 2,0	75	30	QS-7	348	2
13.0506.248.12	48,3 x 2,0	80	33	QS-7	348	2

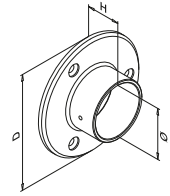

International Design Model Protection

**MOD 0505****304**

INDOOR	Ø	D	H			
13.0505.033.12	33,7	Ø 85	30	QS-7	348	2
13.0505.042.12	42,4	Ø 95	30	QS-7	348	2
13.0505.048.12	48,3	Ø 100	35	QS-7	348	2
13.0505.060.12	60,3	Ø 115	40	QS-7	348	2

316

OUTDOOR	Ø	D	H			
14.0505.042.12	42,4	Ø 95	30	QS-6	348	2
14.0505.048.12	48,3	Ø 100	35	QS-6	348	2

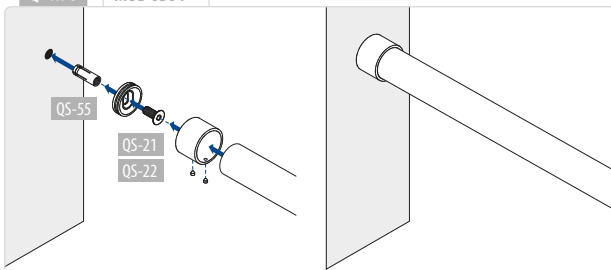
**Q-INFO****MOD 0504****Q-INFO**

Q-23
Q-cleaner
300 ml
19.0601.000.00

Q-INFO

Q-22
Q-ultra-clean
500 ml
19.0610.000.00

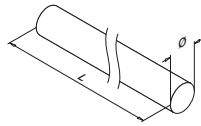
**MOD 0900 / 8925**

Ø 10 mm

304

INDOOR	Ø	
13.8925.010.12	10	L = 2500 mm
13.0900.010.12	10	L = 5000 mm

Ø 12 mm

304

INDOOR	Ø	
13.8925.012.12	12	L = 2500 mm
13.0900.012.12	12	L = 5000 mm

316**OUTDOOR**

OUTDOOR	Ø	
14.8925.012.12	12	L = 2500 mm
14.0900.012.12	12	L = 5000 mm

Ø 14 mm

304

INDOOR	Ø	
13.8925.014.12	14	L = 2500 mm
13.0900.014.12	14	L = 5000 mm

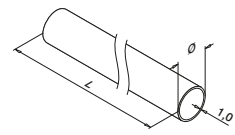
**MOD 0900 / 8925**

Ø 12 mm

304

INDOOR	Ø	
13.8925.112.12	12	L = 2500 mm
13.0900.112.12	12	L = 5000 mm

Ø 14 mm

304

INDOOR	Ø	
13.8925.114.12	14	L = 2500 mm
13.0900.114.12	14	L = 5000 mm

Ø 16 mm

304

INDOOR	Ø	
13.8925.016.12	16	L = 2500 mm
13.0900.016.12	16	L = 5000 mm

316**OUTDOOR**

OUTDOOR	Ø	
14.8925.016.12	16	L = 2500 mm
14.0900.016.12	16	L = 5000 mm

**Q-INFO**

Berekeningsbasis voor staven

calculated by

	Ø (mm)	A (cm ²)	I _x =I _y (cm ⁴)	W _x =W _y (cm ³)	M (kg/m)	R _{p0,2} (kN/cm ²)	R _m (kN/cm ²)
13.0900.010.12 / 13.8925.010.12	10	0,78	0,05	0,10	0,62	23	54
13.0900.012.12 / 13.8925.012.12	12	1,13	0,10	0,17	0,89	23	54
14.0900.012.12 / 14.8925.012.12	12	1,13	0,10	0,17	0,89	24	53
13.0900.014.12 / 13.8925.014.12	14	1,54	0,19	0,27	1,21	23	54

A = oppervlakte dwarsdoorsnede
 I_x / I_y = oppervlaktetraagheidsmoment
 W_x / W_y = weerstandsmoment
 M = massa
 R_{p0,2} = toelaatbare spanning
 R_m = minimale trekvastheid

Q-INFO

Berekeningsbasis voor buizen

calculated by

	Ø (mm)	A (cm ²)	I _x =I _y (cm ⁴)	W _x =W _y (cm ³)	M (kg/m)	R _{p0,2} (kN/cm ²)	R _m (kN/cm ²)
13.0900.012.12 / 13.8925.012.12	12 x 1,0	0,34	0,05	0,09	0,27	23	54
13.0900.014.12 / 13.8925.014.12	14 x 1,0	0,41	0,09	0,12	0,32	23	54
13.0900.016.12 / 13.8925.016.12	16 x 1,0	0,47	0,13	0,17	0,37	23	54
14.0900.016.12 / 14.8925.016.12	16 x 1,0	0,47	0,13	0,17	0,37	24	53

A = oppervlakte dwarsdoorsnede
 I_x / I_y = oppervlaktetraagheidsmoment
 W_x / W_y = weerstandsmoment
 M = massa
 R_{p0,2} = toelaatbare spanning
 R_m = minimale trekvastheid

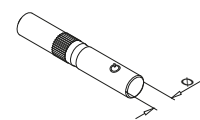
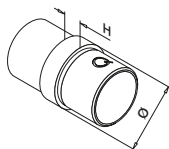

MOD 0790

304

INDOOR	Ø	H	
13.0790.112.12	12 x 1,0	5	4
13.0790.016.12	16 x 1,0	6	4

316

OUTDOOR	Ø	H	
14.0790.016.12	16 x 1,0	6	4



MOD 5792 - EASY HIT®

304

INDOOR	Ø	
13.5792.112.00	12 x 1,0	4



International Design Model Protection



-90°
+90°

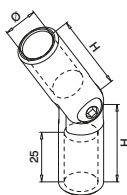

-90°
+90°

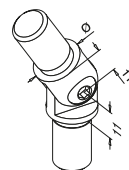

MOD 0302

304

INDOOR	Ø	H	
13.0302.010.12	10	35	6
13.0302.012.12	12	36	6
13.0302.014.12	14	37	6

316

OUTDOOR	Ø	H	
14.0302.012.12	12	36	6



MOD 0302

304

INDOOR	Ø	
13.0302.016.12	16 x 1,0	6

316

OUTDOOR	Ø	
14.0302.016.12	16 x 1,0	6



Q-INFO



Q-22
Q-ultra-clean
500 ml
19.0610.000.00

Q-INFO

MOD 5792

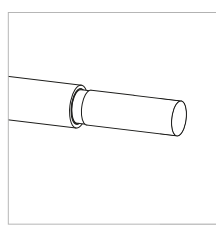
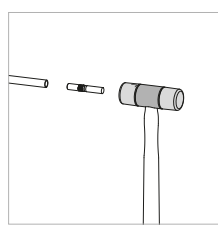

Q-21
Q-glue
50 ml
19.1331.000.00

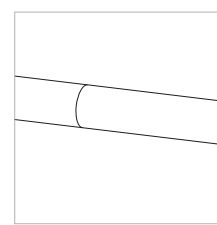

Vullingen

GESLEPEN

Q-LINE - Eindstukken

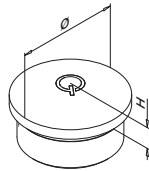

MOD 0729

304

INDOOR	Ø	H	
13.0729.016.12	16,0 x 1,0	4	2

316

OUTDOOR	Ø	H	
14.0729.016.12	16,0 x 1,0	4	2



Vullingen

RVS LOOK

Q-LINE - Eindstukken

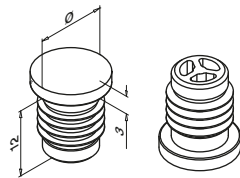

MOD 5729- EASY HIT®

ABS kunststof

RVS look

INDOOR	Ø	H	
24.5729.112.19	12 x 1,0	3	4
24.5729.114.19	14 x 1,0	3	4
24.5729.116.19	16 x 1,0	4	4



Vullingen

GESLEPEN

Q-LINE - EASY HIT® - Eindstukken

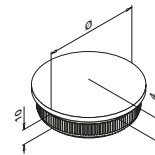

MOD 5729- EASY HIT®

304

INDOOR	Ø	
13.5729.112.12	12 x 1,0	4
13.5729.114.12	14 x 1,0	4



Baluster-
railingsystemen

Q-INFO

MOD 5729

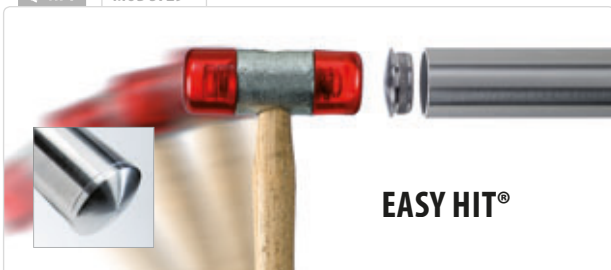

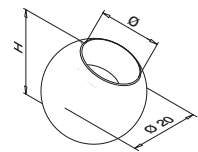
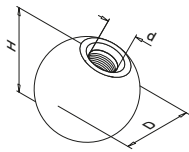

MOD 0220

304				
INDOOR	D	H	d	
13.0220.020.12	Ø 20	ca. 18,5	M6	6
13.0220.025.12	Ø 25	ca. 23,5	M8	6
13.0220.030.12	Ø 30	ca. 28,5	M8	6
13.0220.040.12	Ø 40	ca. 38,5	M8	2
13.0220.050.12	Ø 50	ca. 48,5	M8	2

316				
OUTDOOR	D	H	d	
14.0220.020.12	Ø 20	ca. 18,5	M6	6
14.0220.025.12	Ø 25	ca. 23,5	M8	6
14.0220.030.12	Ø 30	ca. 28,5	M8	6
14.0220.040.12	Ø 40	ca. 38,5	M8	2

MOD 0221

304			
INDOOR	Ø	H	
13.0221.010.12	10	ca. 18,5	6
13.0221.012.12	12	ca. 17,5	6
13.0221.014.12	14	ca. 16,5	6

316			
OUTDOOR	Ø	H	
14.0221.012.12	12	ca. 17,5	6



Voor staf

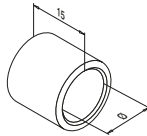

MOD 0735

304			
INDOOR	Ø		
13.0735.012.12	12	QS-5	348

316			
OUTDOOR	Ø		
14.0735.012.12	12	QS-6	348



Q-INFO

MOD 0735

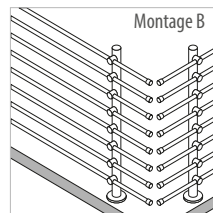
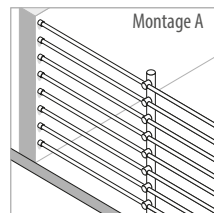
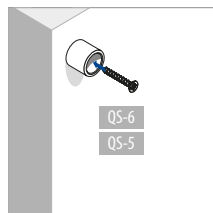
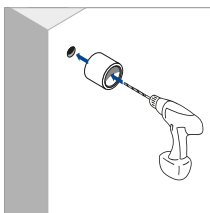

Q-INFO



Q-23
Q-cleaner
300 ml
19.0601.000.00

Q-LINE - Stafhouders (flexibel)

Vlak - staf

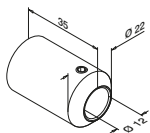

MOD 0850

304

INDOOR		
13.0850.000.12	QS-23 349	4

316

OUTDOOR		
14.0850.000.12	QS-53 349	4



Buis - staf

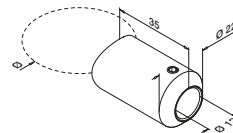

MOD 0850

304

INDOOR			
13.0850.042.12	Ø 42,4	QS-23 349	4
13.0850.048.12	Ø 48,3	QS-23 349	4

316

OUTDOOR			
14.0850.042.12	Ø 42,4	QS-53 349	4



Vlak - staf

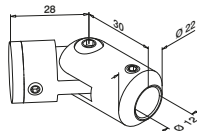

MOD 0855

304

INDOOR		
13.0855.000.12	QS-15 349	4



Buis - staf

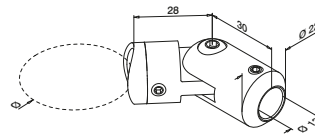

MOD 0855

304

INDOOR			
13.0855.042.12	Ø 42,4	QS-15 349	4



Q-INFO

MOD 0850

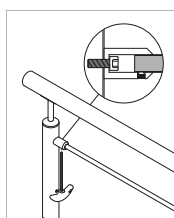
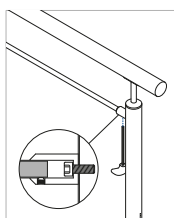
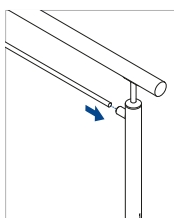
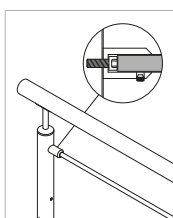
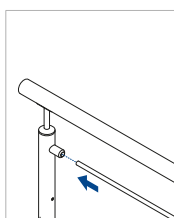
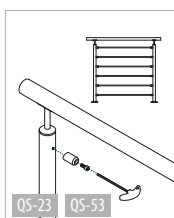

Vlak - staf

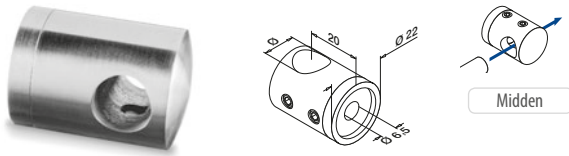

MOD 0825 - Ø 10 mm

304			
INDOOR	Ø		
13.0825.000.12	10	QS-15 349	4

MOD 0830 - Ø 12 mm

304			
INDOOR	Ø		
13.0830.000.12	12	QS-15 349	4
316			
OUTDOOR	Ø		
14.0830.000.12	12	QS-16 349	4
Zamak	RVS look		
OUTDOOR	Ø		
10.0830.000.20	12	QS-16 349	4



Vlak - staf

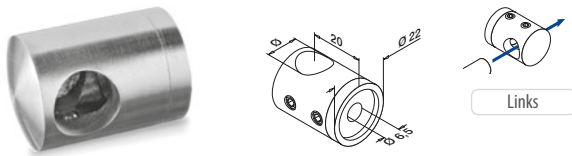

MOD 0832 - Ø 12 mm

304			
INDOOR	Ø		
13.0832.000.12	12	QS-15 349	4
316			
OUTDOOR	Ø		
14.0832.000.12	12	QS-16 349	4
Zamak	RVS look		
OUTDOOR	Ø		
10.0832.000.20	12	QS-16 349	4



Vlak - staf

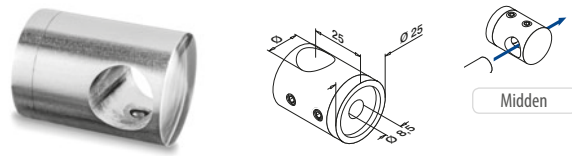

MOD 0835 - Ø 14 mm

304			
INDOOR	Ø		
13.0835.000.12	14	QS-19 349	4

MOD 0840 - Ø 16 mm

304			
INDOOR	Ø		
13.0840.000.12	16	QS-19 349	4
316			
OUTDOOR	Ø		
14.0840.000.12	16	QS-20 349	4



Vlak - staf

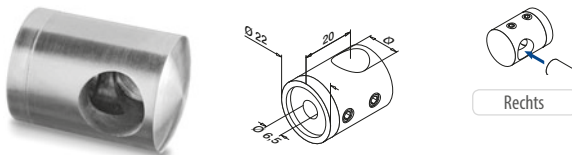

MOD 0833 - Ø 12 mm

304			
INDOOR	Ø		
13.0833.000.12	12	QS-15 349	4
316			
OUTDOOR	Ø		
14.0833.000.12	12	QS-16 349	4
Zamak	RVS look		
OUTDOOR	Ø		
10.0833.000.20	12	QS-16 349	4



Q-INFO

Zamak



Q-INFO



Q-INFO



Vlak - staf

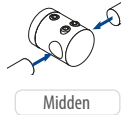
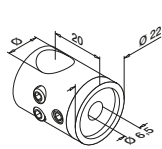

Midden

MOD 0826 - Ø 10 mm

304

INDOOR	Ø		
13.0826.000.12	10	QS-15 349	4

MOD 0831 - Ø 12 mm

304

INDOOR	Ø		
13.0831.000.12	12	QS-15 349	4

316

OUTDOOR	Ø		
14.0831.000.12	12	QS-16 349	4

Zamak

RVS look

OUTDOOR	Ø		
10.0831.000.20	12	QS-16 349	4



Heeft u speciale wensen als het gaat om voorbereekte producten? Gebruik dan ons bestelformulier op pagina 366 - 403.

Vlak - staf

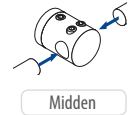
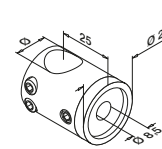

Midden

MOD 0836 - Ø 14 mm

304

INDOOR	Ø		
13.0836.000.12	14	QS-19 349	4



Q-INFO

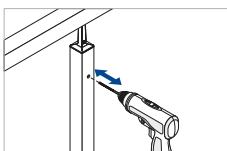

Ø10 / Ø12 = M6
Ø14 = M8

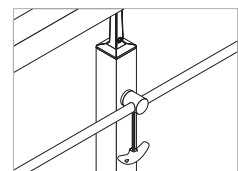
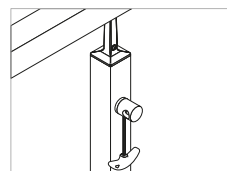
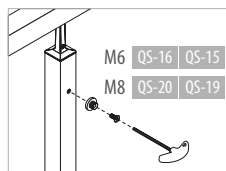
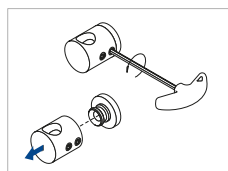

Buis - staf

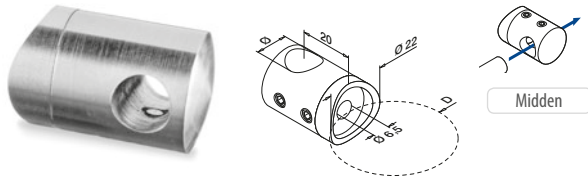

MOD 0825 - Ø 10 mm

304				
INDOOR	Ø	D		
13.0825.033.12	10	Ø 33,7	QS-15	349 4
13.0825.042.12	10	Ø 42,4	QS-15	349 4

MOD 0830 - Ø 12 mm

304				
INDOOR	Ø	D		
13.0830.033.12	12	Ø 33,7	QS-15	349 4
13.0830.042.12	12	Ø 42,4	QS-15	349 4
13.0830.048.12	12	Ø 48,3	QS-15	349 4

316				
OUTDOOR	Ø	D		
14.0830.042.12	12	Ø 42,4	QS-16	349 4
14.0830.048.12	12	Ø 48,3	QS-16	349 4

Zamak	RVS look	Ø	D		
OUTDOOR		12	Ø 33,7	QS-16	349 4
		12	Ø 42,4	QS-16	349 4



Buis - staf

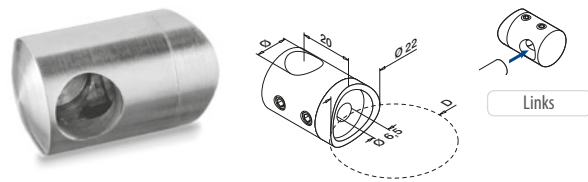

MOD 0832 - Ø 12 mm

304				
INDOOR	Ø	D		
13.0832.033.12	12	Ø 33,7	QS-15	349 4
13.0832.042.12	12	Ø 42,4	QS-15	349 4
13.0832.048.12	12	Ø 48,3	QS-15	349 4

316				
OUTDOOR	Ø	D		
14.0832.042.12	12	Ø 42,4	QS-16	349 4

Zamak	RVS look	Ø	D		
OUTDOOR		12	Ø 42,4	QS-16	349 4



Buis - staf

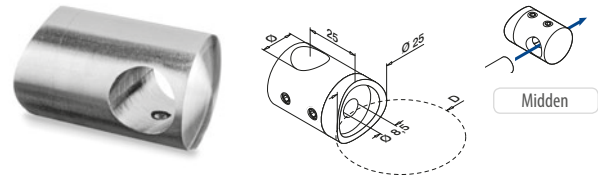

MOD 0835 - Ø 14 mm

304				
INDOOR	Ø	D		
13.0835.042.12	14	Ø 42,4	QS-19	349 4
13.0835.048.12	14	Ø 48,3	QS-19	349 4

MOD 0840 - Ø 16 mm

304				
INDOOR	Ø	D		
13.0840.042.12	16	Ø 42,4	QS-19	349 4
13.0840.048.12	16	Ø 48,3	QS-19	349 4

316				
OUTDOOR	Ø	D		
14.0840.042.12	16	Ø 42,4	QS-20	349 4
14.0840.048.12	16	Ø 48,3	QS-20	349 4



Buis - staf

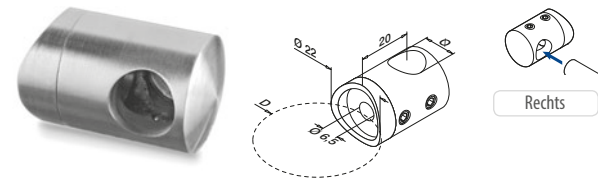

MOD 0833 - Ø 12 mm

304				
INDOOR	Ø	D		
13.0833.033.12	12	Ø 33,7	QS-15	349 4
13.0833.042.12	12	Ø 42,4	QS-15	349 4
13.0833.048.12	12	Ø 48,3	QS-15	349 4

316				
OUTDOOR	Ø	D		
14.0833.042.12	12	Ø 42,4	QS-16	349 4

Zamak	RVS look	Ø	D		
OUTDOOR		12	Ø 42,4	QS-16	349 4



Q-INFO

Zamak

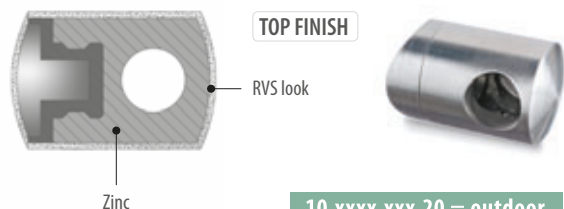

10.xxxx.xxx.20 = outdoor

Buis - staf

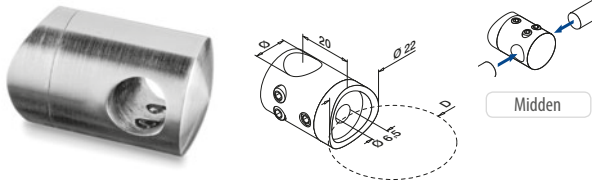

MOD 0826 - Ø 10 mm

304				
INDOOR	Ø	D		
13.0826.033.12	10	Ø 33,7	QS-15	349 4
13.0826.042.12	10	Ø 42,4	QS-15	349 4

MOD 0831 - Ø 12 mm

304				
INDOOR	Ø	D		
13.0831.033.12	12	Ø 33,7	QS-15	349 4
13.0831.042.12	12	Ø 42,4	QS-15	349 4
13.0831.048.12	12	Ø 48,3	QS-15	349 4

316				
OUTDOOR	Ø	D		
14.0831.042.12	12	Ø 42,4	QS-16	349 4
14.0831.048.12	12	Ø 48,3	QS-16	349 4

Zamak		RVS look		
OUTDOOR	Ø	D		
10.0831.033.20	12	Ø 33,7	QS-16	349 4
10.0831.042.20	12	Ø 42,4	QS-16	349 4
10.0831.048.20	12	Ø 48,3	QS-16	349 4



Buis - staf

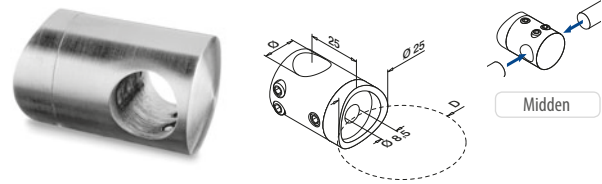

MOD 0836 - Ø 14 mm

304				
INDOOR	Ø	D		
13.0836.042.12	14	Ø 42,4	QS-19	349 4



Staf - staf



MOD 0840 - Ø 16 mm

304			
INDOOR	Ø	D	
13.0840.016.12	16	Ø 16	4



Staf - staf



MOD 0830 - Ø 12 mm

304			
INDOOR	Ø	D	
13.0830.012.12	12	Ø 12	4
13.0830.016.12	12	Ø 16	4



Q-INFO

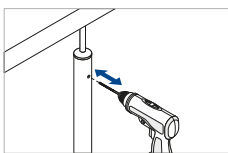

Ø10 / Ø12 = M6
 Ø14 = M8

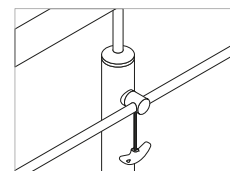
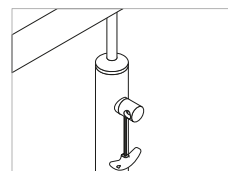
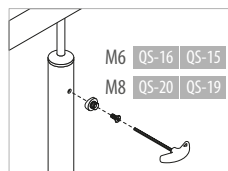
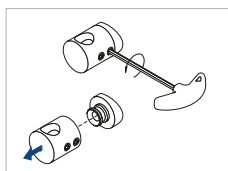



**ALLEEN
VERKRIJGBAAR
BIJ Q-RAILING.**

Buitenhoek

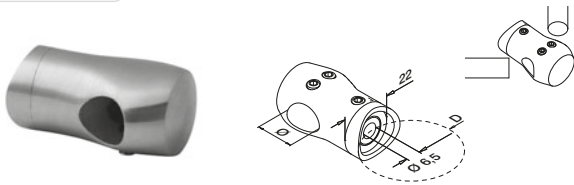

MOD 0839 - Ø 12 mm

304

INDOOR	Ø	D		
13.0839.042.12	12	Ø 42,4	QS-15  349	4
13.0839.048.12	12	Ø 48,3	QS-15  349	4

316

OUTDOOR	Ø	D		
14.0839.042.12	12	Ø 42,4	QS-16  349	4
14.0839.048.12	12	Ø 48,3	QS-16  349	4



International Design Model Protection

Binnenhoek

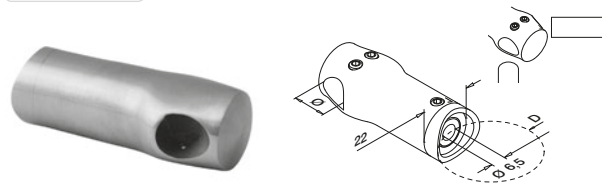

MOD 0834 - Ø 12 mm

304

INDOOR	Ø	D		
13.0834.042.12	12	Ø 42,4	QS-15  349	4
13.0834.048.12	12	Ø 48,3	QS-15  349	4

316

OUTDOOR	Ø	D		
14.0834.042.12	12	Ø 42,4	QS-16  349	4
14.0834.048.12	12	Ø 48,3	QS-16  349	4



International Design Model Protection

Q-INFO MOD 0839

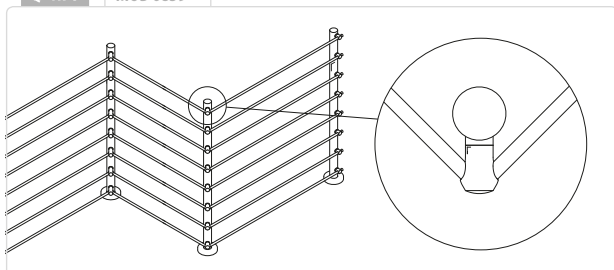

Q-INFO MOD 0834

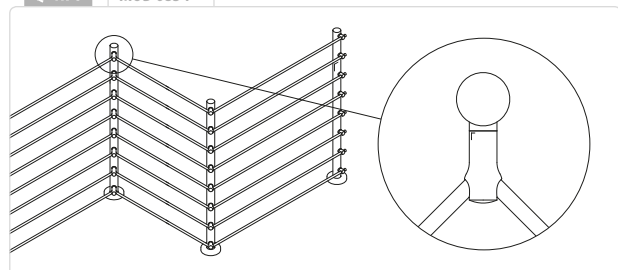



MINDER ONDERDELEN, MEER KABEL.

Insteken, strakspannen, klaar!

Razendsnelle montage want de kabel klemt
zichzelf vast. Nooit meer draad tappen!

En een perfect ogend resultaat.

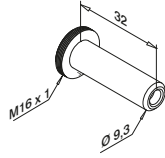

MOD 7240

316	
OUTDOOR	
14.7240.003.12	2

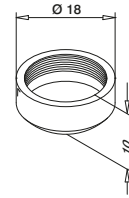

MOD 5010

316	
OUTDOOR	
14.5010.000.12	8

Complete set

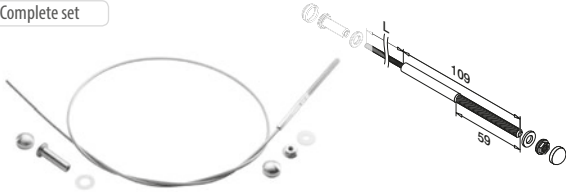

Ø 3,2 mm = (1 x 19)

MOD 7901

316		
OUTDOOR	Ø	
14.7901.013.12	3,2	L = 1 m
14.7901.023.12	3,2	L = 2,5 m
14.7901.053.12	3,2	L = 5 m
14.7901.073.12	3,2	L = 7,5 m
14.7901.103.12	3,2	L = 10 m
14.7901.123.12	3,2	L = 12,5 m
14.7901.153.12	3,2	L = 15 m
14.7901.173.12	3,2	L = 17,5 m
14.7901.203.12	3,2	L = 20 m

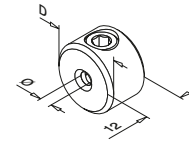

MOD 7400

304			
INDOOR	Ø	D	
13.7400.003.12	3,5	18	6
13.7400.006.12	6,5	20	6
316			
OUTDOOR	Ø	D	
14.7400.003.12	3,5	18	6
14.7400.006.12	6,5	20	6



Fast Fix ontkoppelingsgereedschap

MOD 7802

316	
OUTDOOR	
14.7802.003.00	1

Q-INFO

Spanvolgorde kabels

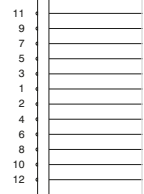

Q-INFO

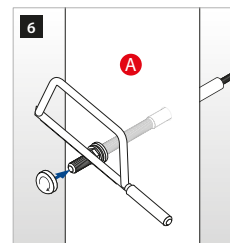
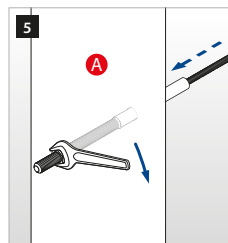
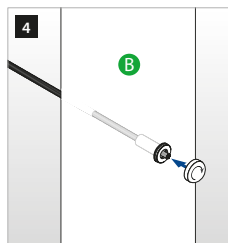
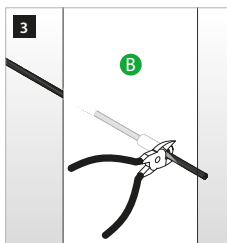
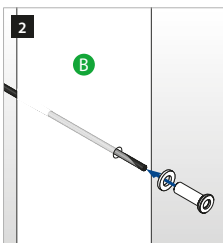
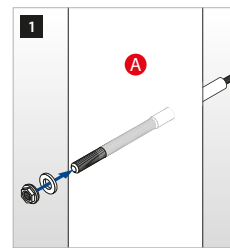
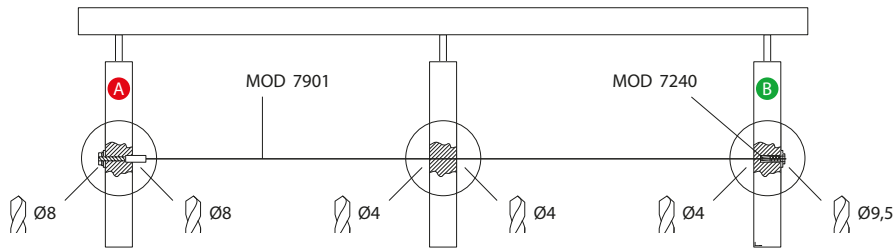

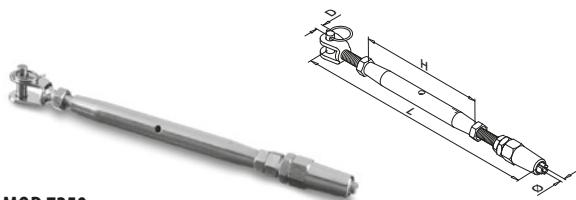

MOD 7250

304					
INDOOR	Ø	D	H	L	
13.7250.003.12	3,2	6	90	155 - 230	2
13.7250.006.12	6,0	9	125	235 - 325	2
316					
OUTDOOR	Ø	D	H	L	
14.7250.003.12	3,2	6	90	155 - 230	2
14.7250.006.12	6,0	9	125	235 - 325	2

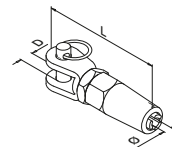

MOD 7300

304				
INDOOR	Ø	D	L	
13.7300.003.12	3,2	6	50	2
13.7300.006.12	6,0	9	97	2
316				
OUTDOOR	Ø	D	L	
14.7300.003.12	3,2	6	50	2
14.7300.006.12	6,0	9	97	2

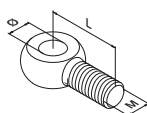

MOD 7350

304				
INDOOR	M	Ø	L	
13.7350.003.12	M6	6	19	10
13.7350.006.12	M10	9,5	30	10
316				
OUTDOOR	M	Ø	L	
14.7350.003.12	M6	6	19	10
14.7350.006.12	M10	9,5	30	10

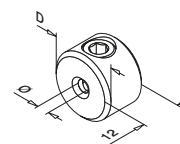

MOD 7400

304			
INDOOR	Ø	D	
13.7400.003.12	3,5	18	6
13.7400.006.12	6,5	20	6
316			
OUTDOOR	Ø	D	
14.7400.003.12	3,5	18	6
14.7400.006.12	6,5	20	6



Ø 6,0 mm = (7 x 19) Ø 3,2 mm = (1 x 19)

MOD 7900

304		
INDOOR	Ø	
13.7900.003.12	3,2	L = 10 m
13.7900.053.12	3,2	L = 50 m
13.7900.103.12	3,2	L = 100 m
13.7900.006.12	6,0	L = 10 m
13.7900.056.12	6,0	L = 50 m
13.7900.106.12	6,0	L = 100 m
316		
OUTDOOR	Ø	
14.7900.003.12	3,2	L = 10 m
14.7900.053.12	3,2	L = 50 m
14.7900.103.12	3,2	L = 100 m
14.7900.006.12	6,0	L = 10 m
14.7900.056.12	6,0	L = 50 m
14.7900.106.12	6,0	L = 100 m



Kabel kniptang

MOD 7800

304		
	Ø	
14.7800.000.00	1,5 + 3,2	1

Q-INFO



Q-23
Q-cleaner
300 ml
19.0601.000.00

Q-INFO



Q-22
Q-ultra-clean
500 ml
19.0610.000.00

Q-INFO

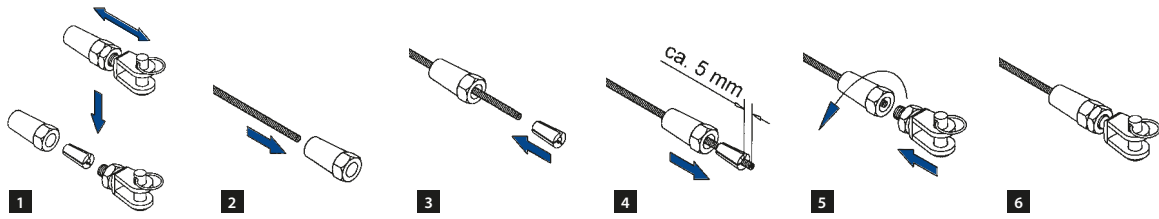

Q-INFO

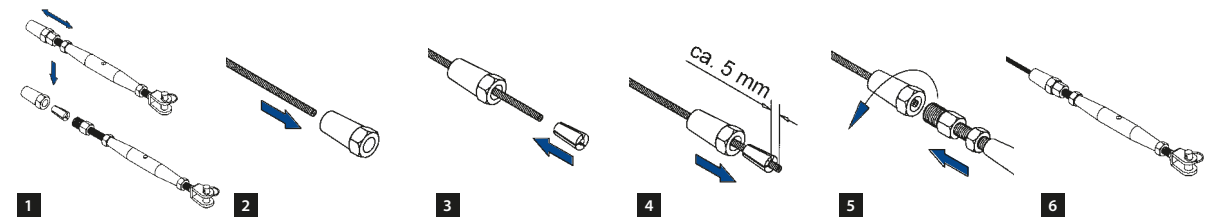

Q-INFO

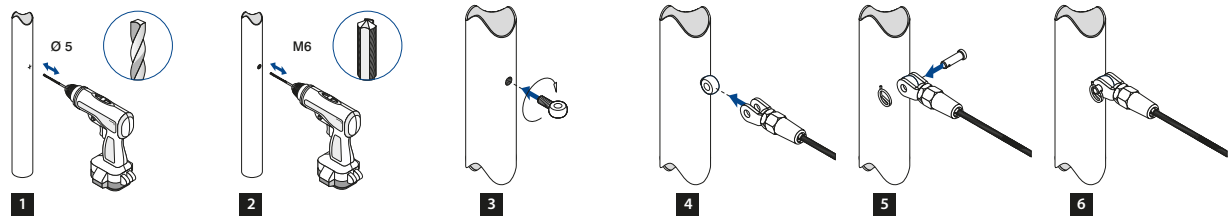

Q-INFO

Max. 10 m per spanschroef

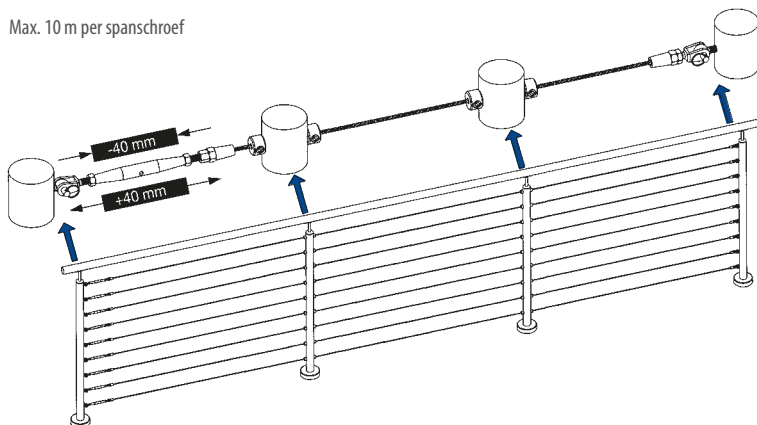

Vlak - kabel

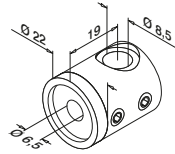

Links

MOD 7452

304		
INDOOR		
13.7452.000.12	QS-15 349	4
316		
OUTDOOR		
14.7452.000.12	QS-16 349	4



Vlak - kabel

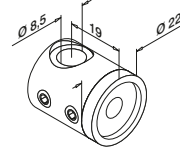

Rechts

MOD 7453

304		
INDOOR		
13.7453.000.12	QS-15 349	4
316		
OUTDOOR		
14.7453.000.12	QS-16 349	4



Vlak - kabel

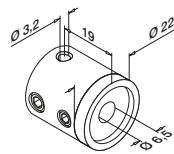

Midden

MOD 7450

304		
INDOOR		
13.7450.000.12	QS-15 349	4
316		
OUTDOOR		
14.7450.000.12	QS-16 349	4

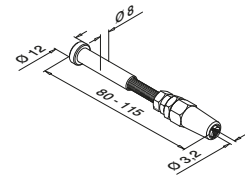

MOD 7500

304	
INDOOR	
13.7500.003.12	4
316	
OUTDOOR	
14.7500.003.12	4



Q-INFO

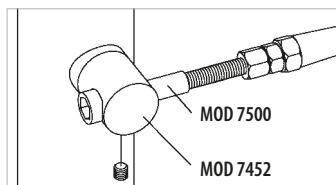
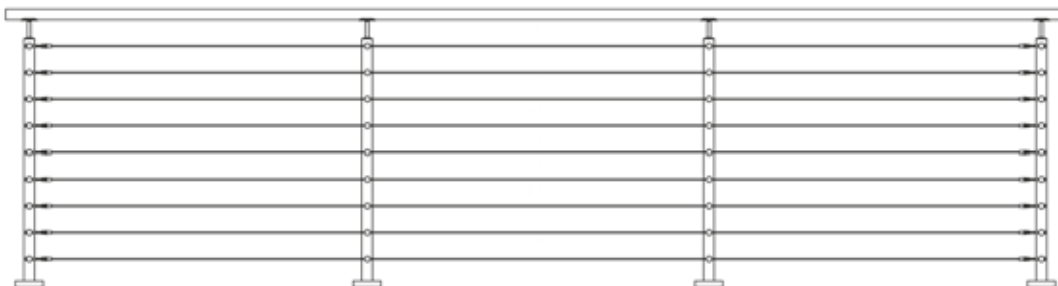

Links

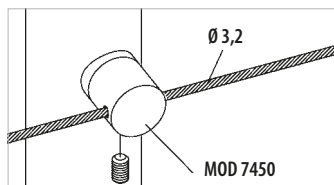

Midden

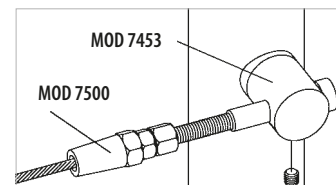

Rechts

Buis - kabel

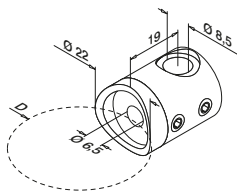

Links

MOD 7452

304

INDOOR	D		
13.7452.042.12	Ø 42,4	QS-15 349	4
13.7452.048.12	Ø 48,3	QS-15 349	4

316

OUTDOOR	D		
14.7452.042.12	Ø 42,4	QS-16 349	4



Buis - kabel

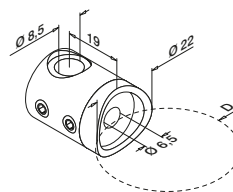

Rechts

MOD 7453

304

INDOOR	D		
13.7453.042.12	Ø 42,4	QS-15 349	4
13.7453.048.12	Ø 48,3	QS-15 349	4

316

OUTDOOR	D		
14.7453.042.12	Ø 42,4	QS-16 349	4



Buis - kabel

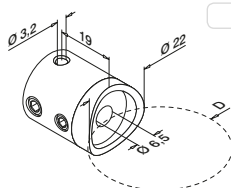

Midden

MOD 7450

304

INDOOR	D		
13.7450.042.12	Ø 42,4	QS-15 349	4
13.7450.048.12	Ø 48,3	QS-15 349	4

316

OUTDOOR	D		
14.7450.042.12	Ø 42,4	QS-16 349	4



Q-INFO



Q-23

Q-cleaner
300 ml
19.0601.000.00

Q-INFO



Q-22

Q-ultra-clean
500 ml
19.0610.000.00



**DE DESIGNBEVESTIGING
VOOR EASY Q-WEB®.**



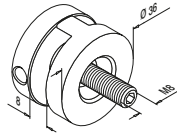
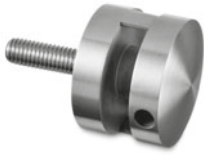

MOD 7356

316

OUTDOOR

14.7356.000.12	2
----------------	---

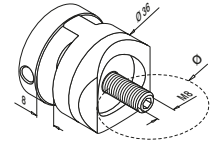

MOD 7356

316

OUTDOOR

14.7356.042.12	Ø	42,4	2
14.7356.048.12	Ø	48,3	2

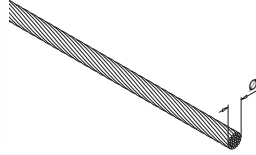

Ø 6,0 mm = (7 x 19)

MOD 7900

316

OUTDOOR

14.7900.006.12	Ø	6	L = 10 m
14.7900.056.12	Ø	6	L = 50 m
14.7900.106.12	Ø	6	L = 100 m

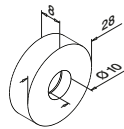

MOD 7723

316

OUTDOOR

14.7723.000.12	12
----------------	----



MOD 0712

19.0712.300.00	Q	L	Ø
	Q-50	300 mm	100

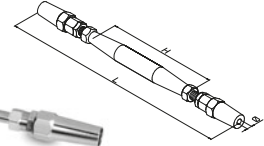

MOD 7260

316

OUTDOOR

14.7260.006.12	Ø	6	H	125	L	340-360	Ø	2
----------------	---	---	---	-----	---	---------	---	---

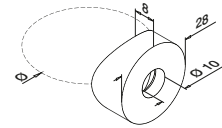

MOD 7723

316

OUTDOOR

14.7723.042.12	Ø	42,4	12
14.7723.048.12	Ø	48,3	12

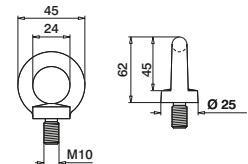

MOD 7355

316

OUTDOOR

14.7355.010.12	12
----------------	----

Q-INFO MOD 7900

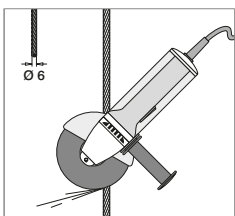

Q-INFO MOD 7356

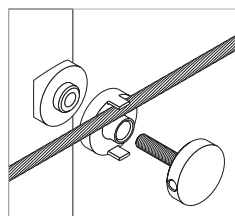

Q-INFO



Q-22
Q-ultra-clean
500 ml
19.0610.000.00

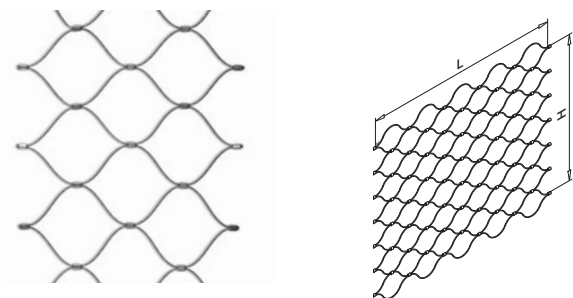

MOD 7906

316		
OUTDOOR	H	
14.7906.051.12	600	5 m
14.7906.101.12	600	10 m
14.7906.501.12	600	50 m

MOD 7908

316		
OUTDOOR	H	
14.7908.051.12	800	5 m
14.7908.101.12	800	10 m
14.7908.501.12	800	50 m



Ø 1,5 mm =  (7 x 7)

MOD 7900

316		
OUTDOOR	Ø	
14.7900.001.12	1,5	L = 10 m
14.7900.051.12	1,5	L = 50 m
14.7900.101.12	1,5	L = 100 m



Kabel kniptang

MOD 7800

316		
OUTDOOR	Ø	
14.7800.000.00	1,5 + 3,2	1



MOD 7810

316		
OUTDOOR		
14.7810.001.12	12	



MOD 7820

316		
OUTDOOR		
14.7820.001.12	12	



MOD 7830

316		
OUTDOOR		
14.7830.001.12	12	

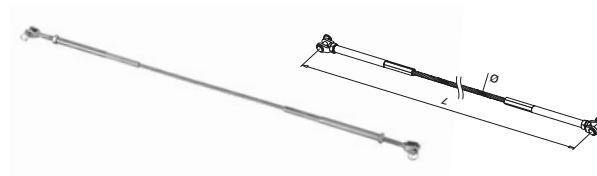

MOD 7780

316			
OUTDOOR	Ø	L	
14.7780.008.12	8	800 mm	1

Q-INFO

MOD 7260 / 7810 / 7820

Benodigde hoeveelheid

MOD 7260		1x per 10 meter
MOD 7810		20 stuks per meter (10x boven en 10x beneden)
MOD 7820	H = 600 mm	10 stuks voor elke zijde (links en rechts)
	H = 800 mm	13 stuks voor elke zijde (links en rechts)

Q-INFO



Q-22

Q-ultra-clean
500 ml
19.0610.000.00

Q-INFO

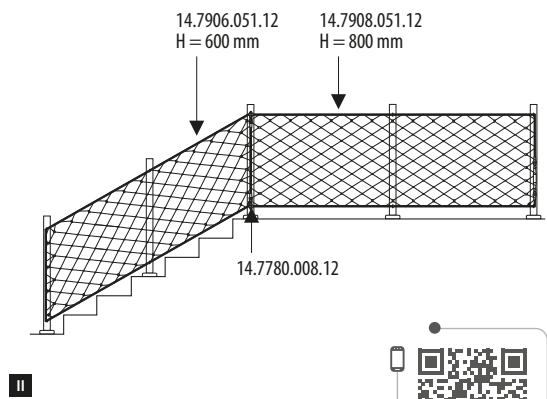
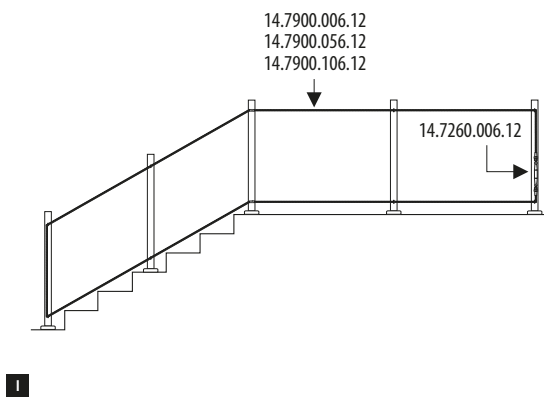
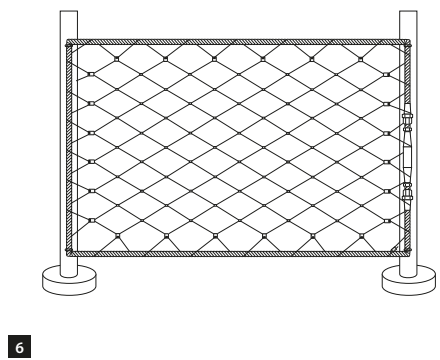
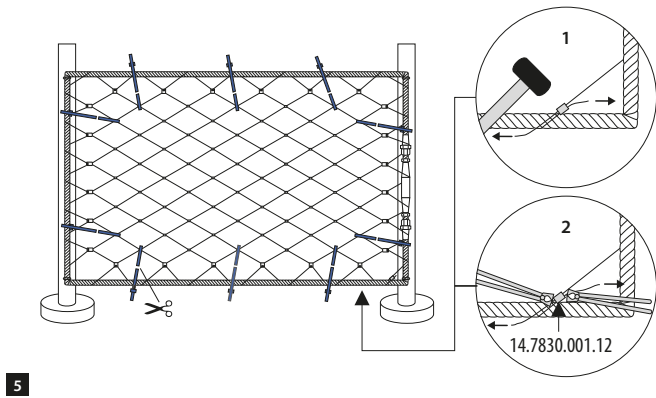
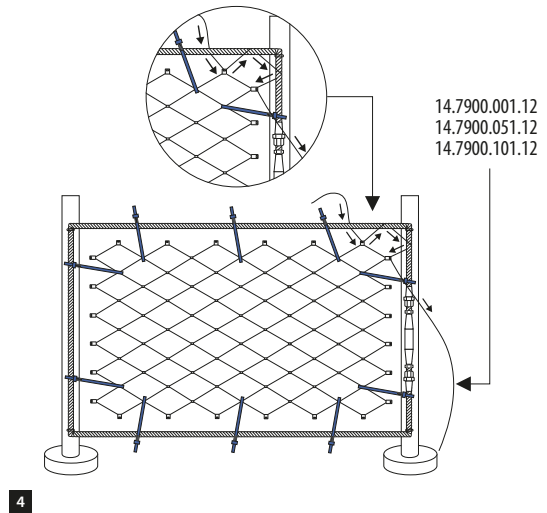
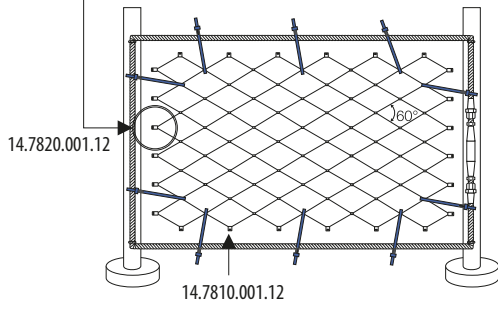
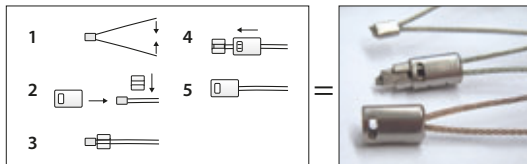
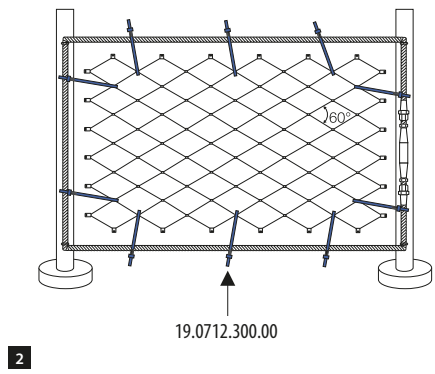
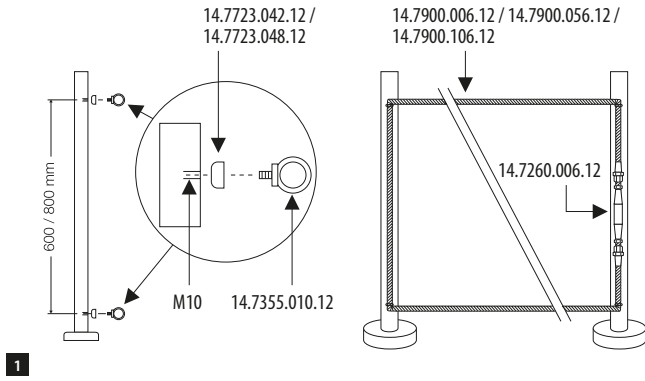



**Q-RAILING'S GLASFRAMEBUIS:
DE SLIMSTE MANIER OM SNEL
GLAS TE MONTEREN.**

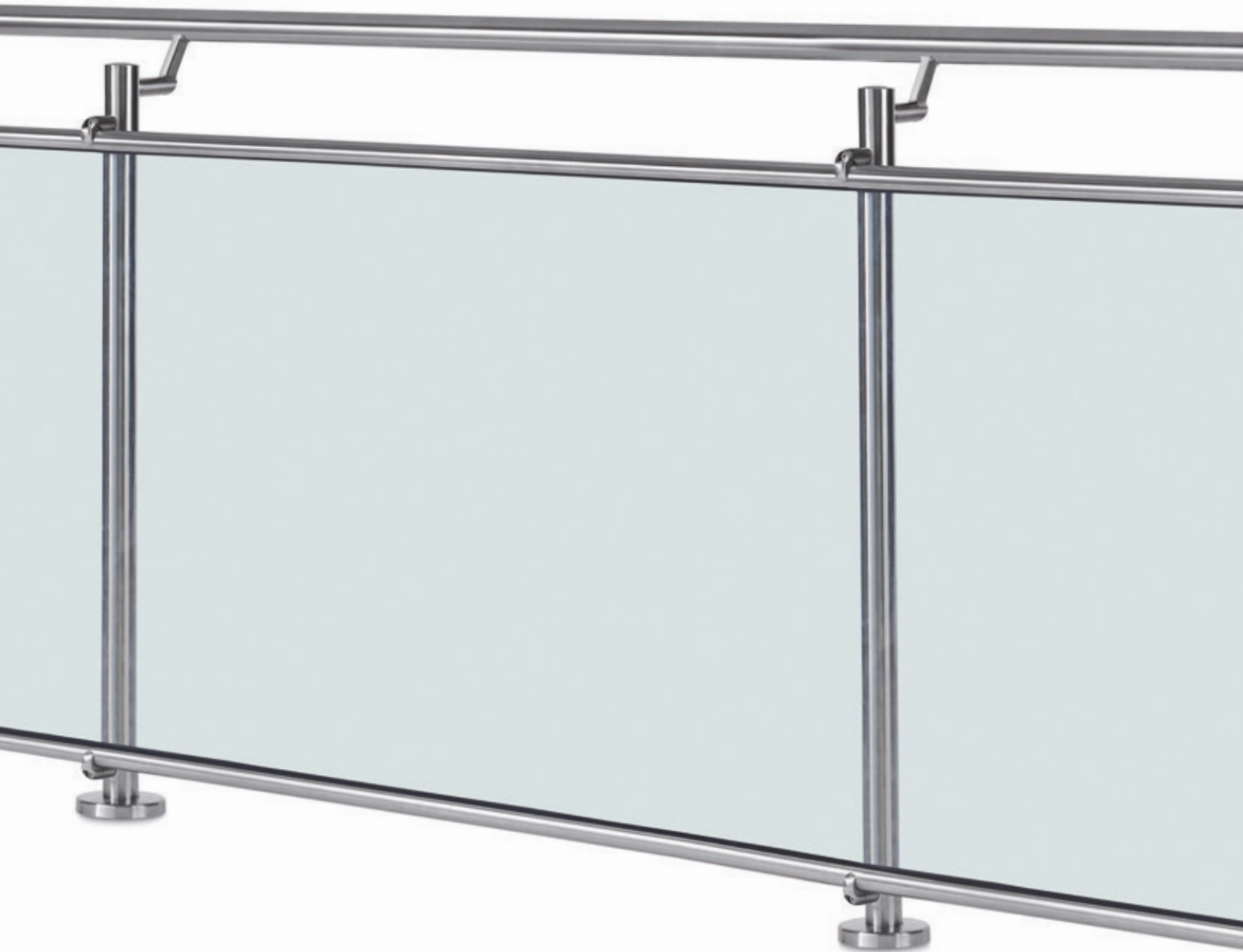

Q-LINE - Glasframebuis

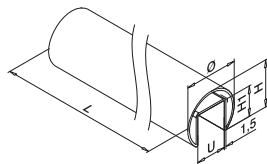

MOD 6920 / 6925 - Ø 30 mm

304					
INDOOR	Ø	U	H	H1	
13.6925.030.12	30	14	27	18	L = 2500 mm
13.6920.030.12	30	14	27	18	L = 5000 mm
316					
OUTDOOR	Ø	U	H	H1	
14.6925.030.12	30	14	27	18	L = 2500 mm
14.6920.030.12	30	14	27	18	L = 5000 mm

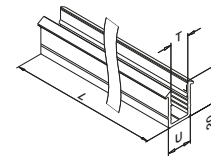

MOD 50 - Ø 30 mm

	U	T	
19.5030.008.00	14	8 + 8,76	L = 5000 mm
19.5030.010.00	14	10 + 10,76	L = 5000 mm

Q-LINE - Glasframebuis - Steunen

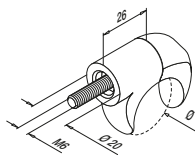

MOD 0860

304		
INDOOR	Ø	
13.0860.000.12	30	2
316		
OUTDOOR	Ø	
14.0860.000.12	30	2



International Design Model Protection

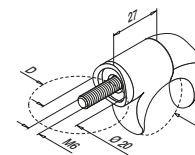

MOD 0860

304			
INDOOR	D	Ø	
13.0860.042.12	42,4	30	2
13.0860.048.12	48,3	30	2
316			
OUTDOOR	D	Ø	
14.0860.042.12	42,4	30	2
14.0860.048.12	48,3	30	2



International Design Model Protection

Q-INFO

MOD 0860

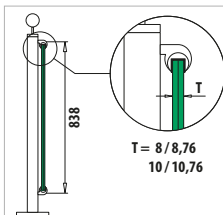

Q-INFO



Q-23
Q-cleaner
300 ml
19.0601.000.00

Q-INFO

MOD 6920 / 6925

Berekeningsbasis voor U-profielbuizen

calculated by

	Ø (mm)	A (cm ²)	I _x (cm ⁴)	I _y (cm ⁴)	W _x (cm ³)	W _y (cm ³)	M (kg / m)	R _{p0,2} (kN / cm ²)	R _m (kN / cm ²)
13.692x.030.12	30	1,82	1,08	1,66	0,78	1,11	1,46	23	54
14.692x.030.12	30	1,82	1,08	1,66	0,78	1,11	1,46	24	53

A = oppervlakte dwarsdoorsnede
I_x / I_y = oppervlaktetraagheidsmoment
W_x / W_y = weerstandsmoment
M = massa
R_{p0,2} = toelaatbare spanning
R_m = minimale trekvastheid

Q-INFO

MOD 0860

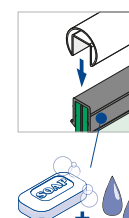
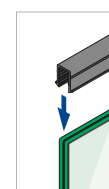
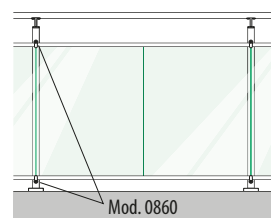

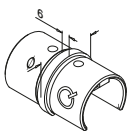

MOD 6790

304			
INDOOR	∅		
13.6790.030.12	30 x 1,5		2
316			
OUTDOOR	∅		
14.6790.030.12	30 x 1,5		2

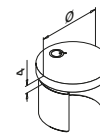

MOD 6732

304			
INDOOR	∅		
13.6732.030.12	30 x 1,5		2
316			
OUTDOOR	∅		
14.6732.030.12	30 x 1,5		2



Omlaag
25-55°

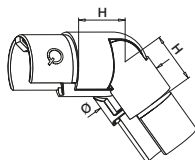

MOD 6302

304			
INDOOR	∅	H	
13.6302.030.12	30 x 1,5	25	2
316			
OUTDOOR	∅	H	
14.6302.030.12	30 x 1,5	25	2



Omhoog
25-55°

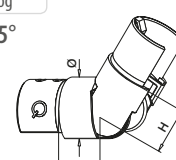

MOD 6312

304			
INDOOR	∅	H	
13.6312.030.12	30 x 1,5	25	2
316			
OUTDOOR	∅	H	
14.6312.030.12	30 x 1,5	25	2



90°

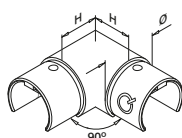

MOD 6313

304			
INDOOR	∅	H	
13.6313.030.12	30 x 1,5	25	2
316			
OUTDOOR	∅	H	
14.6313.030.12	30 x 1,5	25	2



Q-INFO



Q-21
Q-glu
50 ml
19.1331.000.00



Verbruik per verbinding ca. 1 ml

Q-Video www.q-railing.com

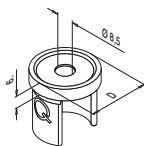

MOD 6728

304

INDOOR	D		
13.6728.000.12	30 x 1,5	QS-19 349	2

316

OUTDOOR	D		
14.6728.000.12	30 x 1,5	QS-20 349	2

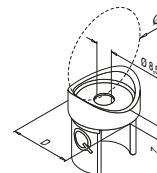

MOD 6728

304

INDOOR	D	Ø		
13.6728.042.12	30 x 1,5	42,4 x 1,5	QS-19 349	2

316

OUTDOOR	D	Ø		
14.6728.042.12	30 x 1,5	42,4 x 1,5	QS-20 349	2



Q-INFO

MOD 6728

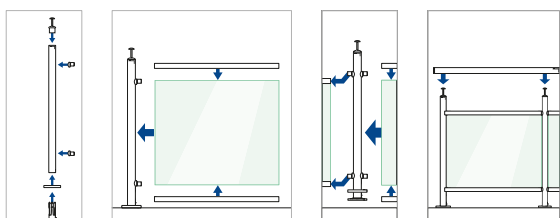

Q-INFO



Q-23
Q-cleaner
300 ml
19.0601.000.00

Q-INFO



Q-22
Q-ultra-clean
500 ml
19.0610.000.00

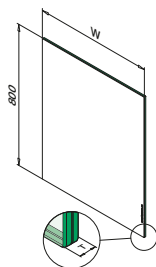

MOD 08 - VSG (ESG)* H=800 mm

Glas

OUTDOOR	W (mm)	T
50.0801.042.00	100	8,76 (4 - 0,76 - 4)
50.0802.042.00	200	8,76 (4 - 0,76 - 4)
50.0803.042.00	300	8,76 (4 - 0,76 - 4)
50.0804.042.00	400	8,76 (4 - 0,76 - 4)
50.0805.042.00	500	8,76 (4 - 0,76 - 4)
50.0806.042.00	600	8,76 (4 - 0,76 - 4)
50.0807.042.00	700	8,76 (4 - 0,76 - 4)
50.0808.042.00	800	8,76 (4 - 0,76 - 4)
50.0809.042.00	900	8,76 (4 - 0,76 - 4)
50.0809.542.00	950	8,76 (4 - 0,76 - 4)
50.0810.042.00	1000	8,76 (4 - 0,76 - 4)
50.0815.042.00	1500	8,76 (4 - 0,76 - 4)



* VSG (2x ESG): Gelaagd gehard glas

Q-INFO

Berekening

$$H (m) \times W (m) \times 2,5 \times T_g (mm) = kg$$

Voorbeeld

H	W	T
1,1 m	1,0 m	16 mm
$1,1 \times 1,0 \times 2,5 \times 16 = 44,00 \text{ kg}$		

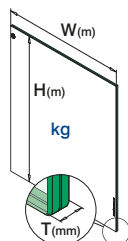

Q-INFO

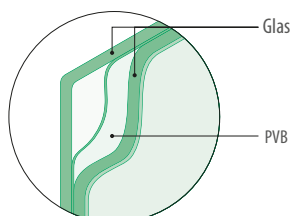
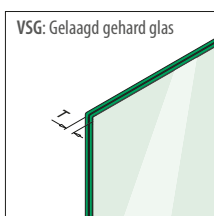

- Geslepen
- Facetrand
- Gepolijst
- Afgeronde hoeken

Vlak - plaat

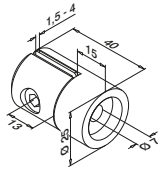

MOD 0743

304

INDOOR		
13.0743.000.12	QS-17 349	4

316

OUTDOOR		
14.0743.000.12	QS-18 349	4



Buis - plaat

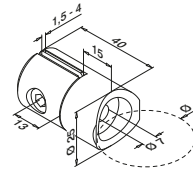

MOD 0743

304

INDOOR			
13.0743.033.12	∅ 33,7	QS-17 349	4
13.0743.042.12	42,4	QS-17 349	4
13.0743.048.12	48,3	QS-17 349	4

316

OUTDOOR			
14.0743.042.12	42,4	QS-18 349	4
14.0743.048.12	48,3	QS-18 349	4



Q-INFO

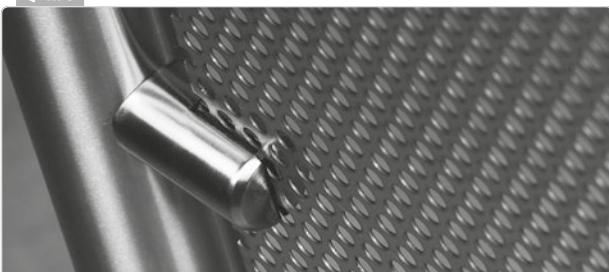

Q-INFO



Q-23
Q-cleaner
300 ml
19.0601.000.00

Q-INFO



Q-22
Q-ultra-clean
500 ml
19.0610.000.00

Vullingen
GESLEPEN /
GEPOLIJS

Q-LINE - Plaatbevestigingsadapters

Vlak - plaat

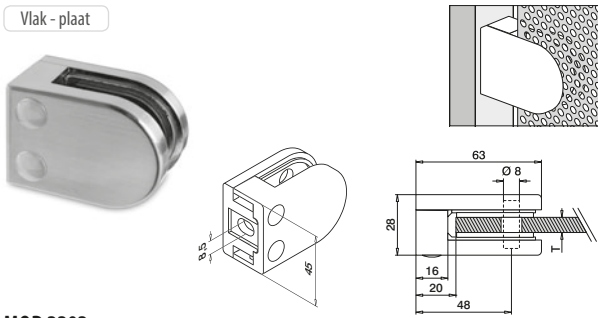

MOD 2202

304				
INDOOR	T			
13.2202.000...	2	QS-47	347	4

316				
OUTDOOR	T			
14.2202.000...	2	QS-45	347	4

MOD 2203

304				
INDOOR	T			
13.2203.000...	3	QS-47	347	4

316				
OUTDOOR	T			
14.2203.000...	3	QS-45	347	4

MOD 2204

304				
INDOOR	T			
13.2204.000...	4	QS-47	347	4

316				
OUTDOOR	T			
14.2204.000...	4	QS-45	347	4



Buis - plaat

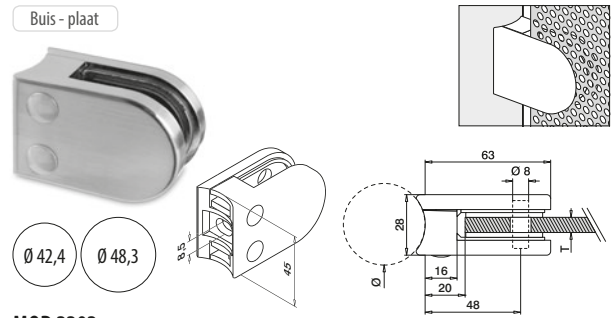

MOD 2202

304				
INDOOR	Ø	T		
13.2202.042...	42,4	2	QS-47	347
13.2202.048...	48,3	2	QS-47	347

316				
OUTDOOR	Ø	T		
14.2202.042...	42,4	2	QS-45	347
14.2202.048...	48,3	2	QS-45	347

MOD 2203

304				
INDOOR	Ø	T		
13.2203.042...	42,4	3	QS-47	347
13.2203.048...	48,3	3	QS-47	347

316				
OUTDOOR	Ø	T		
14.2203.042...	42,4	3	QS-45	347
14.2203.048...	48,3	3	QS-45	347

MOD 2204

304				
INDOOR	Ø	T		
13.2204.042...	42,4	4	QS-47	347
13.2204.048...	48,3	4	QS-47	347

316				
OUTDOOR	Ø	T		
14.2204.042...	42,4	4	QS-45	347
14.2204.048...	48,3	4	QS-45	347



Vlak + buis

Q-INFO

304

MOD 220x Afwerkingen

Gepolijst

Geslepen



13.22.....10

13.22.....12

Vlak + buis

Q-INFO

316

MOD 220x Afwerkingen

Gepolijst

Geslepen



14.22.....10

14.22.....12

Q-LINE - Plaatbevestigingsadapters

Vlak - plaat

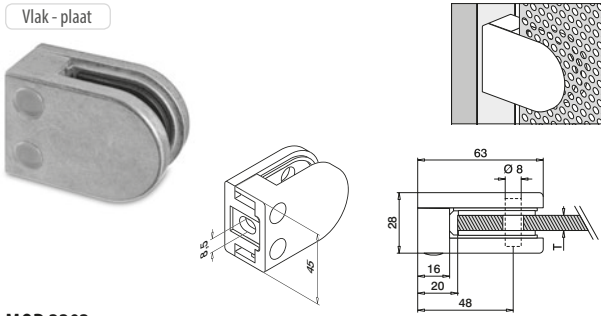

MOD 2202

Zamak				
INDOOR	T			
10.2202.000...	2	QS-47	347	4

MOD 2203

Zamak				
INDOOR	T			
10.2203.000...	3	QS-47	347	4

MOD 2204

Zamak				
INDOOR	T			
10.2204.000...	4	QS-47	347	4



Buis - plaat

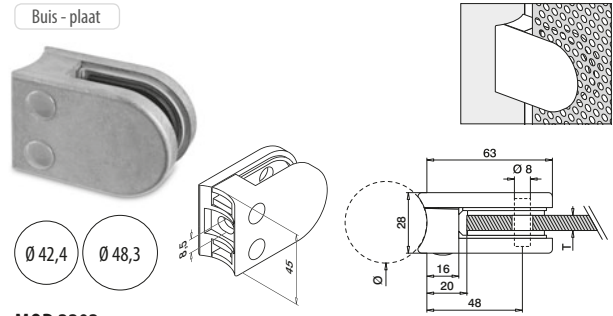

MOD 2202

Zamak				
INDOOR	Ø	T		
10.2202.042...	42,4	2	QS-47	347
10.2202.048...	48,3	2	QS-47	347

MOD 2203

Zamak				
INDOOR	Ø	T		
10.2203.042...	42,4	3	QS-47	347
10.2203.048...	48,3	3	QS-47	347

MOD 2204

Zamak				
INDOOR	Ø	T		
10.2204.042...	42,4	4	QS-47	347
10.2204.048...	48,3	4	QS-47	347



Toebehoren

Rubbers voor plaatbevestigingsadapters



Rubbers voor plaatbevestigingsadapters
(2 stuks per adapter)

MOD 50

	Voor MOD	T	
19.5004.002.00	2202	2	8
19.5004.003.00	2203	3	8
19.5004.004.00	2204	4	8

Borgpennen voor
plaatbevestigingsadapters



MOD 5015

	Voor MOD	L	
19.5015.022.00	2202, 2203, 2204	22	4

Vlak + buis

Q-INFO **Zamak** MOD 220x Afwerkingen

Onbewerkt	Mat verchromd	Verchromd	RVS look
10.22.....00	10.22.....16	10.22.....17	10.22.....19

Borgpennen en bevestigingsmateriaal dienen apart te worden besteld.

Q-INFO MOD 5015